

Attachment A: Small Group Discussion Notes

The following is an unedited, direct transcription of the group notes that were taken during this session.

Group A

What are your impressions of the "Silver Saddle Ranch and the Carson River" area?

- Awesome-undisturbed, easy to reach, undeveloped/limited development
- Level 4 birdwatching—increasing to Level 5
- Only river in Carson City (unique)
- Historic landscape
- Historic cultural resources
- Contiguous
- Viewshed high
- Maintain undeveloped floodplain
- Education/outdoor classroom
- Rafting friendly (safety, portage around Mexican Dam)
- Horse activities
- Trails-trailhead/paths designated

How do you see this area relating to the rest of Carson City (physically, how it functions for the community, how it relates to the broader environment, etc.)?

- Quiet, small activities (individual/small group)
- Protect natural resources/wildlife corridor/river
- Environmental education-watershed
- Release area for community
- Undisturbed
- Quality of life—access to river, wildlife habitat
- Unique-appreciate passive recreation
- Contains city water resources
- Watershed function: basis of (Carson River, drainages, floodplains)
- Economic positive
- Escape from developed area (quick access)

What are some important things that should be considered for planning and design of this area (i.e. issues, concerns, opportunities) and why?

- Designated wildlife protection areas and riparian protection area
- Signage—river dangers, environmental education, environmental safety (snakes)
- No large events
- No commercial activities
- Noise/air quality concerns (ATV/VT)
- No new land disturbance (ex. Parking)

What would you like to see there in the future? Are there any ideas or projects you have seen successfully implemented in other locations that you feel would work here? Please give details and tell why they would work here.

- SSR—keep closed in evening
- Nothing new-status quo
- Master plan—environmental protection

- School programs-PA
- Interpretative river rafting trips (historic, bioengineering on river, etc.)
- No commercial activities
- Wildlife, natural vegetation
- Working ranch
- Environmental center to support one classroom
- No OHV extension use
- Horses on east side of river

Group B

What are your impressions of the "Silver Saddle Ranch and the Carson River" area?

- Concerns about OHV (enforcement for existing)
- Asking areas near residential not have OHV
- Better/safer trails in south near Mexican Dam
- Prohibition of any motorized vehicle in river during low period
- Hunting/trapping/trail conflicts

How do you see this area relating to the rest of Carson City (physically, how it functions for the community, how it relates to the broader environment, etc.)?

- Area too much to deal with:
 - Ranch: Strongly don't want organized events (no rendezvous, rodeo, cars, etc.)
 - Want it to stay as is

What are some important things that should be considered for planning and design of this area (i.e. issues, concerns, opportunities) and why?

- Where do you allow OHV
- Environmentally sensitive development (trails, etc.)
- Dumping of junk in area
- Designate trails for individual users—i.e. bikes, horses, foot trail along river
- If trail across Empire Ranch, old barbed wire
- Concerns about look of new pump station
- Allowing dogs in all areas

What would you like to see there in the future? Are there any ideas or projects you have seen successfully implemented in other locations that you feel would work here? Please give details and tell why they would work here.

- Continue people oriented-walking, health, smaller events
- Healthy function system
- Mixed use/management habitat important
- Access for horses (especially after freeway)
- Tahoe—separate and marked trails as example
- Successful, sustainable agricultural operation

Group C

What are your impressions of the "Silver Saddle Ranch and the Carson River" area?

- Too much of Nevada "eaten up"
- Like the views—don't want destroyed
- What's the "Say No" perspective?
- Ownership stay public, how do we pay for development of parks/facilities?
- Keep Silver Saddle Ranch as open diverse open area

How do you see this area relating to the rest of Carson City (physically, how it functions for the community, how it relates to the broader environment, etc.)?

- Well integrated while keeping as wild as possible with good river access
- Develop so that seniors accessible/free
- Share the river with groups alienated from nature (youth education, rehabilitation)
- Appreciate accessibility for all, handicap too
- Balance development to respect wildlife with recreation
 - Keep it wild and undeveloped with wild horses and coyotes
- Improve hiking signage with mileage information
- Natural re with variety: hiking, flat areas, canoe, strenuous hills...
- Diversity of habitat
- Nature centers contiguous to urban areas and field trips
- Great Carson City field trip potential
- Attractive for visitors/quality of life
- One of four rivers, we must protect it
- Keep area natural and healthy
- Weed free
- Area for passive recreation
- Monitor for uses—OHV, parties, etc. via neighborhood watch.
- It takes all users to maintain. Focus on education for users.

What are some important things that should be considered for planning and design of this area (i.e. issues, concerns, opportunities) and why?

- Maintenance
- On-site supervision/ranger
- Gate after dark
- Maintain dirt roads
- Restricted access
- Increase partners=improved funding opportunities
- Endowment to help protect in perpetuity
- Protection as a nature area in perpetuity

What would you like to see there in the future? Are there any ideas or projects you have seen successfully implemented in other locations that you feel would work here? Please give details and tell why they would work here.

- Low impact river use with inner tubes, canoes, hang-out
- Some trails with wheelchair access
- Modest nature center near SSR buildings
- River rehabilitation (willows, cottonwoods, etc.)
- FEYA on American River—on County Land nice example
- White Pine County cross country area

- Fund a marketing plan for community education
- Cultivate community by sharing the special values of Silver Saddle Ranch
- Re-engage neighbors—beautiful flyer
- Broaden advertisement scope/radio
- Involve kids at school/Rotary, Kiwanis
- Example: Rogue River, Grants Pass, OR

Group D

What are your impressions of the “Silver Saddle Ranch and the Carson River” area?

- Fabulous—why we live there
- Open spaces—why we use it
- Scenic
- Open country but near town
- Hidden, protected
- Ability to conduct equestrian business
- Concerned about lack of access—knowing what is private and what is public...what is public? High water mark vs. private? where can you access the river? Need clarification.
- Wildlife and variety of uses/creation
- Large and diverse enough areas for many uses/different forms of recreation

How do you see this area relating to the rest of Carson City (physically, how it functions for the community, how it relates to the broader environment, etc.)?

- Close to City for people to go to
- It's own world. We want to keep it the way it is.
- Concern-developed regional park concept—amphitheater, etc.
- Good example is Bartley Ranch (hybrid)
- Spreading uses out will be beneficial (Riverview Park is having a lot of use, especially in mornings and after work hours)
- Agree with Carson River Park Plan—not overbuild it
- Important to keep irrigation at Silver Saddle Ranch

What are some important things that should be considered for planning and design of this area (i.e. issues, concerns, opportunities) and why?

- Connecting trail/loop trails. Some single tracks
- Keep OHV access at south Prison Hill area. But need better clarification/signage
- Can utility bridge be covered with rubber matting [for equestrian use]
- Silver Saddle Ranch---want long term irrigation arrangements

What would you like to see there in the future? Are there any ideas or projects you have seen successfully implemented in other locations that you feel would work here? Please give details and tell why they would work here.

Group E

What are your impressions of the “Silver Saddle Ranch and the Carson River” area?

- Area of open space/recreation “in town”—options of flat/hilly, all ages
- Asset to community with access
- Important environmental area—e.g. floodplain

- Wildlife generator, “green” areas
- Dark sky (star watching)
- Could be development pressure
- Concern with safety—e.g. drug use, homeless
- Fire protect—concern on maintenance funding

How do you see this area relating to the rest of Carson City (physically, how it functions for the community, how it relates to the broader environment, etc.)?

- Psychological “safety valve”
- Positive asset—image, pride
- Potential economic asset (quality of life)
- Educational asset
- History: ranches, Washoe history, river

What are some important things that should be considered for planning and design of this area (i.e. issues, concerns, opportunities) and why?

- Segregate some uses: e.g. motorized/nonmotorized
- Define limits between use better
- More defined trails and variety
- Preservation and interpretation of historic resources
- Interpretive center
- Natural environment
- Keep trails natural (but accessible)
- Maintain agricultural and riparian lands

What would you like to see there in the future? Are there any ideas or projects you have seen successfully implemented in other locations that you feel would work here? Please give details and tell why they would work here.

- Outreach to educational institutes of resource
- River trails—Colorado and Idaho examples e.g. Crested Butte
- Wildlife observation platforms
- Camping events, limited—e.g. Boy Scouts
- Bring V&T down river corridor—Wagon Road from V&T terminal to Silver Saddle Ranch
- Manage motorized Prison Hill area better; opportunity for education use, beginners—define trails, area better
- Improve mountain bike trails (both sides of Prison Hill)
- River Trails plan implementation
- Improve fishing
- Edmonds Drive side: keep non motorized access:
 - Control access better; e.g. signs
 - More parking (lower for better access)
- Trails to meet demand
- Protect nesting areas

Group F

What are your impressions of the "Silver Saddle Ranch and the Carson River" area?

- Happy with current management, lack of development
- Need more bicycle facilities including commuter
- Good open space connections
- Concerns: use of effluent, light pollution
- Good equestrian facilities
- Potential to expand project to Douglas County line
- Potential for economic and tourist
- Not enough horse trailer at Silver Saddle Ranch
- Safety is a concern

How do you see this area relating to the rest of Carson City (physically, how it functions for the community, how it relates to the broader environment, etc.)?

- Natural resource, especially river
 - Include sustainable river system
 - Recreational opportunities
- Trails

What are some important things that should be considered for planning and design of this area (i.e. issues, concerns, opportunities) and why?

- Limited improvements
- Not every use on every area
- Future thoughts to replace Brunswick Canyon bridge
- First impressions and reasons for protection
- Potential user conflicts

What would you like to see there in the future? Are there any ideas or projects you have seen successfully implemented in other locations that you feel would work here? Please give details and tell why they would work here.

- Moab, UT-recreational examples
- Reno—Bartley Ranch (to some extent)
- Wildlife, including habitat
- American River Park (Sacramento), paved river trail in Boise
- Carson Valley Trails Association—proposal for west side of valley
- Opportunities for hunting?

Comment cards

The following comments were provided on comment cards during the meeting:

	Comment received
1	<ol style="list-style-type: none"> 1. I see a great need to set up a permanent funding source for maintenance 2. This should be a fine source for developing community involvement and pride. 3. Need a very stringent legal set-aside so the area can't ever be developed.
2	<p>One agency (i.e. Carson City) should not own all this land. Carson City should only acquire the private land. However, the Federal land should stay Federal. Have all the land with Carson City would cause too much of burden on the tax payer of Carson City.</p>
3	<ol style="list-style-type: none"> 1. Possible hunting should be considered (maybe even during limited days/weeks/ months) goose/duck/archery hunting, blinds, dove hunting 2. Mountain bike trail should connect from Silver Saddle Ranch to Mexican Dam and safely through the OHV area on the south side of Prison Hill (so trail would be on river's Westside) 3. OHV parking s/b considered at the east end of Sedge Street and minimal use of BLM hillside north of Sedge St. to the Deer Run Rd. bridge S/B/ a management priority (to maintain "wild" view from river)
4	<p>Consider using the area between Edmonds, E. Fifth and Carson River Road at the north end of Prison Hill as a "test" area for OHVs (since that is what it is being used for now).</p>
5	<ol style="list-style-type: none"> 1. Need non-motorized access for as many neighborhoods as possible—non motorized crossing for south Carson. 2. Safety for residents needs priority. 3. Need resource specific trail planning 4. Have concerns about application of effluent to fields—toxins in forage 5. Want dark skies—no night time lighting 6. How bout better looking well houses 7. People enjoy seeing peacocks next to Carson River Rd.
6	<ol style="list-style-type: none"> 1. Wild horses help with fire fuel control 2. Trailer parking needs to be accommodated at Silver Saddle Ranch and Ambrose 3. Don't like idea for V&T—too noisy, wagon trail okay
7	<p>We need a larger buffer between where ATVs and motorized vehicles can go and where residents live esp. on south side of Prison Hill. ATVs go onto private land and are very fast down Eagle Lane all the time.</p>
8	<ol style="list-style-type: none"> 1. Horses allowed only on east side of river—with appropriate pull outs. Access to BLM lands (not in [not legible] recreation area) 2. Keep ranch undisturbed 3. Organized activities/commercial activities forbidden 4. No commercial activities 5. Keep horses in area which do not conflict with hikers or "undisturbed" areas and riparian protection 6. Only small groups/individual use—no large groups 7. Need intensive management and enforcement

9 Carson Disc Golf Course: Carson River Park

- Low impact on environment
- Trash container every 6 holes (6,12,18-concessions)
- Low maintenance
- Fee/rebate
- Parking needed for fire access
- Wood frame tee boxes/rubber mats
- Worldwide association with more than 10,000 courses
- Website in place
- Zephyr Cove closest
- Concessions—disc, soda, minimum wage \$ no increase
- Volunteer committee
- 7000' length/10 acres—work to build all year round/or close Jan-March if muddy
- All ages
- Wildlife enthusiasts-viewing
- Tourism/winter enthusiasts
- State-up/hole sponsorship in beginning form local businesses
- Installation of course, low impact
- Low stat up fee under \$15,000—course only. Low damage if river floods
- Mexican Dam south—64 acres parcel parking could tie in with other access points

All Groups' Comments Combined for Each Question

For each question, all groups' input was consolidated and then sorted into themes to facilitate development of a vision statement and draft goals.

What are your impressions of the "Silver Saddle Ranch and the Carson River" area?

Character

- Awesome-undisturbed, easy to reach, undeveloped/limited development
- Fabulous—why we live there
- Keep Silver Saddle Ranch as open diverse open area
- Open spaces—why we use it
- Open country but near town
- Area of open space/recreation "in town"—options of flat/hilly, all ages
- Hidden, protected
- Too much of Nevada "eaten up"
- Large and diverse enough areas for many uses/different forms of recreation
- Contiguous
- Good open space connections
- Potential to expand project to Douglas County line
- Could be development pressure

Wildlife

- Level 4 birdwatching—increasing to Level 5
- Wildlife generator, "green" areas
- Wildlife and variety of uses/creation

River & floodplain

- Only river in Carson City (unique)
- Maintain undeveloped floodplain
- Important environmental area—e.g. floodplain
- Rafting friendly (safety, portage around Mexican Dam)

Historic/cultural resources

- Historic landscape
- Historic cultural resources

Visual/scenic quality

- Viewshed high
- Like the views—don't want destroyed
- Scenic
- Dark sky (star watching)

Education/interpretation

- Education/outdoor classroom

Equestrian use

- Horse activities
- Good equestrian facilities
- Not enough horse trailer at Silver Saddle Ranch

OHV Use

- Concerns about OHV (enforcement for existing)

- Asking areas near residential not have OHV
- Prohibition of any motorized vehicle in river during low period

Trails & Access

- Trails-trailhead/paths designated
- Asset to community with access
- Better/safer trails in south near Mexican Dam
- Concerned about lack of access—knowing what is private and what is public...what is public? High water mark vs. private? where can you access the river? Need clarification.
- Hunting/trapping/trail conflicts
- Need more bicycle facilities including commuter

Safety

- Concern with safety—e.g. drug use, homeless
- Safety is a concern

Management

- Fire protect—concern on maintenance funding
- Ownership stay public, how do we pay for development of parks/facilities?
- Happy with current management, lack of development
- Concerns: use of effluent, light pollution

Economic impacts

- Ability to conduct equestrian business
- Potential for economic and tourist

How do you see this area relating to the rest of Carson City (physically, how it functions for the community, how it relates to the broader environment, etc.)?

Education/interpretation

- Environmental education-watershed
- Nature centers contiguous to urban areas and field trips
- Great Carson City field trip potential
- Educational asset
- History: ranches, Washoe history, river

Natural resource protection

- Protect natural resources/wildlife corridor/river
- Undisturbed
- Well integrated while keeping as wild as possible with good river access
- Diversity of habitat

Watershed/river protection

- Contains city water resources
- Watershed function: basis of (Carson River, drainages, floodplains)
- One of four rivers, we must protect it
- Natural resource, especially river
 - Include sustainable river system
 - Recreational opportunities

Natural, passive character

- Quiet, small activities (individual/small group)
- Unique-appreciate passive recreation

- Balance development to respect wildlife with recreation
- Keep it wild and undeveloped with wild horses and coyotes
- Keep area natural and healthy
- Natural re with variety: hiking, flat areas, canoe, strenuous hills...
- Area for passive recreation
- Want it to stay as is
- It's own world. We want to keep it the way it is.
- Concern-developed regional park concept—amphitheater, etc.
- Spreading uses out will be beneficial (Riverview Park is having a lot of use, especially in mornings and after work hours)
- Agree with Carson River Park Plan—not overbuild it

Quality of Life/social, psychological benefits

- Quality of life—access to river, wildlife habitat
- Release area for community
- Escape from developed area (quick access)
- Share the river with groups alienated from nature (youth education, rehabilitation)
- Attractive for visitors/quality of life
- Psychological “safety valve”
- Positive asset—image, pride

Trails

- Improve hiking signage with mileage information
- Trails

Accessibility

- Develop so that seniors accessible/free
- Appreciate accessibility for all, handicap too
- Close to City for people to go to

Economic impacts

- Economic positive
- Potential economic asset (quality of life)

Management

- It takes all users to maintain. Focus on education for users.
- Weed free
- Monitor for uses—OHV, parties, etc. via neighborhood watch.
- Ranch: Strongly don't want organized events (no rendezvous, rodeo, cars, etc.)
- Important to keep irrigation at Silver Saddle Ranch

What are some important things that should be considered for planning and design of this area (i.e. issues, concerns, opportunities) and why?

Natural resource protection/management

- Designated wildlife protection areas and riparian protection area
- Noise/air quality concerns (ATV/VT)
- No new land disturbance (ex. Parking)
- Environmentally sensitive development (trails, etc.)
- Protection as a nature area in perpetuity
- Natural environment
- First impressions and reasons for protection

Trails

- Where do you allow OHV
- Designate trails for individual users—i.e. bikes, horses, foot trail along river
- If trail across Empire Ranch, old barbed wire
- Keep OHV access at south Prison Hill area. But need better clarification/signage
- Segregate some uses: e.g. motorized/nonmotorized
- Define limits between use better
- Connecting trail/loop trails. Some single tracks
- More defined trails and variety
- Future thoughts to replace Brunswick Canyon bridge
- Can utility bridge be covered with rubber matting [for equestrian use]
- Potential user conflicts
- Keep trails natural (but accessible)

Management issues

- Signage—river dangers, environmental education, environmental safety (snakes)
- No large events
- No commercial activities
- Allowing dogs in all areas
- Maintenance
- Dumping of junk in area
- On-site supervision/ranger
- Gate after dark
- Maintain dirt roads
- Restricted access
- Silver Saddle Ranch---want long term irrigation arrangements
- Maintain agricultural and riparian lands

Funding/partnerships

- Increase partners=improved funding opportunities
- Endowment to help protect in perpetuity

Development/improvements

- Concerns about look of new pump station
- Limited improvements
- Not every use on every area

Education/interpretation

- Preservation and interpretation of historic resources
- Interpretive center

What would you like to see there in the future? Are there any ideas or projects you have seen successfully implemented in other locations that you feel would work here? Please give details and tell why they would work here.

Keep it mostly the way it is

- Nothing new-status quo

Working ranch/agricultural uses

- Working ranch
- Successful, sustainable agricultural operation

Natural resource protection

- Master plan—environmental protection

- Wildlife, natural vegetation
- Healthy function system
- Mixed use/management habitat important
- River rehabilitation (willows, cottonwoods, etc.)
- Protect nesting areas
- Wildlife, including habitat

Recreation uses

- No OHV extension use
- Horses on east side of river
- Continue people oriented-walking, health, smaller events
- Access for hoses (especially after freeway)
- Low impact river use with inner tubes, canoes, hang-out
- Some trails with wheelchair access
- Wildlife observation platforms
- Camping events, limited—e.g. Boy Scouts
- Manage motorized Prison Hill area better; opportunity for education use, beginners—define trails, area better
- Improve mountain bike trails (both sides of Prison Hill)
- Improve fishing
- River Trails plan implementation
- Edmonds Drive side: keep non motorized access:
 - Control access better; e.g. signs
 - More parking (lower for better access)
- Trails to meet demand
- Carson Valley Trails Association—proposal for west side of valley
- Opportunities for hunting?

Education/interpretation

- School programs-PA
- Environmental center to support one classroom
- Interpretative river rafting trips (historic, bioengineering on river, etc.)
- Modest nature center near SSR buildings
- Fund a marketing plan for community education

Management

- SSR—keep closed in evening
- No commercial activities

Community engagement

- Cultivate community by sharing the special values of Silver Saddle Ranch
- Re-engage neighbors—beautiful flyer
- Broaden advertisement scope/radio
- Involve kids at school/Rotary, Kiwanis
- Outreach to educational institutes of resource

V&T

- Bring V&T down river corridor—Wagon Road from V&T terminal to Silver Saddle Ranch

Specific Examples of Parks/Natural Areas/Trails

- American River Park (Sacramento), paved river trail in Boise
- Moab, UT-recreational examples
- Reno—Bartley Ranch (to some extent)
- River trails—Colorado and Idaho examples e.g. Crested Butte

- Example: Rogue River, Grants Pass, OR
- Tahoe—separate and marked trails as example
- FEYA on American River—on County Land nice example
- White Pine County cross country area
- Good example is Bartley Ranch (hybrid)

Comment cards

- Consider using the area between Edmonds, E. Fifth and Carson River Road at the north end of Prison Hill as a “test” area for OHVs (since that is what it is being used for now).
- Need non-motorized access for as many neighborhoods as possible—non motorized crossing for south Carson.
- Safety for residents needs priority.
- Need resource specific trail planning
- Have concerns about application of effluent to fields—toxins in forage
- Want dark skies—no night time lighting
- How bout better looking well houses
- People enjoy seeing peacocks next to Carson River Rd.
- Wild horses help with fire fuel control
- Trailer parking needs to be accommodated at Silver Saddle Ranch and Ambrose
- Don’t like idea for V&T—too noisy, wagon trail okay
- One agency (i.e. Carson City) should not own all this land. Carson City should only acquire the private land. However, the Federal land should stay Federal. Have all the land with Carson City would cause too much of burden on the tax payer of Carson City.
- I see a great need to set up a permanent funding source for maintenance
- This should be a fine source for developing community involvement and pride.
- Need a very stringent legal set-aside so the area can’t ever be developed. Horses allowed only on east side of river—with appropriate pull outs. Access to BLM lands (not in [not legible] recreation area)
- Keep ranch undisturbed
- Organized activities/commercial activities forbidden
- No commercial activities
- Keep horses in area which do not conflict with hikers or “undisturbed” areas and riparian protection
- Only small groups/individual use—no large groups
- Need intensive management and enforcement
- We need a larger buffer between where ATVs and motorized vehicles can go and where residents live esp. on south side of Prison Hill. ATVs go onto private land and are very fast down Eagle Lane all the time.
- Possible hunting should be considered (maybe even during limited days/weeks/months) goose/duck/archery hunting, blinds, dove hunting
- Mountain bike trail should connect from Silver Saddle Ranch to Mexican Dam and safely through the OHV area on the south side of Prison Hill (so trail would be on river’s Westside)
- OHV parking s/b considered at the east end of Sedge Street and minimal use of BLM hillside north of Sedge St. to the Deer Run Rd. bridge S/B/ a management priority (to maintain “wild” view from river)

Common themes discussion

Following presentations of the breakout groups’ work, participants were asked to reflect on the input from that portion of the workshop:

What were some common themes where there seems to be some general agreement?

- Keep it natural, undeveloped
- Less is more
- Educational opportunities
- Trail access

Are there any areas of potential conflict between what folks want to see?

- Levels of development
- Mix of uses
- Motorized vs. non-motorized
- Impacts of use to property owners (i.e. recreation and landowner interface areas)
- Noise impacts—atrium (also habitat impacts)
- Water activity access points
- Evaluate river

APPENDIX F:

5/08/08 Public Workshop Summary

**CREATING A COMMUNITY VISION:
SILVER SADDLE RANCH AND THE CARSON RIVER AREA**
A Community Design Charrette

Summary: Public Workshop #2

May 8, 2008

6:30-8:30 p.m.

Carson City Senior Citizens Center

The meeting began with an overview of the first public workshop which took place April 24, 2008. The input received was reviewed and a draft vision statement and goals based on that input was presented for comment. The vision and goals were revised during the meeting based on comments to read:

Vision

The Silver Saddle Ranch and Carson River area provides close-to-home, natural, open space that contributes to quality of life for residents and visitors. This historic landscape helps to preserve Carson City's rural heritage while providing a variety of passive recreation and trail uses that are balanced with existing agricultural uses and protection of the Carson River ecosystem and its associated values.

Goals

1. Preserve and enhance the area's scenic natural, undeveloped character.
2. Protect and enhance the Carson River ecosystem, including associated upland areas.
3. Provide for a variety of trail uses, passive recreation opportunities and events that are compatible with preserving the character of the area and protecting natural resources.
4. Enhance access to the Silver Saddle Ranch and Carson River area, including Prison Hill.
5. Preserve the area's cultural heritage and resources.
6. Improve on-site educational and interpretive opportunities.
7. Manage the area for improved safety, resource and private property protection.

Following review of vision and goals, workshop participants were asked to divide into six small groups and discuss the following questions:

- Where would you implement the goals and how?
- Are there areas where more intensive uses/limited development could happen? What criteria would be used to determine those areas?
- Identify potential:
 - Land uses
 - Trails/trailheads/access points
 - Specific projects/programs within those areas
 - What types of characteristics you need for your facilities (i.e. what makes a good trailhead/staging location? We will figure out potential suitable locations and provide an opportunity for you to review)

Input was recorded by each group (*Attachment A: Small Group Discussion Notes; Attachment B: Mapped Small Group Discussion Notes*). At the end, each group was asked to share a summary of their group's ideas.

Possible project area names:

During the course of the workshop, several people noted that the name for the project area does not adequately convey that other areas besides Silver Saddle Ranch and Carson River are included in the planning area. As such, people were asked to develop alternatives if they had any. Proposals included:

- Greater Silver Saddle Ranch, Prison Hill and Carson River Corridor Area
- Carson River Open Space
- Carson River Park of Carson City
- Pinon Pine Recreation Area
- Eastside Open Space
- Carson River Corridor Public Lands

Attachment A: Small Group Discussion Notes

The following is a summary of the small group discussions that took place during the May 8, 2008 public workshop for the "Creating a Community Vision: Silver Saddle Ranch and Carson River" planning process. Additional notes were provided on maps and are summarized as a separate document.

Group A

Goals:

1. Try to get water rights
-Preserve area's scenery "as is"
2. Plant more trees along river corridor (native, survives well in our environment, creates shade, habitat for wildlife)
3. Allow for primitive campground at north end of project area or on BLM land just outside project area
-Shared use trails as opposed to each activity with separate trails (equestrian, mt bike, hiking)
4. Connected trails with signage to inform of useage/private land
-Trails map published for further information for public
5. Small interpretive center at SSR. "White House" location. Built to reflect historical look of existing buildings

General comments on map (that do not related to a specific site)

- Small unobtrusive interpretive signage for education purposes
- Shared trails for hikers, equestrians, etc. (entire planning area)

Group B

1. Name the entire area "Pinon Pine Rec Area"
2. "Eastside Open Space" (a broad-type name)
3. Enforcement an important goal
4. Rules/regs must be enforceable. Resources to do it. Rangers, law enforcement, volunteers, reserves?
5. Noise pollution an issue with motorized activities
6. Educate public—etiquette, rules, etc.—signage?
7. Citations, penalties for violators--\$\$\$--make it hurt
8. Specific signage important
9. Fire danger an issue (wild horses to manage veg!)
10. License or certify to use ATVs???
11. Foster public ownership!!
12. Good planned trails—connectivity! Well defined!!
13. North end of Prison Hill non motorized
14. Portage at Mexican Dam for canoeing, rafting
15. "Put-in" at south end of Prison Hill
16. No user fees
17. Identify running/track areas
18. Make sure developed trail system is "equestrian friendly"
19. Connectivity from bike paths to trail heads
20. Develop as "working ranch" type environment at SSR
21. Better parking on edges—leave rest natural
22. Sanitation/health issues with lack of restrooms
23. ADA compliance—accessibility important and still keep natural

- 24. Safe freeway crossing for equestrian access important
- 25. Development intensity related to recreational experience

Group C

Idea	Goal it applies to...						
	1	2	3	4	5	6	7
Acquire Jarrard property	x	x					
Keep cows away from River and other waters	x	x					
Maintain resource values in irrigated ag areas	x	x					
Maintain access for wild horses to cross river			x		x		
Naturalize area along river when irrigation ceases	x	x					
Maintain west side of Prison Hill as open space (no R&PP)-equestrian bridge over freeway			x	x			
Protect natural character of Prison Hill	x						
Create buffers between OHV area on Prison Hill and private residences							x
Move OHV use east into Pine Nut Mts or Hot Sp. Mts. Create pass through access	x	x	x				
Limit size of Prison Hill OHV area to avoid residents. Focus use on a smaller play area	x	x					x
Consider events that raise funds for management (candy dance)							x
Improve access across Mexican Ditch within SSR. Not safe							x
Develop a trail system that protects the natural setting—"don't love it to death"	x	x		x			
Signs and interpretive features needed				x			
Separate uses (OHV, equestrian, hikers)				x			x
Manage to control noxious weeds (can be toxic to horses)	x	x					x
Area should be kept safe for all family members							

Group D

- Mark boundaries on Prison Hill south side vs. north side (OHV)
- Anderson property—undisturbed/as is or working ranch
- Prison Hill west side-Dog leash restriction. Signage at trail head
- Current use/status quo Prison Hill Westside
- Equestrian use to stay at SSR and other existing riding trails
- Preserve Horse T.H. access pt. PH area. See map for example
- Wildlife corridor habitat enhancement
- Pedestrian/bicycle/horse bridge (2 locations see attached map, comments in blue)
- Horses continue to be permitted in Riverview Park
- OK for appropriate events (size/type) for ranch
- Facility that fits the SSR for the use of ed/historical/cultural resources
- Volunteer coordinator for projects
- Maintain trails (garbage/fences) use of neighbors parking
- Law enforcement (ordinances) increased to protect resources including signage
- Status quo-PH keep/preserve
- No hunting in PH
- No trapping (commercial or recreational)

Group E

- Concern expressed regarding getting over extended—projects that have been pending but have not yet happened
- Focus of planning needs to be wider than “Silver Saddle” and a new project name is needed
- Active recreation vs. passive recreation—river access points focus of active recreation. All other forms such as organized sports (football, etc.) wouldn’t be okay
- Pedestrian, bike and equestrian uses are all compatible—OHV use is not.
- Planning should be a public process at the community level and a long range plan is important
- Complete loop around river
- Define OHV use area

Comment Cards

Card 1:

- Equestrian access to and across river (increase)
- Need better signage for allowed uses (better signage where motorized area boundaries are)
- Preserve equestrian uses in all areas
- Continue to allow OHV recreation on south end of Prison Hill and east side of river
- Adequate parking for equestrian events and Silver Saddle
- Shared use trails—hikers, bikes and equestrian

Card 2

- Ensure irrigation of SS hayfield—use waste water
- Limit river side development; keep it natural; small events;
- Connect the trails N & S ends of Mexican ditch, possible campground at N end.
- Signage indicating trail use—connections, private property
- Agricultural use should be maintained
- Small visitors center at SS—what about sewer/water?
- Fire management plan, weed control
- Ranger or police?
- City can’t afford to protect SSR and Prison Hill

Card 3

- I’m offended by idea of restricting horses to east. Horses should be allowed on both sides E & W
- Try to acquire more H2O rights or reclaimed H2O for irrigation
- Do work days—plant willows, cottonwoods/with schools but not close areas
- Consider campground and disc golf
- Maintain shared trail use for hikers, equestrians and mountain bikes
- Equestrian trails are appropriate and in keeping with historical use and should be encouraged
- Only small and unobtrusive education signs
- Dogs should be allowed

Card 4

- Prison Hill west—should be designated as open space
- South Prison Hill should be kept for offroad vehicle
- Connect the Carson River Corridor throughout include bike path throughout
- Rebuild McTarnahan Bridge to allow mt. bike and pedestrian access to Douglas Co.

Card 5

- Would like to be sure that no structures can be built in the Prison Hill Koontz Lane H2O tank area. Leave that area as is—open space—not paved, no parking lots paved—very rural. No 52,000 sq. ft. nonprofit buildings!!!! Trails OK, South Prison Hill off road OK

Card 6

- Any already partially developed area should have further dev. Controlled
- Increase law enforcement along riparian corridor—currently unsafe shore
- Shared trail use, hike, bike, horse
- Carson River Park site where development has already been started

Card 7

- Want to keep all property open to horse
- Ride to places that have tables and tie rails

Card 8

- Please keep equestrian use wherever it is present at this time
- Organized events are fine if they are compatible with the area: equestrian, etc. No motorized use
- Continue with horse and people (foot) traffic—it is good for horses to meet people along trails
- Realize that horses are “passive” users of the trails and area

Card 9

- This goal (1?) is imperative. No impinging development That includes “parks”
- Do not “enhance” the river as in developing it for activities
- Separate hiking trails from OHV areas enough that hikers don’t get OHV noise
- Not more than 4 additional accesses to the area. 2 for ranch, 2 for river
- Interpretive history, ethnicity, signs as part of education and interpretive opportunities
- A well developed center with adequate parking to be provided on the North and near hwy 50
- This needs to be managed within City/County code and regulations

Card 10

- The city should purchase Anderson Ranch ASAP and leave as is. Leave the mustangs alone!

Card 11

- Prison Hill and all access points; sign city ordinance on dog control-leash; voice control.
- Preserve current use on Koontz Ln access point from Edmunds east

Card 12

- Please keep all areas open to horses, hiking and biking. Keep access open on the Westside of Prison Hill

Card 13

- We would very much like to see the equestrian use currently going on preserved, including access points.

Card 14

- “Silver Saddle Ranch and Carson River Area” not inclusive of planning area—need better name
- Whole planning area is not just Silver Saddle Ranch—should be called “Carson River Corridor Public Lands”
- Regarding #4 under goals—“enhance access” can be interpreted as making more roads into the ranch. I would be strongly opposed to that. If the “horse people” are concerned about access to Prison Hill from the west, then that is a city issue (i.e. freeway, roads leading to the Silver Saddle Ranch. I suggest that changing wording to allude to freeway/horse access problems does not belong in the goals
- Some of uses for Silver Saddle Ranch will/should be moved to other areas within the planning area—eg put some uses on Ambrose, Riverview, Jarrard and Anderson ranch lands
- Passive activities should be weighted by sensitivity of habitat eg possibly no mtn bikes or horses or dogs in certain areas near the river
- No bleachers, no pavilion, no events, no increased parking or roads, no horse arena (already taken out two arenas/corrals on the ranch). No events
- Passive activities also (as in #4) should be weighted by speed and distance needs ie humans range is limited (one step is maybe 2.5 feet, a dog will run 3 feet at a step, and OHVs 15 feet in the same time. Slow vs. fast &

long distance uses should be considered

- The broad spectrum of public/gov. input should make this a 30 year plan—not one that can be changed without public process
- Trailheads further developed and maintained for OHV and horses in east side on Carson River

Card 15

- Enforcement is an issue. Need money! Need enforcement personnel—city budget? Rules—e.g., who yields to the other? E.g. horses/pedestrians, hikers with dogs/and with out dogs, bicyclists/hikers/horses/etc.
- A corridor loop coursing entire planning area

Card 16

- Equestrian use through this entire planning area is vital. Education of all users (equestrians included) would be a benefit—how to share the trail. Organized events at the Silver Saddle Ranch would be okay, such as trail trials, but they need to be sensitive to resources. They may also be a means of providing additional money for ranch maintenance. A working ranch with irrigated fields moving the Mexican Ditch trail away from the backyards would be great! And weed control is vital!
- Should be an important element in all future planning. If funding is needed possibly coming up with additional activities that are low impact but could generate funding would be okay—a necessary evil perhaps.
- Riverview Park also needs to remain open to horses.

Card 17

- I am interested in keeping the Prison Hill side (near water tank) wild and natural for hikers and horseback riders/dogs on leash or within voice control

Card 18

- To address goals 1,2 & 4, I'd suggest improving the parking at the Carson River Rd. entrance to SS Ranch then close the ranch (dirt) roads to motor vehicles and make non-vehicle access 24-7
- I agree that it is very difficult to identify private property in bounding areas such as South Prison Hill and east SS Ranch by the river. On specific objective I'd support is better signage to ID private property boundaries.
- Motorized vehicles (OHV by your design team) are not compatible with the goals 1 & 2. I think since some areas are already designated OHV (eg South Prison Hill) we are likely stuck with that. But let's enforce the "no OHV" areas and then efforts to restore the damage they've done to those "no OHV" will be effective. BTW, if we can rid the fragile areas of Prison Hill and SS Ranch of OHV, I'd love to work on the restoration.

Card 19

- Keep root cellar and red house available for group uses
- Enforced non motorized area throughout project area
- A Team—penning practice facility at SSR-0—could be a nice attraction for visitors wanting to see real ranch activity
- Wagon-carriage driving trail opportunities would be nice

Card 20

- There needs to be an active program to deal with invasive plants and animals within the area and particularly along the Carson River. The current riparian corridor is under siege by beavers.

Card 21

- I am most familiar with Riverview Park and Silver Saddle Ranch. I would like these areas to remain pretty much the same. I would be in favor of any recreational uses that:
 - o Do not make horse end
 - o Do not involve use of motorized vehicles

Card 22

- Concerning the Carson City River frontage—this entire area needs to be kept commercial free, park like environment. Some playground equipment type things to be encouraged. The area near the houses in Silver

Saddle Ranch would make a good park. There is no access between Silver Saddle Ranch and the Riverview Park. There needs to be another bridge built across the Mexican Ditch of the land along the river purchased.

- Concerning the Silver Saddle Ranch area and Prison Hill:
 - o Access is very limited---fires could be a disaster. Trails that are designed to be useable for everyone will help hand crews etc. to fight fires and maintenance.
 - o Access needs to be designed to prevent erosion and those type of problems. The present roads are eroding the area and area an eye sore. A designed progression of trail building so that volunteers can be encouraged/organized to complete the task. The process would not cost a great deal of money. There is probably already the needed expertise already working for Carson City.

Card 23

- Don't micromanage it
- Don't discriminate against equestrian usage
- Loop trails should be developed—different lengths
- Loop trail at Silver Saddle from river, Mexican Ditch, add bridge across irrigation ditches and up ridge back to ranch house
- No further development in Riverview, Ambrose and north past Empire golf trail. Already too densely used.
- "Swim park" picnic area on east side of river across from Silver Saddle

Card 24

- Put in a disc golf course where trees (shade) is available at least in some of the area. Make sure the area is located in such a place where it is not encroaching on other multiple use areas, i.e. equestrian, mountain biking, bird watching, etc. Some suggestions are near the Ambrose area closer to the Empire Ranch Golf Course, North Deer Run Road, somewhere near the BLM building.

IMPORTANT NOTE:

These notes are a verbatim record of specific comments that were marked onto maps during the May 8, 2008 public workshop. As different groups at the workshop recorded their ideas in different ways, additional comments were recorded as text only during that workshop and are not reflected on this map. As such, this exhibit represents only a portion of the comments received and should be reviewed in tandem with the written workshop notes. This exhibit is presented solely for informational purposes and not as a proposal.

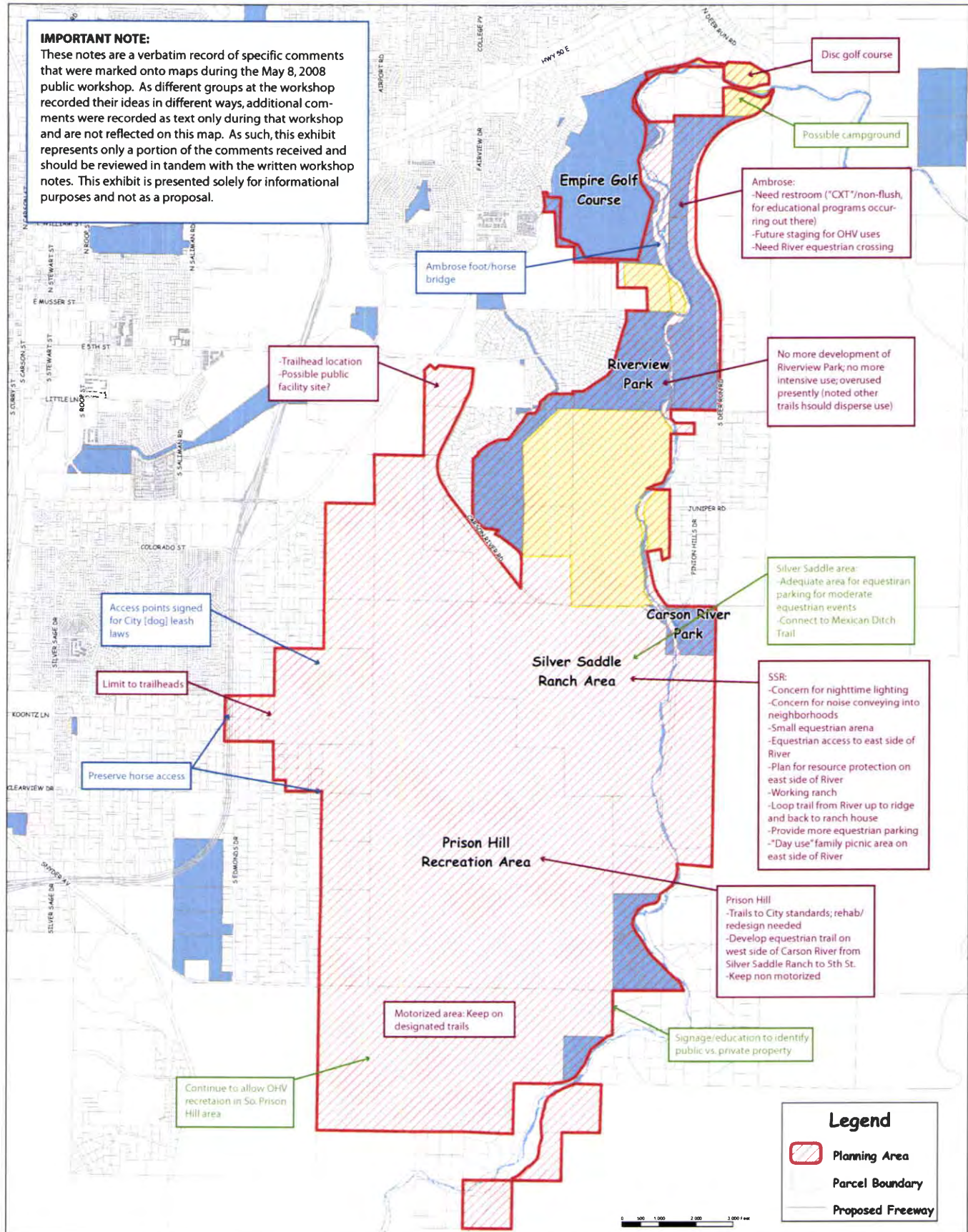

APPENDIX G:

Charrette Teams

**CREATING A COMMUNITY VISION:
SILVER SADDLE RANCH & THE CARSON RIVER**
A Community Design Charrette

Charrette Teams
May 29-31, 2008

Overview

To provide context for the charrette teams' work, the following is an outline of the desired outcomes and potential products for the charrette.

Charrette Desired Outcomes

- Define a community-wide vision for the Silver Saddle Ranch and Carson River area
- Develop an integrated management plan
- Foster partnerships
- Build support and capacity for community-based stewardship
- Develop a vision for how to sustain the Carson River ecosystem over the long term
- Identify sustainable management practices, including financial and implementation strategies

Potential Products

- Map summarizing planning and design recommendations
- Conceptual land use plan identifying potential uses
- Conceptual trail network map
- Design ideas for a visitor center for Silver Saddle Ranch
- Funding strategies
- Guidelines for a unified signage system
- Water management strategies
- Policies for use (i.e. trail uses, special events, etc.)
- Recreation and education recommendations

Framework

Based on the input received from the community through two public workshops and additional comments provided through correspondence to the planning team, the following vision and goals for the planning area were developed to guide the development of ideas and recommendations through the charrette.

Vision

The Silver Saddle Ranch and Carson River area provides close-to-home, natural, open space that contributes to quality of life for residents and visitors. This historic landscape helps to preserve Carson City's rural heritage while providing a variety of passive recreation and trail uses that are balanced with existing agricultural uses and protection of the Carson River ecosystem and its associated values.

Goals

1. Preserve and enhance the area's scenic natural, undeveloped character.
2. Protect and enhance the Carson River ecosystem, including associated upland areas.
3. Provide for a variety of trail uses, passive recreation opportunities and events that are compatible with preserving the character of the area and protecting natural resources.
4. Enhance access to the Silver Saddle Ranch and Carson River area, including Prison Hill.
5. Preserve the area's cultural heritage and resources.
6. Improve on-site educational and interpretive opportunities.
7. Manage the area for improved safety, resource and private property protection.

Team Structure

Given the range of sites, issues and opportunities throughout the planning area, charrette participants will be formed into three teams, each with a separate focus area. While each team will focus on a different area of emphasis, participants will be encouraged to check-in with each other and seek counsel/advice from other teams to feed into their work. There will be formal check-in times when all the teams will reconvene to facilitate coordination and integration of ideas. This also encourages synergy between groups.

Natural Resources Team

This group will focus on the Carson River ecosystem and natural resource issues. The recommendations will form the baseline for managing the whole area and will help provide parameters for how to integrate the other uses of the area (i.e. recreation, use areas, etc.). Additional issues to consider could include:

- Strategies to sustain the Carson River
- Water resource management (including water rights, effluent spreading, irrigation, etc.)
- Vegetation management
- Agricultural uses
- Invasive species
- Disturbance (i.e. flooding, fire, etc.)

Trails & Passive Recreation Team

This group would focus on a trail network (including water/aquatic trails) and additional passive recreation that would tie the whole planning area together. Specific issues to consider could include:

- Trail connectivity
- Public access points and staging areas
- Public/ private land interface
- Trail and passive recreation management and policy
- OHV use
- Education/ interpretation/ signage
- Recommendations for specific use areas

Silver Saddle Ranch & Prison Hill Team

Anticipating that these sites will likely be focal points for the planning area, this team will focus on exploring:

- How Silver Saddle Ranch would function as a hub for passive recreation, education and interpretation in the context of the site as an historic ranch
- Options for developing a nature center.
- Prison Hill uses, particularly the west and south side where recreation/trail uses interface with residences
- Management/policy considerations
- How to connect these areas into the broader planning area

Charrette Team Assignments		
<i>Natural Resources Team</i>	<i>Trails & Passive Recreation Team</i>	<i>Silver Saddle Ranch & Prison Hill Team</i>
<p>Genie Azad Carson River Coalition</p> <p>Margie Evans UNR Cooperative Extension</p> <p>Chris Freeman State Conservation Commission</p> <p>Jim Gaither The Nature Conservancy</p> <p>Dan Greytak Carson River Advisory Committee</p> <p>Ed James Carson Water Subconservancy Dist.</p> <p>Dale Kovach CFA Inc.</p> <p>Duane Petite The Nature Conservancy</p> <p>Robin Powell Nevada Important Bird Areas Program</p> <p>Kevin Roukey US Army Corps of Engineers</p> <p>Jim Smolenski Carson City Parks & Recreation Commission</p> <p>Jodi Stephens Office of Governor Gibbons</p> <p> </p> <p><u>Resource/support people</u></p> <p>Dan Jacquet BLM/Carson City Open Space Advisory Committee</p> <p>Nancy Santos Friends of Silver Saddle Ranch</p>	<p>Larry Gorell Lumos Engineering</p> <p>Micah Langdon Design Workshop</p> <p>John McLain Resource Concepts Inc.</p> <p>Bonnie Parnell State Assembly</p> <p>Ted Petersen Jeff Codega Planning & Design</p> <p>Deb Reardon National Park Service</p> <p>Howard Riedl Carson City Open Space Advisory Committee</p> <p>Coleen Shade Design Workshop</p> <p>Jeremy Vican Carson Valley Trails/Beneficial Designs</p> <p>Sandra Wallin UNR Cooperative Extension</p> <p>John Warpeha Washoe Tribe of Nevada and California</p> <p>Todd Westergard Carson City Parks & Recreation Commission</p> <p>Rich Wontorski Western Equestrian Alliance</p> <p> </p> <p><u>Resource/support people</u></p> <p>Michael Bish Friends of Silver Saddle Ranch</p> <p>Ann Bollinger Carson City-Open Space</p> <p>Arthur Callan BLM</p> <p>Larry French Friends of Silver Saddle Ranch</p> <p>Bryant Smith BLM</p>	<p>Shelly Aldean</p> <p>Valerie Anderson Sierra Club</p> <p>Ron Blakemore Blakemore Landscape Architects</p> <p>Donna Curtis Carson City Parks and Recreation Commission</p> <p>Ken Furlong Carson City Sheriff</p> <p>Peg Henderson National Park Service</p> <p>Lyndy Holton-Larson Design Workshop</p> <p>Mark Kimbrough Carson City Planning Commission</p> <p>Kevin Kirkeby Office of Senator Ensign</p> <p>Tina Nappe Sierra Club</p> <p>Erich Obermayr MACTEC</p> <p>Kathryn Shabi Carson City Parks & Recreation Commission</p> <p>Rich Shock Jeff Codega Planning & Design</p> <p> </p> <p><u>Resource/support people</u></p> <p>Elaine Briggs BLM</p> <p>Juan Guzman Carson City-Open Space</p> <p>Vern Krahn Carson City Parks & Recreation</p> <p>Kathryn Kever Friends of Silver Saddle Ranch</p> <p>Lee Plemel Carson City Planning Division</p>

APPENDIX H:

Field Trip Observations

Friday, May 30, 2008 Fieldtrip Observations Transcription of Notes

Silver Saddle Ranch and Carson River Area Community Design Charrette

Following the fieldtrip, charrette participants discussed their observations and impressions as a large group. These observations included:

- More/bigger signs needed
- River sections not known before
- Interpretive signage
- How bad level of mercury [in river]?—bad, don't eat the dirt—advisory on fish consumption. Construction projects—mitigation
- Areas for larger parking, trailers, turnarounds...only at trailheads
- Kiosks would be nice—stand in center and see where trails area. North Silver Saddle ends—involved high school and elementary students and educate to protect
- Will take a lot of money to do—1/2 dozen opportunities to generate revenue
- Emphasis on development—impacts on wildland areas—access impacts; develop reserves for wildland; identify species' needs
- Develop a habitat conservation plan, identify areas first; then develop other areas
- Connect to railroad and museum—trail to take you there
- Magnificent views at key locations to unify sense of whole place
- Set sense of what was here before—vistas good fo; also birding at theses sites
- Ties in with tourism planning

Sense of place

- Diversity of use over history
- Tie together history, mining, add information signs, ranching
- Authenticity=working landscape. "Working open space" now two publically owned important for public to be able to see
- How many out buildings will be kept? Jarrard, some have been demolished. Stone building--maybe should be looked at
- City will keep service road; keep cultivated area—how to do? Working landscapes?
- Carrying capacity—look at when planning activities and numbers of people
- Community concerned with possible over use—so carrying capacity important
- Some disrespect for the land. So management will have to look at; education and outreach to users with message of respect for the land, e.g. OHV users...partnerships for stewardship
- Adopt-a-___ program/partnerships
- Kids aren't the ones shooting at signs, etc. Need to establish a sense of ownership
- Issues: special events/sites. Fees, etc. how to do management
- Silver Saddle Ranch: Has program for events and policies in place. Possible revenue. Horsemens' camp/park

- 4-H and youth programs. Can help in this type of thing there and watching out. If given place to meet (can't meet in homes). Has various programs (ATV, resources, riding, etc.)
- Kids in 4-H will be sitting here in 20 years. Teaching them now.

Issues

- Communication
- Beavers
- Safety—need to feel safe alone—relative to other people
- Signage re: white water stages at portage areas
- Connectivity up and down river
- Connectivity of uplands and river=corridors for wildlife
- Neighbors not within view but area concerned (at water tank)
- Junk cars need to be picked up. How to get out? Have had to use helicopters
- Have done clean-up days. National Lands Day, etc.
- Stewardship—all users should wear button, t-shirt to show someone is watching out—a presence—help unit us as a conservator of the ranch
- Probably not getting trash in the first place—had to value property
- Regarding button idea—hasn't worked for one
- Need to partner with law enforcement for fines; need to educate kids
- Re: "ownership"—property owners are very active in watching out; a very few people can have a big negative effect
- Look for unifying theme: stewardship is one. Need to appeal to people membership in community
- Most trails don't meet any specifications; can become maintenance concern
- Possible name of area "Prison Hill" undermines stewardship
- Education on origin of name; just add on to name "Prison Hill-OHV Area"
- Education: corridor important for flooding, opportunity for multi-objective/multi-benefit project

APPENDIX I:

Natural Resources Team Original Notes and Drawings

Natural Resources Team Notes:

Sustainability

- Not necessarily existing condition
- #1 focus/place to start: floodplains/100 year area
- Special flood hazard area
- Not build permanent structures, major capital improvements, exceptions:
 - Agriculture
 - Recreational activities/amenities (appropriate)
 - Grazing (management plan) to determine what is/isn't appropriate
 - Include BMPs
- Riparian corridor

Wildlife

1. Protection of sensitive species and their habitat including nesting, foraging, denning and migration
 - Regulatory authority: fed/state/local
 - Riparian corridor: no disturbance within ISO buffer from edge of corridor. No development except at designated sites
 - Wildlife movement/migration corridor
2. Management of sensitive species and habitat
 - Avoid/minimize habitat fragmentation (ex. existing trails, proposed trails)
 - Utilize existing interdisciplinary management plan for the Silver Saddle Ranch and the Ambrose Carson River Natural Area and Carson River Master Plan pending development of new planning area management plan.
 - Invasive/nonnative species, impacts of
3. Develop habitat conservation plan
 - Develop planning area management plan
 - Consider impacts (noise and disturbance) to wildlife
 - Consider activity level (ex. number of participants, time of day/year, frequency)

Vegetation/Wildlife Habitat

1. Protection of desirable (noninvasive, native) species
 - Various successional stages (ex. understory vegetation)
 - Contiguous (unfragmented) vegetation
 - Soils: survey to determine carrying capacity (appropriate activities)
2. Management of invasive/nonnative/noxious plant species
 - ID/monitor/remove weed population, especially disturbed (designated trails, roads, construction) and developed areas
 - Outreach/community education/stewardship
 - Regulatory authority, comply with

3. Revegetation of desirable species (restoration)
 - Cottonwood regeneration—riparian corridor
 - Establish/succession veg stages (ex. understory)
 - Reclamation/revegetation of disturbed sites

Strategies to Sustain the Carson River

- Resource/soils assessment
- Decommission/reclaim trails with grade in excess of X% to manage erosion and water quality
- Follow Carson River Master Plan, including trail setbacks from river
- Comply with Clean Water Act
- Carrying capacity
- Flood resistant design that does not impair river floodplain function

SUSTAIN THE RIVER

SFHA

- LIMIT PERMANENT DEVELOPMENT
- AG, TRAILS, SOFT SCAPES, RECREATION USE IS O.K.
- CONSERVE & REPAIR HABITAT (CONTAMINATED FOREST)

RDCC

- ADAPT LIVING RIVER CONCEPT
- NO HARD SCAPES OR DEV.
- LIMIT / NO HARD PUBLIC AREAS "DON'T LIVE IT TO DEATH"
- SPECIAL AREAS - NO DEVELOPMENT OR DEVELOPED AREAS

Ag - Wet Meadows Wetlands

- No ~~Development~~ ~~Development~~
- Ag ~~Wetlands~~ ~~Wetlands~~

SPECIAL FLOOD HAZARD AREA (CROSS RIVER PLAIN & BROADBENT)

Riparian - Dynamic Channel Corridor

SMA JAMES

SMA S. SSR AREA

SMA N. W. 1/4 1/4 00 ST SERPA PROP.

Vicinity Map

SFHA

SPECIAL HABITAT M&D PROP.

Legend	
	Carson City Trails
	Proposed Freeway
	Carson River
	Planning Area
	Parcel Boundary
Flood Plain	
	Flood Plain A (100 YR)
	Flood Plain B (500 YR)

VEGETATION

Noxious weed management Invasion/spread

- Disturbance
- Flooding
- Good precip year
- Harmful weed species to w/c

EXISTING UNDERSTORY
CONTIGUOUS VEGETATION
Invasive/Non-Native/Community Plant Species

- Sensitive species & species habitat
- migration corridors
- Trails - no trails
- Grazing Plan
- vista points okay (viewing)
- Effluent - consider more nitrogen uptake
- Enclosure to protect wetlands (Submergent veg)

Sensitive Areas

- Wetlands
- Drawnages
- Steep slopes (> 5%)
- Social trails (not planned or maintained)
- Sensitive wildlife habitat/species (foraging/nesting/migration)
- Sensitive plants

Riparian Corridor

Emarsh
Wetlands
Wet meadows

Tall Wetland
Elephant Grass

Wet Wetland
Meadow Grass

Tall Wetland
(Fountain Grass)

• weed free agriculture

upland

upland

DRAFT

Natural Resources

Legend	
	Planning Area
Vegetation	
	Agriculture
	Cottonwood/Wilows
	Developed
	Emergent Marsh/Wet Meadow
	Sage Brush/Rocky Outcrop
	Open Waters
	Parcel Boundary
	Proposed Falloway
	Carson River

APPENDIX J:

Trails & Passive Recreation Team Original Notes and Drawings

Trails & Passive Recreation Team Notes:

Themes

- History (mining, ranching, Native American)
- Geology
- Biology and ecology
- River corridor and its influence on the project area

Management and Policy

- Adopt existing Parks and Recreation Master Plan
- Pursue mutual agreement with the BLM and Parks and Recreation Dept.
- Use volunteers
- Start a trails association
- Signs should be low maintenance; difficult to destroy, easy to change elements (i.e. panels, mileage markers) later
- Most difficult topic to address!
- BLM has low staff resources
- Adopt a trail/resource/area/etc.
- Cheap labor available at the prison
- Sponsors, running clubs
- Review from a business perspective
- Custom-designed signs, built by prisoners. Sell nationally, produce locally.
- Designate the area officially as open space, not as a park.
- Neighbors have "deep pockets", may be able to make contributions
- Ask people to include donations to the Ranch in their wills
- What is the "big idea"? Carson River and Carson City, "A Living River: Lifeblood of the Community".
- Concept based on river as the common thread:
- Living dynamic system
- Interface man/environment
- Focus: education and environmental interaction
- Yesterday: prehistory, Native American occupation, settlement including mining, V&T, ranching, etc.
- Today: Urbanism, education, mechanized recreation, non-motorized recreation, return to environmental concern for environmental participation/interaction
- Tomorrow: sustainable design, green building prototypes, solar/electric transportation system onsite, living laboratory, prototype demonstrations of solar/wind/water harvesting/other scientific/reclaimed water. Enhanced educational opportunities for outreach and tourism
- Needs: Sustaining the "Big Idea":
- Administrator or manager: workshop elements as advisory committee
- Marketing plan draft: packaging, grant writing, funding including local education leaders
- Storyline: who, what where, why-yesterday, today, tomorrow
- Program scope
- Natural resource management
- Partnership/grants
- Purpose description in lands bill

Trail Connectivity

- Identify connections to new areas
- Reexamine master plan
- Connect across new pieces as acquired (i.e. along river)
- Buy the Girard property on the west side of the river!
- Public education would unify users. What do people expect for each segment of the trail? Disperse uses and direct people to appropriate locations to recreate.
- Connect trails to nearby counties
- Signage – use various types. Unify the area, tell people what is not allowed, and include interpretive signs.
- Connect to Prison Hill from the west after the freeway is constructed.
- Non-motorized connections from town to the planning area is important; don't depend on people driving.
- Reduce the number of trails
- Conduct a new inventory (if needed, determine data needs)
- Use natural resource data, avoid these areas
- Hells Bells – identify a trail to get closer to the river
- Loop trail
- Access by adjacent homes
- Platforms with views, tell stories at each viewing area
- Prison Hill – trail from water tank to the Carson River
- Trail surrounding all of Carson City
- Potential river crossings needed at the south

Access Points and Trailheads

- Add an access point to the river at the south
- Determine size and amenities for trailheads
- Consider financing options – how will they be built?
- Parking for trailers – identify a location (graded and appropriate sizes). Identify 1-2 sites for parking. Link signage, etc. at parking areas to overall theme.
- Determine surface materials – DG, asphalt, or what?
- The Carson River right-of-way and environmental right-of-way issues may result in a setback zone from the river corridor. Coordinate on these issues.
- What trails do we not need? Evaluate what we want to have decommissioned.

Public-Private Land Interface

- Fencing of private land should be up to the landowner. Agencies should not be responsible for installing fences. Post private land instead. But, there aren't a lot of trespassing problems.
- Standard demarcation (fences) should be maintained by landowners.
- People want to respect private property but don't know where the boundaries exist. Existing signs are too small.
- Educate with signs on both public and private lands.

OHV Use

- Users should stay in the OHV area\
- Increase education
- Adopt an OHV area!
- Smart design for this area, no dead ends
- Advocate for permits – fees could be used
- Local ordinance could be written
- Identify good trail alignments, durable and long-lasting
- If trails removed, what do you do? Can these areas be re-vegetated? If so, need to identify funding source.
- Use examples from other communities (east side of Tahoe Rim Trail has addressed similar issues). Learn from other examples, don't reinvent.
- Stop use at discontinued trails
- Define the OHV area by a trail or other feature
- Add signage in the OHV area
- OHV use occurs outside of legal Prison Hill area

Specific Use Areas

- Anderson & Gerard properties – what will the use be? Possible uses: wetlands, integrated passive use, trails, horses and pastures.
- Educate re: reclaim water use and safety issues.
- Is using gray water (reclaimed water) worse than mercury?
- Include disc golf at Morgan Hill and Deer Run area
- Designate safe swimming areas
- Identify a small facility for meetings
- Use "Green" design standards, may lead to grant eligibility (GREEN = GRANTS)
- Include history, cultural information, and trail maps at the interpretive center
- Amphitheater

Passive Recreation – Other Uses

- Existing passive recreation: hiking, dog walking, horseback riding, biking, geo-caching, fishing, rock climbing, birding, rafting, canoeing, kayaking, stargazing, picnicking, hanging out, meditating, beer drinking, par course, environmental education programs, cultural heritage programs
- Existing motorized recreation: motorcycles, quads/ATV, jeeps
- Community garden
- 10k marathons
- Disc golf – brings tournaments, money and people to the area
- Rock climbing
- Determine the number of people that will use each activity/amenity; base amenities developed on levels of use
- Geocaching
- Dog park
- RV park
- Senior Center outings ("going back in time" for seniors)

- Boy and girl scouts – bird box building events/outings
- Training facility to Sheriff's office
- Birding
- 4H, public groups, elder hostel, weddings
- White water rafting
- Mexican Dam – keep it open for water
- Define passive recreation for the area, what does this mean?

Educational and Interpretive Signage

- What educational programs currently exist (i.e. Carson Middle School)?
- Divide the area into subsections, determine history, wildlife and interpretation for each
- Sign types:
 - 1) Regulatory
 - 2) Interpretive
 - 3) Maps
 - 4) Directional
 - 5) Mileage markers
- Get others involved in sign design (i.e. kids, NV history classes, school groups). In Virginia City, signs were created by high school students.
- Make the signs long-lasting
- Create a parallel website

Signage

Types

1. Informational Signs
2. Interpretive Signs
3. Combination informational and interpretive signs

What do we need to communicate?

- Directional signs - entire system
- Allowed used

Signs need a unified theme – design theme and conceptual theme

Conceptual theme can change

Thematic example: "A Canyon in Time"

Ideas for themes:

- River is a key element, it is the reason that everything in our area is there.

Recommendation: Develop an overarching theme for signs.

Spanish Spring canyon used "A Canyon in Time".

Theme

- Ranches – Silver Saddle
 - Geological features
 - History of Prison Hill
 - Ambrose – wildlife
-
- River, Silver Saddle and Prison Hill.
 - Describe human and natural history.

- Signs need to be tied to something physical.

Signs have a unified look.

Background photos may be different; like the agenda.

Transparency within overall look repeated over and over.

Use silhouette photos.

Use something subtle in the background.

Informational

"Overall" signs at beginning of the trails.

Include these at all of the entry points.

Official access points – at trailheads, river access points, and all entry points

Concept – hit people right away when they enter the area

- Provide a picture of the entire trails system
- Locate where you are on the system
- Welcome, you are here
- Allowed uses

Separate system for specific trail information

Creates an expectation of what to look for

People know what to look for; use the same signs used in other parts of Carson City

Installed in 45 minutes, costs \$25, easy to replace

Use all recycled materials (TREX), more expensive but reduce O&M costs later

Trail Access Signs at intersections of the trails

** Develop trail names and loops, be able to develop where you are and where (visitor safety)

Need to close down many of these trails.

Dynamic river corridor, keep paved infrastructure away from this area. Allow the river to migrate somewhat.

Keep signs out of the 150' setback (this number from Carson River master plan, which is 20 years old!).

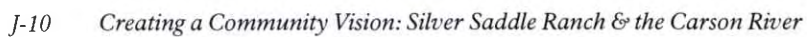

APPENDIX K:

Financial & Marketing Concepts

Financial and Marketing Concepts (developed by Ron Blakemore)

Goal:

Make the program sustainable on its own by the fifth year of operation

Areas of Financial Concern

1. Administration
2. Marketing
3. User services
4. Capital improvement program
5. Operation and maintenance
6. Planning and design standards and guidelines

Potential Source of Funding

1. Administration: day-to-day operations required to develop public programs, manage the program, maintain the Master Plan and fulfill the mission.
 - a. BLM/CC
 - b. SSRP Enterprise Fund (Silver Saddle Recreation Enterprise)
 - c. Shared resources and costs among govern agencies
 - d. Lease revenue
 - e. Bicycle registration revenue
 - f. SSRP Foundation (501c3 not-for-profit)
2. Marketing: capitalize on financial opportunities by identifying opportunities to create and sell the products and services produces by the program.
 - a. Private sector sources
 - b. Grants-in-aid
 - c. Private not-for-profit foundation
 - d. Product marketing and licensing program
 - e. Standards and design criteria
3. User Services: a full range of programs intended to foster public support and give back value to all segments of the community served.
 - a. SSRP Foundation
 - b. Pilot program grants
 - c. Volunteer efforts through a Stewardship Program
 - d. Cooperative agency contributions
 - e. Cooperative interagency projects
 - f. Cooperative Transportation projects
4. Capital Improvement Program: combination of facility drive and conservation/preservation driven facilities
 - a. Grant funding sources (conservation, preservation, historic, transportation, sustainable resource, design/energy, etc.)
 - b. Stewardship program
 - c. Corporate donor program
 - d. Public/private ventures (PPVs)

5. Operation and maintenance: necessary for the care of facilities and protection of the resources, user safety and security, upkeep and repair, and incentives to attract public participation.
 - a. Grants-in-aid
 - b. Endowment program
 - c. Stewardship program
 - d. Agencies cooperative of Joint Powers Authority (JPA)
6. Planning and design standards and guidelines: resolve inconsistencies among regional systems/adjacent jurisdictions, develop seamless transitions
 - a. Grants-in-aid
 - b. Corporate sponsorship
 - c. Agencies cooperative or Joint Powers Authority (JPA)

Sample Funding/Support Sources

1. Federal and State Programs such as ISTEA, Federal land exchange programs, National Recreation Trails Fund, RPPA, transit related grants (DOT), watershed and flood prevention programs, economic development programs, historic preservation funds, endowment for the arts programs, SCS, agricultural extension programs, CDBG, environmental quality programs, state bikeway programs, regional transportation programs, habitat conservation programs, vanity license plate program, Correction Services programs (youth and adults), permits, fees and tax funds, National Bicycle and Pedestrian Advocacy program, Rails to Trails Conservancy.
2. Other sources:
 - a. Local business like bike shops, equestrian centers, food and beverage concessions, equipment sales, equipment sales and repair services, shuttle services, bike lockers.
 - b. Exchange sources such as staging space for area safety patrol, archeological display/office space for onsite work, green demonstration improvements for working display, etc.
 - c. Enhanced fee based services might include audio/visual program as an educational tool, photo album resources, first-class animal overnight services for horses (cows, sheep or ?)
 - d. Intellectual services and product licensing
 - e. Property leasing revenue (or service exchange)

APPENDIX L:

Silver Saddle Ranch & Prison Hill Team Original Notes and Drawings

Silver Saddle Ranch & Prison Hill Team Notes:

Silver Saddle Ranch Uses Brainstorm (Friday)

How function as a hub...

- Passive recreation
- Education
- Interpretation
- Interpretation, context of historic ranch

Silver Saddle Ranch Management Focus/Theme:

- Interpretive site/themes: needs to be ranch lifestyle, working ranch—protect at all costs—provide for/include other uses but “to side”—historic site the same—no cars on site—can be near but not at middle/on ranch, interpretive ranch. Context bubble (see diagram)
- Determine theme
- Also environmental and cultural theme-sub themes
- Overriding theme is river—drew other uses at separate locations
- Ranch in a context
- Kids—ranch need access—none at ranch—Ambrose better/or other side
- Education—before jump into environmental education, what are the niche needs, what could ranch site fill
- Recreation—e.g. equestrian needs to not have impact to ranch
- Part of draw is experience—do trail ride through ranch?
- 4-H horses stay?
- Each site doesn’t need to provide all uses—too many access points—possibly one Carson River Park access—look at globally
- Tractor ride/wagon ride to ranch
- Environmental education: work with school system—what grades, what topics, curriculum
- Develop an interpretive plan—themes, appropriate stories, support materials, signs, etc.

Nature Center

- Need to stay with theme of river—provide setting for equestrian and other activities without impacting ranch (cultural landscape). Support infrastructure for events needs to be located outside historic “bubble” area. Event, itself can be in while protecting ongoing use of site.
- Other ways to meet that need due to cost of operation
- Work on interpretive program instead of place/building?
- Nature education could be accommodated somewhere on ranch—relate to river
- Probably with storage of materials

Prison Hill Uses

1. Inventory trail system—where: equestrian staging (trail group)
2. Keep OHV where is now—better boundary based on topo. Local use, no emphasis on exterior use access
3. South: OHV; Central: Multipurpose (nonmotorized); then separate trails for bike/peds/equestrian

4. Equestrian overpass-on freeway at Valley View low impact uses
 5. West entry: limit to passive uses and allow water tank with fit into landscape
 6. Redefine OHV area and can still locate loop to north south end/how to get kids from A to B access to OHV area
 7. Need well-defined, useable trail from ranch to Prison Hill
 8. Also look at trail from Mexican Dam to top—possible conflict with OHV
- Mark trails
 - Rehab/realign/decommission
 - Decommission some trails
 - Educate people about decommissions
 - Social trails from each property/house
 - To work-city ordinance-OHVs-to enforce
 - Main function west side-establish trailheads
 - Design new alignments to meet these needs
 - OHV-what can Sheriff enforce? What resources do they have?
 - North end-provide staging area at R. Road non motorized
 - Consider use of onsite caretaker (at SSR)
 - Barriers? How to get from SSR to Westside of Prison Hill
 - Loop trail good—but keep out of OHV
 - How to do fuels reduction with ? use as trail
 - Connect to Douglas Co. may not be ranch, may be Prison Hill
 - Douglas—looking for connectivity to Carson City—get proposal moving forward?
 - View enjoyment
 - Define City Character

Silver Saddle Ranch Brainstorm (Sat)

- Sheriff's office resource
- City Park rangers-enforcement capable ride trail
- Or volunteers-deputize?
- Consistent signage—meet standards (but not big)
- Maintain facilities within ranch—storage secured, controlling board to manage ranch
- Use charrette as springboard to development plans for all resources/management areas to use day to day
- Interdisciplinary team to look at
- Keep people with knowledge to use
- How will land ownership transfer affect? Will Fed. people be able to work on?
- Don't impact ranch at working historic ranch
- Protect natural resources—tr. outside key res. like wetland, other wildlife area
- All natural resources—inventoried for species population, reprod. & sustainability & management accordingly
- Still need access to ranch for environmental education, non intrusive

- Use point access instead of linear trail
- Create "Friends of ____" for the larger area
- How to get an organization going—active volunteer
- Look at a new name to encompass entire area
- Bureaucratic structure in place in City for Carson River corridor. Maybe broaden their mission.
- Engage nonprofits and others with expertise
- Concern—look at what resources losing in exchange of land
- Involved law enforcement agencies in planning and fires, safety, EMTs

How to connect to other areas

- SSR—should be "park headquarters" for whole area including ranch and Prison Hill
- With V&T depot—need to consider connection, information etc, partnership
- Use headquarters—at roundabout at school instead of at ranch (5th & Carson River)
- Manager as on "enterprise account" and generate business for revenue to manage place...while maintain character. Concern that to "sell it" would become so that it shouldn't
- What kind/size of activities at ranch—maybe other area use for events
- Use a fee-based system to generate income
- Fee based idea that fees make an event/operation sustainable is not accurate
- Billing—show true costs vs. charges
- User fee vs. entrance fee, special fees
- Signage expr. "true costs"
- On fed. Lands—need to acknowledge open space issue for future
- For fees to generate income—almost impossible for fees to cover costs
- Special events—could set fees to cover cost of event. Not operate entire site
- Direct cost (set-up, etc.) but not of management entire site
- Need to connect down river to Lyon County. Does aquatic trail do this?
- Want land trail
- Connect Carson River to Sierra Front
- All river components need to be connected by a first rate nonmotorized trail system
- Connect events at SSR with events at Jarrard/Andersen?
- Scheduling—all parties access to calendar—knowledge of what is going on. Master calendar—all areas website access.
- If need bigger or better location could consider Jarrard/Andersen?
- How connect to adjacent public land—some say don't connect, don't want a trail—need to respect—and how plan connections there lines
- Possible fence between private and public land to minimize impacts
- Friends, key volunteer groups—roles and rights
- How to move forward with pending legislation

Management Policies

- Fed. Involvement on ground is likely to disappear (staff, fed. Resources, scope—arch.)
- Legislation needs to address special events and fees
- Useage nonprofit vs. commercial
- Relationship nonprofit with feds

- Wildlife management not typically done by city—archeological/cultural resource
- Key: How can city enforce, protect, develop, maintain, develop, manage effectively if they own

Other discussion/brainstorm

- *Silver Saddle Ranch & Connections*
 - o Arena
 - o Trail trials—fields
 - o Sandpit for stargazing
 - o 4-H
 - o Car club
 - o Trail construction
 - o Birding
 - o Cattle (minimal)
 - o Scout troops
 - o Archaeology
 - o Cultural uses
 - o Restoration
 - o Nature center
- What should be there?
 - o Interpretive center, e.g. Western Folklife Center (Elko), saddles, branding, previous ranch history, 4-H
 - o Small event center (indoor/outdoor)—up to 60 people (small scale, e.g. Bartley Ranch)
- Themes
 - o Historic ranching
 - o River as path of history
- Equestrian/special events
 - o Share event area
 - o Staging areas in pasture? When needed?

Silver Saddle Ranch (Saturday Summary)

- Theme: “Family working ranch”; ranch lifestyle
- Policy: Protect ranch theme
 1. Non-ranch related uses only outside the “ranch bubble”
 2. Keep ranch-related uses and events inside the “bubble”
- To-do: Develop an interpretive plan (themes, appropriate stories, support materials, etc.)

Prison Hill (Saturday Summary)

- Main use: access and trailheads:
 - o North: pedestrian/equestrian
 - o South: motorized
 - o East: pedestrian/equestrian
 - o West:
 - Koontz: pedestrian/equestrian
 - Valley View: equestrian
 - Clear View: pedestrian/equestrian

Management (Saturday Summary)

- Move forward with interagency task force (coordination, existing groups, transition issues)
- Items for discussion:
 1. Plans: site management
 2. Finance/fees/costs
 3. Ongoing management:
 - Organizational development
 - Volunteer coordination
 - Monitoring-natural resources
 - Event management
 4. Transition during lands bill

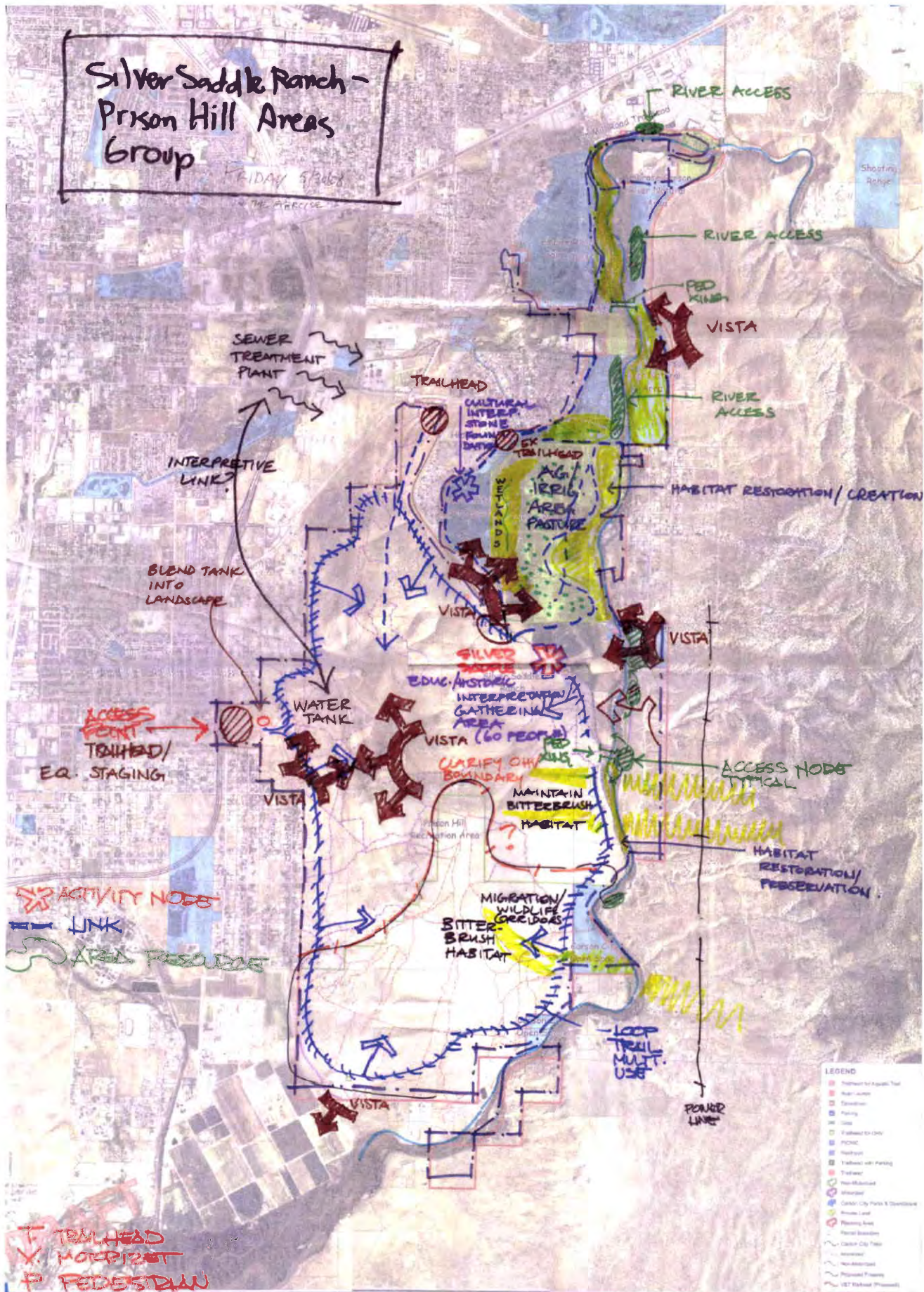

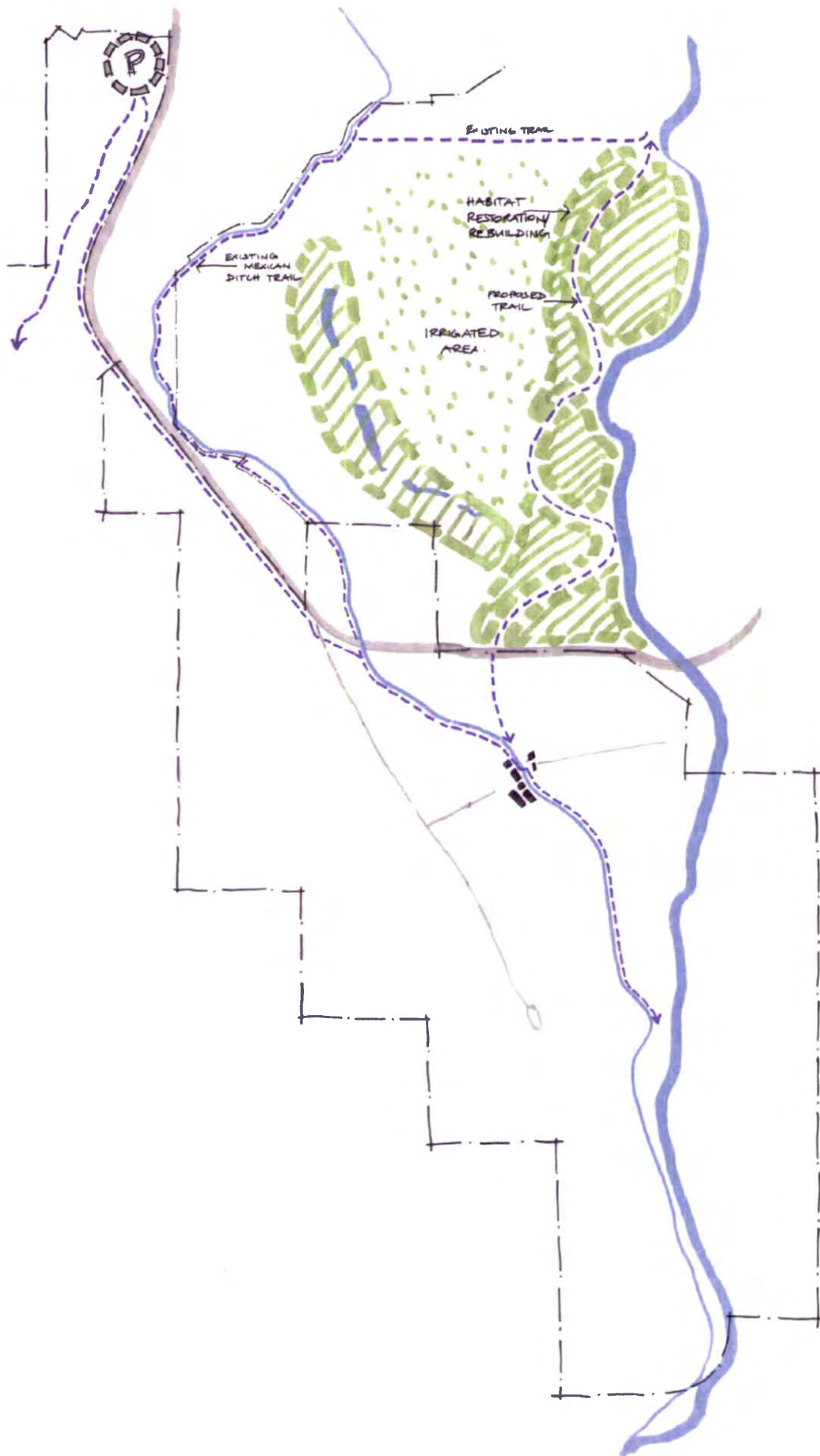

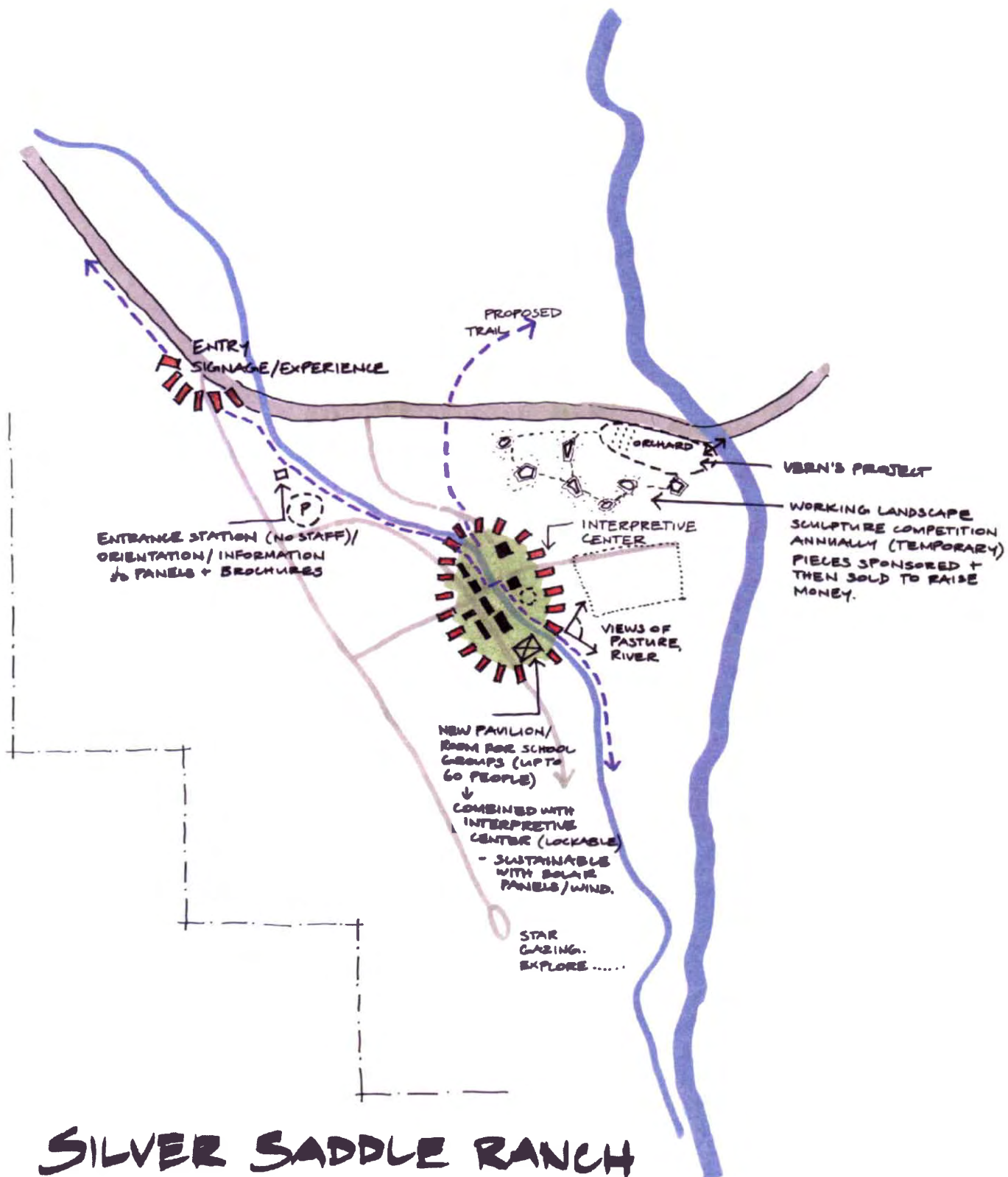

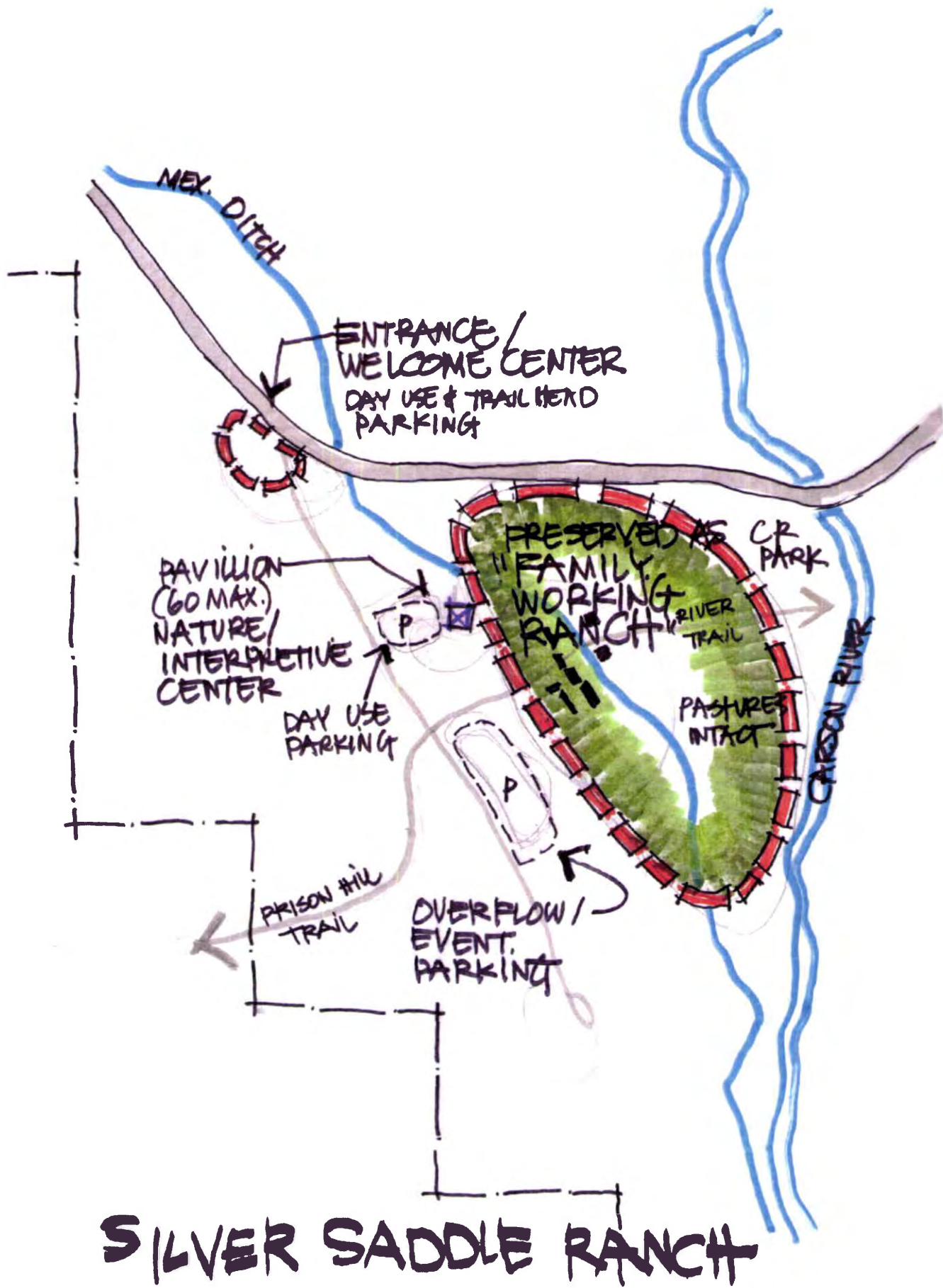

SILVER SADDLE RANCH