

Item # 10c

**CARSON CITY, NEVADA
REQUEST FOR BOARD ACTION**

Date Submitted: September 22, 2006

Agenda Date Requested: October 5, 2006

Time Requested: 10 minutes

To: Mayor and Supervisors

From: Public Works - Engineering Division

Subject Title: Action to approve an Agreement between the Nevada Department of Transportation (NDOT) and Carson City for the Adjustment of Utility Facilities for a Portion of the Carson City Freeway Project, Phase 2A from Colorado St. to the Linear Park Ditch.

Staff Summary: Carson City is in the process of relocating their facilities as part of the Carson City Freeway, Phase 2A Project and the above described agreement is necessary for the construction and relocation, and reimbursement of a portion of the relocation costs.

Type of Action Requested: (check one)

Resolution

Ordinance

Formal Action/Motion

Other (Specify)

Does This Action Require A Business Impact Statement: Yes No

Recommended Board Action: I move to approve and authorize the Mayor to sign the Agreement between the Nevada Department of Transportation (NDOT) and Carson City for the Adjustment of Utility Facilities for a Portion of the Carson City Freeway Project, Phase 2A from Colorado St. to the Linear Park Ditch. The fiscal impact is \$3,101,843.00 to the Sewer and Water Capital accounts.

Explanation for Recommended Board Action: The proposed cooperative agreement with NDOT will allow the City to relocate sewer and water infrastructure from Colorado St. to the Linear Park Ditch that currently is in conflict with improvements proposed in conjunction with the Carson City Freeway. Carson City is proposing to construct extensive sewer and water relocations as well as extension of water primarily in Colorado Street, South Saliman Rd, Fairview Drive and east of the proposed Freeway, north to Linear Ditch areas, as summarized in exhibit "A" attached to the agreement. The estimated project cost is approximately \$3,101,843.00 which includes engineering, construction management, construction, and a construction contingency. As further tabulated in exhibit "A" approximately \$2,631,101.00 of the total project costs is designated as a reimbursement through standard NDOT procedures. The reimbursable work is that work which is being required of City utilities contained within City Right-Of-Way and easements which we have a "right to occupancy". Of the project total, approximately \$470,742.00 is deemed to be a "betterment" which represents work in which the City is undergoing that logically should occur at this time that will improve the overall infrastructure as completed, such as the relocation of water facilities to accommodate the widening of Fairview Dr west of the Freeway and water distribution facility upgrades in S. Saliman Rd..

The agreement will allow the City to move forward with the bidding and construction of the utility relocations so that NDOT'S Phase 2A contractor can proceed without conflict with the utility work.

Applicable Statue, Code, Policy, Rule or Regulation: NRS 408

Fiscal Impact: \$3,101,843.00, of which approximately \$2,631,101.00 is reimbursable from NDOT

Explanation of Impact: The majority of the project costs will be reimbursable by NDOT.

Funding Source: 515-0000-434-7998 NDOT By-Pass Replacement (Reimbursable)
515-0000-434-7999 NDOT By-Pass Extension (NonReimb.)
520-3505-435-7893 NDOT By-Pass Non-Reimbursable
520-3505-435-7894 NDOT By-Pass Reimbursable

Alternatives: N/A.

Supporting Material: Project Overview Map
Agreement and Agreement Exhibits

Prepared By: Jay Ahrens, PE, Senior Project Manager

Reviewed By:

_____	Date: _____
(City Engineer) <i>Jay Ahrens</i>	Date: <i>9/26/06</i>
_____	Date: _____
(Public Works Director) <i>J. Minter</i>	Date: <i>9/26/06</i>
_____	Date: _____
(Finance Director) <i>[Signature]</i>	Date: <i>9-26-06</i>
_____	Date: _____
(City Manager) <i>Michael T. Syle</i>	Date: <i>9-26-06</i>
_____	Date: _____
(District Attorney)	

Board Action Taken:

Motion: _____

1) _____	Aye/Nay
2) _____	_____

(Vote Recorded By)

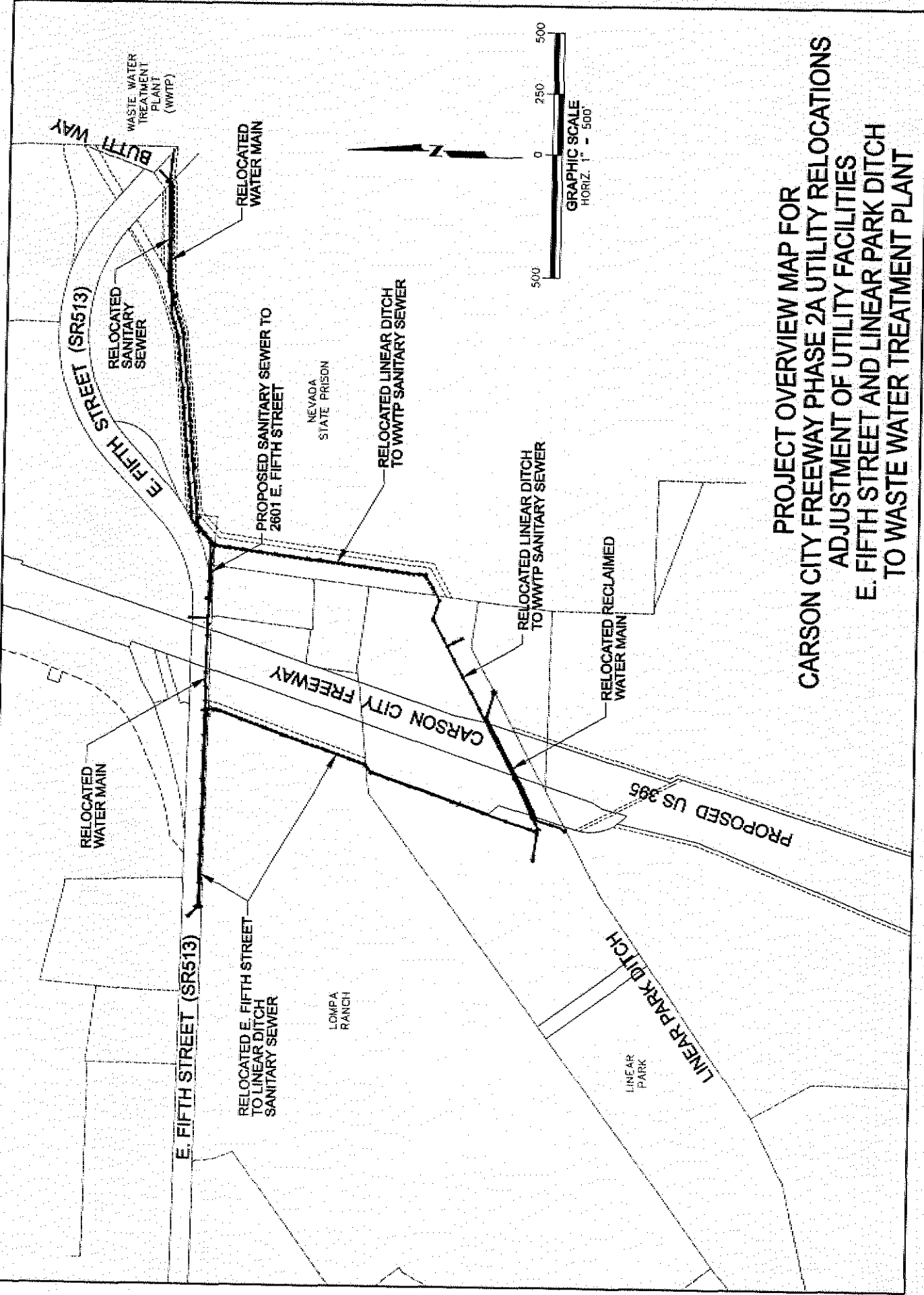

**PROJECT OVERVIEW MAP FOR
CARSON CITY FREEWAY PHASE 2A UTILITY RELOCATIONS
ADJUSTMENT OF UTILITY FACILITIES
E. FIFTH STREET AND LINEAR PARK DITCH
TO WASTE WATER TREATMENT PLANT**

AGREEMENT FOR THE ADJUSTMENT
OF UTILITY FACILITIES

THIS AGREEMENT, made and entered into this ____ day of _____, 20____, by and between the STATE OF NEVADA acting by and through its DEPARTMENT OF TRANSPORTATION, hereinafter referred to as STATE, and CARSON CITY, a consolidated municipality under Nevada Revised Statutes, whose mailing address is 3505 Butti Way, Carson City, Nevada 89701, hereinafter referred to as CITY.

WHEREAS, in the course of construction of Project MG-395-1(006), E.A. 71366, certain adjustments will have to be made to utility facilities operated by CITY; specifically, CITY shall adjust and/or relocate water lines, sewer lines and reclaimed water lines within the proposed Carson City Freeway corridor, Phase 2A as shown on EXHIBIT "B" at E. Fifth Street (SR-513), Linear Ditch to Butti Way. Relocations and adjustments will be performed by CITY'S contractor in accordance with CITY'S plans and specifications as provided to the STATE for approval.

WHEREAS, CITY has established its compensable interests in and to a portion of the facilities needing adjustment as set forth in the prior rights attached and referenced hereto as EXHIBIT "C", and made a part hereof and CITY has established its reimbursable and non-reimbursable costs in and to the those portions of the facilities needing adjustment as set forth in the cost estimate attached and referenced hereto as EXHIBIT "A", and made a part hereof.

WHEREAS, STATE has authorized CITY to incur engineering costs related to the utility relocations required for the construction of US-395 in a letter dated October 30, 1996, attached hereto as EXHIBIT "D".

NOW, THEREFORE, STATE and COMPANY hereby agree as follows:

1. When CITY has been authorized, by STATE, in writing, to proceed with the adjustments by STATE, and CITY has notified STATE'S designated inspector, as required in Paragraph 9 hereof. CITY shall cause the necessary adjustments to be performed in accordance with the drawings attached and referenced hereto as EXHIBIT "B" and made a part hereof. Said adjustments will be performed in accordance with the provisions of 23 CFR 645 Subpart A of the U.S. Department of Transportation, Federal Highway Administration, hereinafter referred to as 23 CFR 645 Subpart A, said federal regulations being incorporated by reference. Adjustments shall be completed by September 14, 2007.

2. The adjustments to CITY 'S facilities will be performed by CITY using its own construction and/or maintenance personnel at its standard wages and working conditions and hours in accordance with the agreements CITY has with its employees or, the work shall be performed by a continuing contractor in accordance with provisions of an existing written continuing contract with CITY or, the work may be performed by a contractor subject to the written approval of STATE, hired in accordance with CITY 'S established procedures.

3. The parties hereto recognize CITY is a self-insured entity and the CITY hereby agrees to fully exonerate, indemnify, defend and hold harmless the State of Nevada and its departments, divisions, agencies, officers or employees from and against all claims of actions, and all expenses incidental to the defense of any such claims or actions, based upon or arising out of damage or injury (including death) to persons or property due to any error, negligence, omission or act of the CITY or any person employed by CITY or, any others for whose acts the CITY is legally liable. The sums shall include in the event of any actions, the amount of the judgment, court costs, expenses of litigation, expert witness fees and reasonable attorney's fees.

STATE hereby agrees to fully exonerate, indemnify, defend and hold harmless the CITY and its departments, divisions, agencies, officers or employees from and against all claims of actions, and all expenses incidental to the defense of any such claims or actions, based upon or arising out of damage or injury (including death) to persons or property due to any error, negligence, omission or act of the STATE or any person employed by STATE or, any others for whose acts the STATE is legally liable. The sums shall include in the event of any actions, the amount of the judgment, court costs, expenses of litigation, expert witness fees and reasonable attorney's fees.

4. Should CITY elect to utilize an outside contractor to perform any or all of the adjustments necessary within the work-site, CITY shall require said contractor to list STATE as an additional insured on contractor's liability insurance, and provide STATE with an endorsement and a certificate of insurance. The outside contractor shall furnish the STATE with an Insurance Policy Endorsement and Certificate of Liability and Property Damage Insurance with a single limit of One Million Dollars (\$1,000,000.00) naming the STATE as an additional insured and shall maintain such insurance for the entire period during which the outside contractor shall occupy and or conduct excavation, construction and or installation activities within the STATE'S right-of-way.

The INSURANCE policies shall include a provision requiring a thirty-day (30) advance written notice of any modification or cancellation of said policies. The insurance provider shall furnish the STATE with Insurance Policy Endorsements, Declaration Page and Certificates of Insurance, evidencing such insurance prior to commencement of work, excavation, construction, and installation or, occupancy of said right-of-way. The STATE, CITY and the outside contractor agree that the cost of this insurance coverage shall be borne entirely by the CITY or the outside contractor and shall not be charged to the STATE. All insurance policies shall be with a company having an A.M. Best and Company, Inc. policyholder rating of A-VII or better. This insurance policy shall remain in full force and effect until one year after the outside contractor's completion of work, including but not limited to excavation, construction and installation activities upon and or cessation of the CITY occupancy of the STATE'S right-of-way under this Agreement.

5. The total estimated cost for performing these adjustments is SIX MILLION FOUR HUNDRED FOUR THOUSAND SIX HUNDRED SIXTY EIGHT AND NO/100 DOLLARS (\$6,404,668.00) of which, TWO MILLION NINE HUNDRED TWENTY EIGHT THOUSAND FOUR HUNDRED FIFTY SIX AND 53/100 DOLLARS (\$2,928,456.53) is eligible for reimbursement. ZERO DOLLARS (\$-0-) is attributable to salvage credits and THREE MILLION FOUR HUNDRED SEVENTY SIX THOUSAND TWO HUNDRED ELEVEN AND 47/100 DOLLARS (\$3,476,211.47) is attributable to voluntary betterments undertake by CITY. Details of the estimated costs are set forth in said EXHIBIT "A" attached hereto and made a part hereof.

The authorized consultant and CITY employee engineering and CITY employee construction management costs, hereinafter referred to as Engineering Costs for this portion of Phase 2 (hereinafter referred to as Phase 2A) US-395 utility relocations are estimated and included in EXHIBIT "A" and will be billed in accordance of paragraph seven (7) below. As provided for in NAC 408.331, section 3, it is mutually understood that actual engineering costs are so intermingled between Phase 2A and Phase 2B that final Engineering Costs cannot be determined until all Phase 2 relocations are complete and the reimbursable and non reimbursable Engineering Costs are determined on a pro rata basis of the actual construction costs.

6. The parties designate that the method of developing the adjustment costs shall be actual direct and related indirect costs to be accumulated in accordance with an approved work order accounting system or procedure prescribed by the applicable Federal or State regulatory body in accordance with the provisions of 23 CFR 645 Subpart A.

7. CITY shall submit to STATE three copies of a detailed, itemized statement showing all the costs for which CITY is claiming reimbursement. In accordance with NAC 408.379 (6), the STATE will, within 60 days after it receives a final billing from the CITY, pay the CITY an amount equal to at least ninety-five percent (95%) of the cost of the relocation. STATE shall perform the required audit and reimburse CITY for all appropriate charges in accordance with the provisions of 23 CFR 645 Subpart A. Upon receipt of the audit report, STATE shall remit payment of the remaining five percent (5%) minus any exceptions identified in the audit report. CITY shall submit monthly progress billings in addition to the final statement referenced, as the adjustment work progresses. Monthly billings shall be reimbursed by STATE, upon verification by STATE'S assigned inspector that the work has been performed and the items for which the monthly billing applies have been purchased for use on the described project. Such monthly billings shall not be held pending audit.

8. The accounts and records of CITY pertaining to the adjustments shall be subject to audit by representatives of STATE and/or the Federal Highway Administration at the earliest practicable date following STATE'S receipt of the final billing from CITY. CITY shall retain the financial records relating to the adjustments and shall make the records available for inspection by representatives of STATE and/or the Federal Highway Administration upon request during the course of the adjustments and for a period of not less than three years after CITY has received final payment.

9. CITY shall not proceed with the adjustments until it has received a "Notice to Proceed" in writing from STATE and until CITY has notified STATE'S designated inspector Marty Fink at (775) 834-8336 of the commencement date for the adjustments and/or relocation. CITY will not be reimbursed for any otherwise eligible costs which accrue in advance of its receipt of the written "Notice to Proceed" from STATE, nor for any costs incurred in the absence of the required notice to STATE'S inspector. Should the Notice To Proceed occur after October 6, 2006 the completion date defined in paragraph 1 will be extended to reflect this delay.

10. Upon completion of the above-mentioned Project, CITY and STATE shall record a Joint Use Quit Claim Agreement reflecting CITY'S and STATE'S separate and mutual rights with the appropriate descriptions contained therein for CITY'S areas that had a prior right.

11. CITY shall not pass over or through the freeway access control fence for purposes of maintenance, repair, replacement, inspection or operation of its facilities and shall instead achieve access from freeway interchanges, frontage roads, cross streets or other access roads. Access is not permitted from the freeway corridor or ramps.

12. Notwithstanding the provisions of Paragraph 11 above, in the case of extreme emergency involving CITY'S facilities, CITY may, with the prior approval of STATE'S district engineers, have reasonable use of the freeway for performing emergency maintenance.

13. The laws of the State of Nevada shall be applied in interpreting and construing this agreement.

EXHIBIT "A"

CARSON CITY FREEWAY PHASE 2A UTILITY RELOCATIONS

E. FIFTH STREET WATER, SEWER AND RECLAIMED WATER RELOCATIONS

CONSTRUCTION PACKAGES AND ELEMENTS	ENGINEER'S ESTIMATE OF PROBABLE CONSTRUCTION COST											
	CARSON CITY COSTS					ROOT REIMBURSEMENT					CONTRACT TOTAL	
	SEWER	WATER	TOTAL	SEWER	WATER	TOTAL	SEWER	WATER	TOTAL	SEWER	WATER	TOTAL
E. FIFTH STREET WATER, SEWER AND RECLAIMED WATER RELOCATIONS												
SCHEDULE A.1 LINEAR DITCH TO WASTE WATER TREATMENT PLANT SANITARY SEWER	\$ 359,844.47	\$ -	\$ 359,844.47	\$ 1,701,983.53	\$ -	\$ 1,701,983.53	\$ -	\$ -	\$ 1,701,983.53	\$ 2,060,808.00	\$ -	\$ 2,060,808.00
SCHEDULE A.2 LINEAR DITCH RECLAIMED WATER MAIN	\$ -	\$ -	\$ -	\$ 387,060.00	\$ -	\$ 387,060.00	\$ -	\$ -	\$ 387,060.00	\$ 387,060.00	\$ -	\$ 387,060.00
SCHEDULE B.1 E. FIFTH STREET WEST OF FREEWAY AND E. FIFTH STREET TO LINEAR DITCH SANITARY SEWER	\$ 937,430.00	\$ -	\$ 937,430.00	\$ -	\$ -	\$ -	\$ -	\$ -	\$ -	\$ 937,430.00	\$ -	\$ 937,430.00
SCHEDULE B.2 SANITARY SERVICE TO 3401 E FIFTH STREET	\$ 48,300.00	\$ -	\$ 48,300.00	\$ -	\$ -	\$ -	\$ -	\$ -	\$ -	\$ 48,300.00	\$ -	\$ 48,300.00
SCHEDULE C FREEWAY IRRIGATION SERVICE BTUBS	\$ -	\$ -	\$ -	\$ -	\$ 17,840.00	\$ 17,840.00	\$ -	\$ -	\$ 17,840.00	\$ -	\$ -	\$ 17,840.00
SCHEDULE D E. FIFTH STREET WATER MAIN	\$ -	\$ 1,172,230.00	\$ 1,172,230.00	\$ -	\$ -	\$ -	\$ -	\$ -	\$ -	\$ -	\$ 1,172,230.00	\$ 1,172,230.00
CONTRACT TOTALS	\$ 1,344,574.47	\$ 1,172,230.00	\$ 2,516,804.47	\$ 2,089,033.53	\$ 17,840.00	\$ 2,106,873.53	\$ 3,433,938.00	\$ 1,190,070.00	\$ 4,623,908.00	\$ -	\$ -	\$ 4,623,908.00

CONSTRUCTION PACKAGES AND ELEMENTS	ESTIMATE OF TOTAL PROJECT COSTS											
	CARSON CITY COSTS					ROOT REIMBURSEMENT					PROJECT TOTAL	
	SEWER	WATER	TOTAL	SEWER	WATER	TOTAL	SEWER	WATER	TOTAL	SEWER	WATER	TOTAL
E. FIFTH STREET WATER, SEWER AND RECLAIMED WATER RELOCATIONS												
SCHEDULE A.1 LINEAR DITCH TO WASTE WATER TREATMENT PLANT SANITARY SEWER	\$ 489,281.47	\$ -	\$ 489,281.47	\$ 2,380,459.53	\$ -	\$ 2,380,459.53	\$ -	\$ -	\$ 2,380,459.53	\$ 2,868,708.00	\$ -	\$ 2,868,708.00
SCHEDULE A.2 LINEAR DITCH RECLAIMED WATER MAIN	\$ -	\$ -	\$ -	\$ 554,300.00	\$ -	\$ 554,300.00	\$ -	\$ -	\$ 554,300.00	\$ 554,300.00	\$ -	\$ 554,300.00
SCHEDULE B.1 E. FIFTH STREET WEST OF FREEWAY AND E. FIFTH STREET TO LINEAR DITCH SANITARY SEWER	\$ 1,290,230.00	\$ -	\$ 1,290,230.00	\$ -	\$ -	\$ -	\$ -	\$ -	\$ -	\$ 1,290,230.00	\$ -	\$ 1,290,230.00
SCHEDULE B.2 SANITARY SERVICE TO 3401 E FIFTH STREET	\$ 66,400.00	\$ -	\$ 66,400.00	\$ -	\$ -	\$ -	\$ -	\$ -	\$ -	\$ 66,400.00	\$ -	\$ 66,400.00
SCHEDULE C FREEWAY IRRIGATION SERVICE BTUBS	\$ -	\$ -	\$ -	\$ -	\$ 24,540.00	\$ 24,540.00	\$ -	\$ -	\$ 24,540.00	\$ -	\$ -	\$ 24,540.00
SCHEDULE D E. FIFTH STREET WATER MAIN	\$ 1,817,330.00	\$ 1,817,330.00	\$ 3,634,660.00	\$ -	\$ -	\$ -	\$ -	\$ -	\$ -	\$ -	\$ 1,817,330.00	\$ 3,634,660.00
PROJECT TOTALS	\$ 1,850,851.47	\$ 1,817,330.00	\$ 3,668,181.47	\$ 2,934,819.53	\$ 24,540.00	\$ 2,959,359.53	\$ 4,782,938.00	\$ 1,641,970.00	\$ 6,414,288.00	\$ -	\$ -	\$ 6,414,288.00

3,476,211.47

2,928,456.53

6,404,668.00

CARBON CITY FREEWAY PHASE 2A UTILITY RELOCATIONS
5. FIFTH STREET WATER, SEWER AND RECLAIMED WATER RELOCATIONS
SCHEDULE A.1
LINEAR DITCH TO WASTE WATER TREATMENT PLANT SANITARY SEWER
ENGINEER'S ESTIMATE OF PROBABLE CONSTRUCTION COST AND ESTIMATE OF REMAINABLE COSTS

DESCRIPTION	SCHEDULED VALUE	UNIT	UNIT COST	CARBON CITY RETIREMENT		NDOT PARTICIPATING		TOTAL COST
				SCHEDULED VALUE	TOTAL COST	SCHEDULED VALUE	TOTAL COST	
1) Manhole Rehabilitation and Cleanup for Structure	1	Lump Sum	\$200,000.00	0.17	\$34,000.00	0.83	\$170,000.00	\$200,000.00
2) Install Temporary Construction Fence	5493	Linear Foot	\$8.00	667.35	\$5,338.80	4544.65	\$15,653.85	\$16,000.00
3) 10 inch PVC BDR35 Sanitary Sewer Main in NDOT ROW	86	Linear Foot	\$200.00	1.48	\$2,998.00	54.52	\$10,904.00	\$13,200.00
4) 18 inch PVC BDR35 Sanitary Sewer Main in City ROW	28	Linear Foot	\$310.00	4.52	\$9,048.00	21.48	\$4,510.00	\$5,460.00
5) 24 inch PVC BDR35 Sanitary Sewer Main in City ROW	154	Linear Foot	\$578.00	28.80	\$7,370.00	127.20	\$42,390.00	\$42,390.00
6) 30 inch PVC BDR35 Sanitary Sewer Main in City ROW	68	Linear Foot	\$300.00	8.05	\$2,715.00	42.95	\$12,885.00	\$15,600.00
7) 36 inch PVC BDR35 Sanitary Sewer Main in City ROW	2370	Linear Foot	\$510.00	412.38	\$1,27,937.00	1,957.62	\$600,862.00	\$728,799.00
8) 36 inch PVC BDR35 Sanitary Sewer Main in NDOT ROW	1101	Linear Foot	\$395.00	191.57	\$62,260.26	909.43	\$354,564.72	\$416,825.00
9) 22 inch x 34 inch Horizontal Elliptical Reinforced Concrete Pipe Class IV Sewer Main in NDOT ROW	384	Linear Foot	\$380.00	61.80	\$21,480.00	322.20	\$122,340.00	\$143,820.00
10) 34 inch DIA. 308 inch Plain Steel Casing	300	Linear Foot	\$550.00	50.20	\$13,050.00	247.80	\$1,091,000.00	\$1,200,000.00
11) 40 inch Precast Sanitary Sewer Manhole	1	Each	\$3,000.00	0.17	\$310.00	0.83	\$2,690.00	\$3,000.00
12) 60 inch Precast Sanitary Sewer Manhole	2	Each	\$8,000.00	0.25	\$2,100.00	1.75	\$2,900.00	\$3,000.00
13) 72 inch Precast Sanitary Sewer Manhole	15	Each	\$7,000.00	9.61	\$18,270.00	12.39	\$86,730.00	\$120,000.00
14) Special Junction Chamber	2	Each	\$10,000.00	0.35	\$3,300.00	1.65	\$15,400.00	\$20,000.00
15) 36 inch Ring	1	Each	\$1,000.00	0.17	\$170.00	0.83	\$830.00	\$1,000.00
16) Catch Basin	12	Each	\$1,000.00	0.09	\$2,054.00	9.91	\$13,874.00	\$16,000.00
17) 24 inch DIP (Pressure Class 24) Reinforced Water Line	1	Lump Sum	\$20,000.00	0.17	\$3,400.00	0.83	\$16,600.00	\$20,000.00
18) Permanent Maintenance Access Road	1425	Linear Foot	\$8.00	259.17	\$4,278.53	1,201.83	\$10,414.47	\$13,000.00
19) Remove Manhole and Base	9	Each	\$1,000.00	1.57	\$1,570.00	7.43	\$7,430.00	\$10,000.00
20) Cut, Plug and Blurry FR Sewer Main (6 inch PVC)	853	Linear Foot	\$4.00	180.80	\$6,842.40	762.20	\$3,046.80	\$3,840.00
21) Cut, Plug and Blurry FR Sewer Main (8 inch Sewer)	180	Linear Foot	\$4.00	33.00	\$132.00	146.94	\$627.76	\$760.00
22) Cut, Plug and Blurry FR Sewer Main (27 inch Main)	1410	Linear Foot	\$60.00	264.34	\$19,027.20	1,144.66	\$68,174.80	\$112,000.00
23) Selective Removal of Existing 27 inch ACP Pipe	1828	Linear Foot	\$60.00	895.87	\$19,892.20	1,262.13	\$75,287.80	\$91,880.00
24) Selective Removal of Existing 37 inch HCP Pipe	300	Linear Foot	\$38.00	34.80	\$1,310.00	165.20	\$5,762.00	\$7,000.00
25) Cut, Plug and Blurry FR Sewer Main (30 inch Main)	1358	Linear Foot	\$40.00	235.84	\$9,433.60	1,122.16	\$44,892.40	\$54,326.00
ENGINEER'S ESTIMATE OF PROBABLE CONSTRUCTION COST			SUBTOTAL		\$359,644.47		\$1,791,983.85	\$2,090,608.00
			TOTAL CARBON CITY COSTS:		\$359,644.47		\$1,791,983.85	\$2,090,608.00
			TOTAL NDOT COSTS:				\$1,791,983.85	\$2,090,608.00

CARSON CITY RAILWAY PROJECT UTILITY RELOCATIONS
5. FIFTH STREET WATER, SEWER AND RECLAIMED WATER RELOCATIONS
SCHEDULE A.1
LINEAR DITCH TO WASTE WATER TREATMENT PLANT SANITARY SEWER

ENGINEER'S ESTIMATE OF PROBABLE CONSTRUCTION COST AND ESTIMATE OF REIMBURSABLE COSTS

ADDITIONAL COST ASSOCIATE WITH RELOCATION

	CARSON CITY 17.4%	NDOT 82.6%	TOTAL PERCENT 100.0%
PERCENT OF ESTIMATED CONSTRUCTION CONTRACT COSTS BY AGENCY			
Mobilization, Mobilization and Cleanup is based on the estimated bid item total price multiplied by the percent indicated to the right and rounded to the nearest \$1000.			
CONTINGENCY DURING CONSTRUCTION Construction Contingency is based on Carson City experience with utility contracts. This value is the Engineer's Estimate of Probable Construction Costs * percent and rounded up to the nearest \$100.	\$35,881.00	\$175,338.00	\$208,100.00
TOTAL CONSTRUCTION COST Total construction costs. This is the sum of the Engineer's Estimate of Probable Construction Costs and Contingency during Construction.	\$184,006.47	\$1,873,202.53	\$2,056,708.00
CONSTRUCTION MANAGEMENT Construction Management is the costs associated with project supervision, and engineering required in the field.	\$39,448.00	\$187,254.00	\$226,700.00
CONSTRUCTION PROJECT TOTAL COSTS	\$433,351.47	\$2,060,456.53	\$2,493,808.00
PROJECT DESIGN ENGINEERING Design engineering cost is based on the division of the preliminary engineering contract for Carson City and as needed by estimated engineer's costs.	\$81,000.00	\$246,300.00	\$326,300.00
ESTIMATED REAL ESTATE AND EASEMENT COSTS Estimated Real Estate Permanent and Temporary Easement Costs and Costs associated with land transfers between City and NDOT. Rounded to the nearest \$100.	\$4,300.00	\$20,700.00	\$25,000.00
TOTAL PROJECT COSTS AS BASIS OF DETERMINING REIMBURSEMENT	\$483,351.47	\$2,286,708.00	\$2,770,059.47

**CARSON CITY FREEWAY PHASE 2A UTILITY RELOCATIONS
E. FIFTH STREET WATER, SEWER AND RECLAIMED WATER RELOCATIONS
SCHEDULE A.2
LINEAR DITCH RECLAIMED WATER MAIN
ENGINEER'S ESTIMATE OF PROBABLE CONSTRUCTION COST AND ESTIMATE OF REIMBURSABLE COSTS**

RECLAIMED WATER MAIN RELOCATION BETWEEN INCLUDING ABANDONMENT "FS2" 27+20 TO "FS2" 33+68

PLAN SHEETS 15E-16E AND 25 E

DESCRIPTION	SCHEDULED VALUE	UNIT	UNIT COST	TOTAL COST
A.2) Mobilization/demobilization and Cleanup for Schedule A.2	1	Lump Sum	\$38,700.00	\$38,700.00
1) 24 inch DIP (Pressure Class 250) Reclaimed Water Main in NDOT ROW	713	Linear Foot	\$320.00	\$228,160.00
2) 42 inch DIA. 3/8 inch Plate Steel Casing	360	Linear Foot	\$190.00	\$68,400.00
3) Cathodic Protection System	1	Lump Sum	\$20,000.00	\$20,000.00
4) 24 inch Butterfly Valve	2	Each	\$8,000.00	\$16,000.00
5) Reclaimed Water Main Air/Vacuum Release Assembly Complete	1	Each	\$5,000.00	\$5,000.00
6) Cut, Plug and Slurry Fill Reclaimed Water Main	360	Linear Foot	\$30.00	\$10,800.00
ENGINEER'S ESTIMATE OF PROBABLE CONSTRUCTION COST			SUBTOTAL	\$387,060.00

ADDITIONAL COST ASSOCIATED WITH RELOCATION

NOTES:

MOBILIZATION	Mobilization/demobilization and Cleanup is based on the estimated bid item total price multiplied by the percent indicated to the right and rounded to the nearest \$1000.	10%	
CONTINGENCY DURING CONSTRUCTION	Construction Contingency is based on Carson City experience with utility contracts. This value is the Engineer's Estimate of Probable Construction Costs * percent and rounded up to the nearest \$100.	10%	\$38,700.00
TOTAL CONSTRUCTION COST	Total construction costs. This is the sum of the Engineer's Estimate of Probable Construction Costs and Contingency During Construction.		\$425,760.00
CONSTRUCTION MANAGEMENT	Construction Management is the costs associated with contracted inspection, testing, supervision, and engineering services required in the field. Rounded to the nearest \$100.	10%	\$42,600.00
CONSTRUCTION PROJECT TOTAL COSTS			\$468,360.00
PROJECT DESIGN ENGINEERING	Engineering cost is based contracted and estimated engineering evaluation and design services and City in-house estimated coordination, design, and construction administration expenses for the project. Rounded to the nearest \$1000.	17%	\$66,000.00
ESTIMATED REAL ESTATE AND NONE EASEMENT COSTS			\$0.00

TOTAL PROJECT COSTS AS BASIS OF DETERMINING REIMBURSEMENT **\$534,360.00**

**CARSON CITY FREEWAY PHASE 2A UTILITY RELOCATIONS
E. FIFTH STREET WATER, SEWER AND RECLAIMED WATER RELOCATIONS
SCHEDULE B.1
E FIFTH STREET WEST OF FREEWAY AND E. FIFTH STREET TO LINEAR DITCH SANITARY SEWER
ENGINEER'S ESTIMATE OF PROBABLE CONSTRUCTION COST AND ESTIMATE OF REIMBURSABLE COSTS**

ALL SANITARY SEWER CONSTRUCTION FROM "OA1" 73+71 TO "OA1" 82+26 AND "FS3" 9+84.4 TO "FS2" 24+88, AND SEWER ABANDONMENT IN E. FIFTH STREET RIGHT OF WAY FROM "OA1" 73+71 TO "OA1" 90+03

PLAN SHEETS 3W-4W, 3E-6E, AND 22E-23E

DESCRIPTION	SCHEDULED VALUE	UNIT	UNIT COST	TOTAL COST
B.1 Mobilization/demobilization and Cleanup for Schedule B.1	1	Lump Sum	\$93,700.00	\$93,700.00
1) Install Temporary Construction Fence	1325	Linear Foot	\$10.00	\$13,250.00
2) Install Temporary Gate	1	Lump Sum	\$500.00	\$500.00
3) Selective Stump Grinding	7	Each	\$300.00	\$2,100.00
4) 24 inch PVC SDR35 Sanitary Sewer Main in City Easement	1447	Linear Foot	\$280.00	\$405,160.00
5) 24 inch PVC SDR35 Sanitary Sewer Main in NDOT ROW	888	Linear Foot	\$285.00	\$253,080.00
6) Concrete Encase Sewer Line	216	Linear Foot	\$45.00	\$9,720.00
7) Cut-Off Collar	6	Each	\$1,350.00	\$8,100.00
8) New Concentric Flat Top 60 Inch Epoxy Lined Precast Sanitary Sewer Manhole	8	Each	\$6,000.00	\$48,000.00
9) New Concentric Flat Top 72 Inch Epoxy Lined Precast Sanitary Sewer Manhole	2	Each	\$6,500.00	\$13,000.00
10) Permanent Maintenance Access Road	1460	Linear Foot	\$9.00	\$13,140.00
11) Remove Manhole and Base	5	Each	\$1,000.00	\$5,000.00
12) Cut, Plug and Slurry Fill Sewer Main (27 INCH DIA)	1712	Linear Foot	\$40.00	\$68,480.00
13) Selective Removal of Existing 27 Inch ACP Pipe	70	Linear Foot	\$60.00	\$4,200.00
ENGINEER'S ESTIMATE OF PROBABLE CONSTRUCTION COST			SUBTOTAL	\$937,430.00

ADDITIONAL COST ASSOCIATED WITH RELOCATION

NOTES:

MOBILIZATION	Mobilization/demobilization and Cleanup is based on the estimated bid item total price multiplied by the percent indicated to the right and rounded to the nearest \$1000.	10%	
CONTINGENCY DURING CONSTRUCTION	Construction Contingency is based on Carson City experience with utility contracts. This value is the Engineer's Estimate of Probable Construction Costs * percent and rounded up to the nearest \$100.	10%	\$93,700.00
TOTAL CONSTRUCTION COST	Total construction costs. This is the sum of the Engineer's Estimate of Probable Construction Costs and Contingency During Construction.		\$1,031,130.00
CONSTRUCTION MANAGEMENT	Construction Management is the costs associated with contracted inspection, testing, supervision, and engineering services required in the field. Rounded to the nearest \$100.	18%	\$103,100.00
CONSTRUCTION PROJECT TOTAL COSTS			\$1,134,230.00
PROJECT DESIGN ENGINEERING	Engineering cost is based contracted and estimated engineering evaluation and design services and City in-house estimated coordination, design, and construction administration expenses for the project. Rounded to the nearest \$1000.	17%	\$159,000.00
ESTIMATED REAL ESTATE AND EASEMENT COSTS	Easement from Lompas along the West side of the Freeway Drainage Channel.		\$0.00

**CARSON CITY FREEWAY PHASE 2A UTILITY RELOCATIONS
E. FIFTH STREET WATER, SEWER AND RECLAIMED WATER RELOCATIONS
SCHEDULE B.2
SANITARY SERVICE TO 2601 E FIFTH STREET
ENGINEER'S ESTIMATE OF PROBABLE CONSTRUCTION COST AND ESTIMATE OF REIMBURSABLE COSTS**

ALL WORK ASSOCIATED WITH THE 8" SANITARY SEWER CONSTRUCTION BETWEEN "FS1" 44+41 AND "FS1" 46+63

PLAN SHEET 3E

DESCRIPTION	SCHEDULED VALUE	UNIT	UNIT COST	TOTAL COST
B.2) Mobilization/demobilization and Cleanup for Schedule B.2	1	Lump Sum	\$4,800.00	\$4,800.00
1) 8 Inch PVC SDR35 Sanitary Sewer Main	225	Linear Foot	\$142.00	\$31,950.00
2) 18 Inch DIA. Epoxy Coated 3/8 Inch Plate Steel Casing	30	Linear Foot	\$85.00	\$2,550.00
3) Cathodic Protection System	1	LS	\$1,000.00	\$1,000.00
4) Install New Concentric Type I, 48 Inch Precast Sanitary Sewer Manhole	2	Each	\$4,000.00	\$8,000.00
ENGINEER'S ESTIMATE OF PROBABLE CONSTRUCTION COST			SUBTOTAL	\$48,300.00

ADDITIONAL COST ASSOCIATED WITH RELOCATION

NOTES:

MOBILIZATION Mobilization/demobilization and Cleanup is based on the estimated bid item total price multiplied by the percent indicated to the right and rounded to the nearest \$100. 10%

CONTINGENCY DURING CONSTRUCTION Construction Contingency is based on Carson City experience with utility contracts. This value is the Engineer's Estimate of Probable Construction Costs * percent and rounded up to the nearest \$100. 10% \$4,800.00

TOTAL CONSTRUCTION COST Total construction costs. This is the sum of the Engineer's Estimate of Probable Construction Costs and Contingency During Construction. \$53,100.00

CONSTRUCTION MANAGEMENT Construction Management is the costs associated with contracted inspection, testing, supervision, and engineering services required in the field. Rounded to the nearest \$100. 10% \$5,300.00

CONSTRUCTION PROJECT TOTAL COSTS \$58,400.00

PROJECT DESIGN ENGINEERING Engineering cost is based contracted and estimated engineering evaluation and design services and City in-house estimated coordination, design, and construction administration expenses for the project. Rounded to the nearest \$100. 17% \$8,000.00

ESTIMATED REAL ESTATE AND NONE EASEMENT COSTS \$0.00

TOTAL PROJECT COSTS AS BASIS OF DETERMINING REIMBURSEMENT \$66,400.00

**CARSON CITY FREEWAY PHASE 2A UTILITY RELOCATIONS
E. FIFTH STREET WATER, SEWER AND RECLAIMED WATER RELOCATIONS
SCHEDULE C
FREEWAY IRRIGATION SERVICE STUBS
ENGINEER'S ESTIMATE OF PROBABLE CONSTRUCTION COST AND ESTIMATE OF REIMBURSABLE COSTS**

ALL WORK ASSOCIATED WITH THE IRRIGATION SERVICES AT "OA1" 82+16 AND "OA1" 85+00

PLAN SHEET 17E

DESCRIPTION	SCHEDULED VALUE	UNIT	UNIT COST	TOTAL COST
1) Mobilization/demobilization and Cleanup for Schedule C	1	Lump Sum	\$1,700.00	\$1,700.00
2) 8 Inch PVC C900 CL 150 DR 18 Water Service in NDOT ROW (IRRIGATION)	76	Linear Foot	\$140.00	\$10,540.00
3) Permanent Flush Valve Assembly Complete	2	Each	\$2,000.00	\$4,000.00
4) 6 Inch Gate Valve	1	Each	\$1,500.00	\$1,500.00
ENGINEER'S ESTIMATE OF PROBABLE CONSTRUCTION COST			SUBTOTAL	\$17,840.00

ADDITIONAL COST ASSOCIATED WITH RELOCATION

NOTES:

MOBILIZATION Mobilization/demobilization and Cleanup is based on the estimated bid item total price multiplied by the percent indicated to the right and rounded to the nearest \$100. 10%

CONTINGENCY DURING CONSTRUCTION Construction Contingency is based on Carson City experience with utility contracts. This value is the Engineer's Estimate of Probable Construction Costs * percent and rounded up to the nearest \$100. 10% \$1,800.00

TOTAL CONSTRUCTION COST Total construction costs. This is the sum of the Engineer's Estimate of Probable Construction Costs and Contingency During Construction. \$19,640.00

CONSTRUCTION MANAGEMENT Construction Management is the costs associated with contracted inspection, testing, supervision, and engineering services required in the field. Rounded to the nearest \$100. 10% \$2,000.00

CONSTRUCTION PROJECT TOTAL COSTS \$21,640.00

PROJECT DESIGN ENGINEERING Engineering cost is based contracted and estimated engineering evaluation and design services and City in-house estimated coordination, design, and construction administration expenses for the project. Rounded to the nearest \$1000. 17% \$3,000.00

ESTIMATED REAL ESTATE AND NONE EASEMENT COSTS \$0.00

TOTAL PROJECT COSTS AS BASIS OF DETERMINING REIMBURSEMENT \$24,640.00

**CARSON CITY FREEWAY PHASE 2A UTILITY RELOCATIONS
E. FIFTH STREET WATER, SEWER AND RECLAIMED WATER RELOCATIONS**

**SCHEDULE D
E. FIFTH STREET WATER MAIN**

ENGINEER'S ESTIMATE OF PROBABLE CONSTRUCTION COST AND ESTIMATE OF REIMBURSABLE COSTS

ALL WATER MAIN CONSTRUCTION FROM "OA1" 74-89 TO "OA1" 82-25 AND "OA1" 82-12 TO "FS1" 62-22.8, EXCEPT FREEWAY IRRIGATION SERVICE AT "OA1" 85-08,
AND WATER MAIN ABANDONMENT FROM "OA1" 74-89 TO "OA1" 106-73.

PLAN SHEETS 5W-6W, 17E-21E, AND 22E-24E

DESCRIPTION	SCHEDULED VALUE	UNIT	UNIT COST	TOTAL COST
1) Mobilization/Demobilization and Cleanup for Schedule D	1	Lump Sum	\$117,200.00	\$117,200.00
2) 16 Inch DIP (Pressure Class 250) Water Main in NDOT ROW	525	Linear Foot	\$300.00	\$157,500.00
3) 16 Inch PVC C905 CL 150 DR 18 Water Main in NDOT ROW	448	Linear Foot	\$244.00	\$109,312.00
4) 16 Inch DIP (Pressure Class 250) Water Main in State Lands	185	Linear Foot	\$254.00	\$46,990.00
5) 16 Inch PVC C905 CL 150 DR 18 Water Main in State Lands	1152	Linear Foot	\$244.00	\$281,088.00
6) 30 Inch DIA. 3/8 Inch Plate Steel Casing	1106	Linear Foot	\$200.00	\$221,200.00
7) AT&T Duct Package Placement	1	Lump Sum	\$15,000.00	\$15,000.00
8) Cathodic Protection System	5	Each	\$4,000.00	\$20,000.00
9) 10 Inch PVC C900 CL 150 DR 18 Fire Line with 10 Inch Gate Valve	1	Lump Sum	\$8,000.00	\$8,000.00
10) 16 Inch Gate Valve	7	Each	\$7,500.00	\$52,500.00
11) 16 Inch x 16 Inch Tapping Sleeve for ACP and Tapping Valve	1	Each	\$9,000.00	\$9,000.00
12) Water Main Air Release Assembly Complete	3	Each	\$4,500.00	\$13,500.00
13) Fire Hydrant Assembly Complete	1	Each	\$4,200.00	\$4,200.00
14) Install Line Location Riser	5	Each	\$500.00	\$2,500.00
15) Abandon Water Valve	4	Each	\$500.00	\$2,000.00
16) Cut, Plug and Slurry Fill 16 Inch Water Main	1852	Linear Foot	\$20.00	\$37,240.00
17) Selective Removal of Existing 16 Inch ACP Pipe	1500	Linear Foot	\$50.00	\$75,000.00
ENGINEER'S ESTIMATE OF PROBABLE CONSTRUCTION COST			SUBTOTAL	\$1,172,230.00

ADDITIONAL COST ASSOCIATED WITH RELOCATION

NOTES:

MOBILIZATION	Mobilization/demobilization and Cleanup is based on the estimated bid item total price multiplied by the percent indicated to the right and rounded to the nearest \$1000.	10%	
CONTINGENCY DURING CONSTRUCTION	Construction Contingency is based on Carson City experience with utility contracts. This value is the Engineer's Estimate of Probable Construction Costs * percent and rounded up to the nearest \$100.	10%	\$117,200.00
TOTAL CONSTRUCTION COST	Total construction costs. This is the sum of the Engineer's Estimate of Probable Construction Costs and Contingency During Construction.		\$1,289,430.00
CONSTRUCTION MANAGEMENT	Construction Management is the costs associated with contracted inspection, testing, supervision, and engineering services required in the field. Rounded to the nearest \$100.	10%	\$128,900.00
CONSTRUCTION PROJECT TOTAL COSTS			\$1,418,330.00
PROJECT DESIGN ENGINEERING	Engineering cost is based contracted and estimated engineering evaluation and design services and City in-house estimated coordination, design, and construction administration expenses for the project. Rounded to the nearest \$1000.	17%	\$199,000.00
ESTIMATED REAL ESTATE AND NONE EASEMENT COSTS			\$0.00

TOTAL PROJECT COSTS AS BASIS OF DETERMINING REIMBURSEMENT

\$1,617,330.00

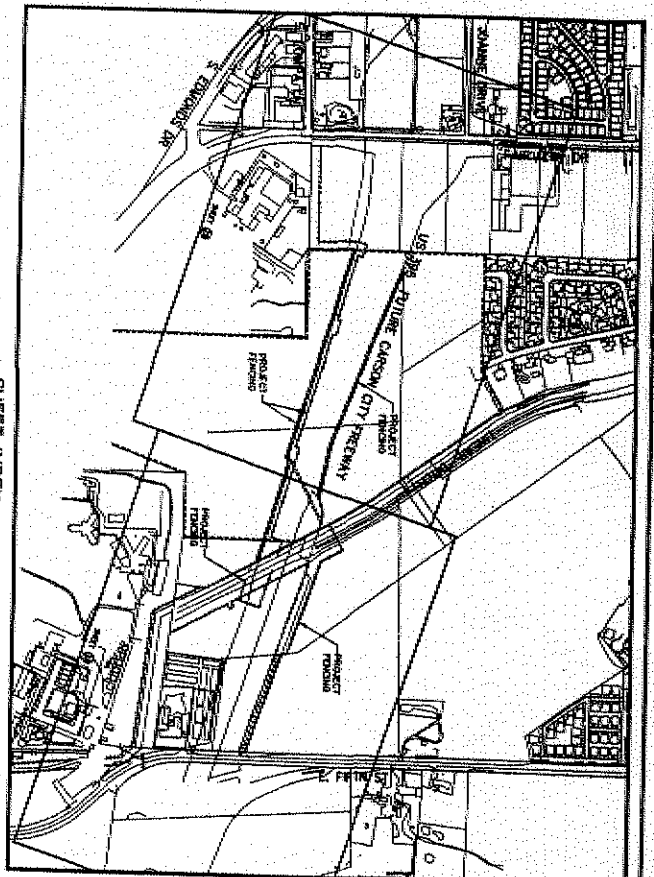

SHEET INDEX
 FOR UTILITY SHEET INDEX AND OBSERVATIONS SEE SHEET 2

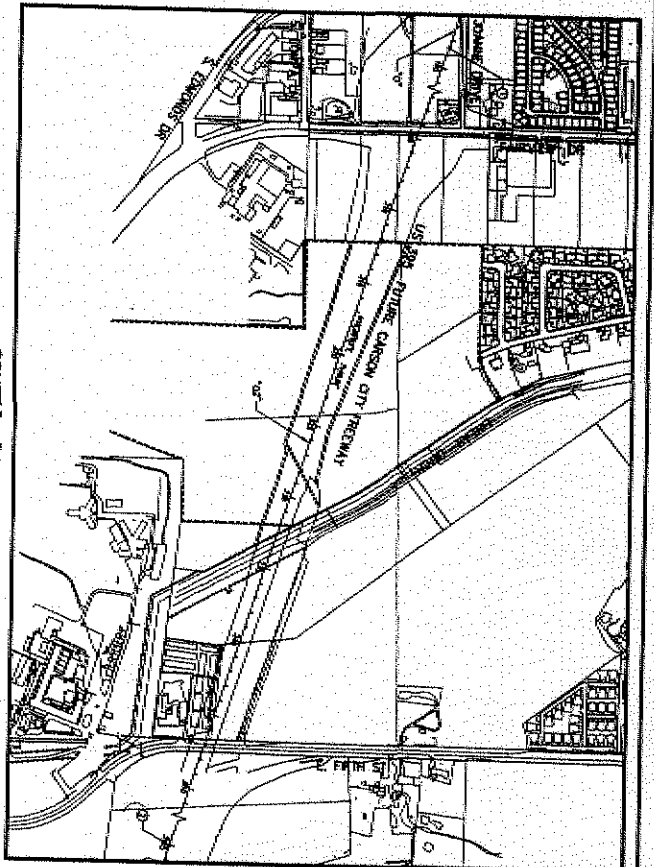

CONTROL POINTS
 FOR UTILITY CONTROL POINTS SEE SHEET 2

FOR LIST OF BEARING AND BASE OF ELEVATION SEE SHEET 2

POINT	BEARING	LENGTH	REMARKS
1	105°04'13.67"	127.00' ±	TO 105°04'13.67" AND 127.00' ±
2	112°04'13.67"	127.00' ±	TO 112°04'13.67" AND 127.00' ±

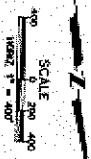
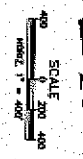

FOR INFORMATION ONLY
 NOT FOR CONSTRUCTION

**NDOT/CARSON CITY
 AGREEMENT PLANS**

**CARSON CITY FREEWAY PHASE 2A
 UTILITY RELOCATIONS**
 COLORADO ST., S. SUMNER RD., FARMER DR., LINCOLN BRCH
 PROJECT No. **02-801D**
PROJECT FENCING
 SHEET INDEX & COMMENTS

REV.	DATE	DESCRIPTION	BY	APPD

PRELIMINARY
 09/20/06

**CARSON CITY
 PUBLIC WORKS DEPARTMENT**
 2005 BUTTE WAY CARSON CITY, NEVADA 89701
 PH: 867-2335 FAX: 867-2113

**THE LOUIS BERGER
 GROUP, INC.**
 10000 W. 10TH AVENUE, SUITE 100
 DENVER, CO 80202

DESIGNED BY: JE	REVISION NO.:
DRAWN BY: JEV	CHECKED BY: JEV
DATE: 09/20/06	SCALE: AS SHOWN
PROJECT NO.:	DATE PLOTTED: 09/20/06

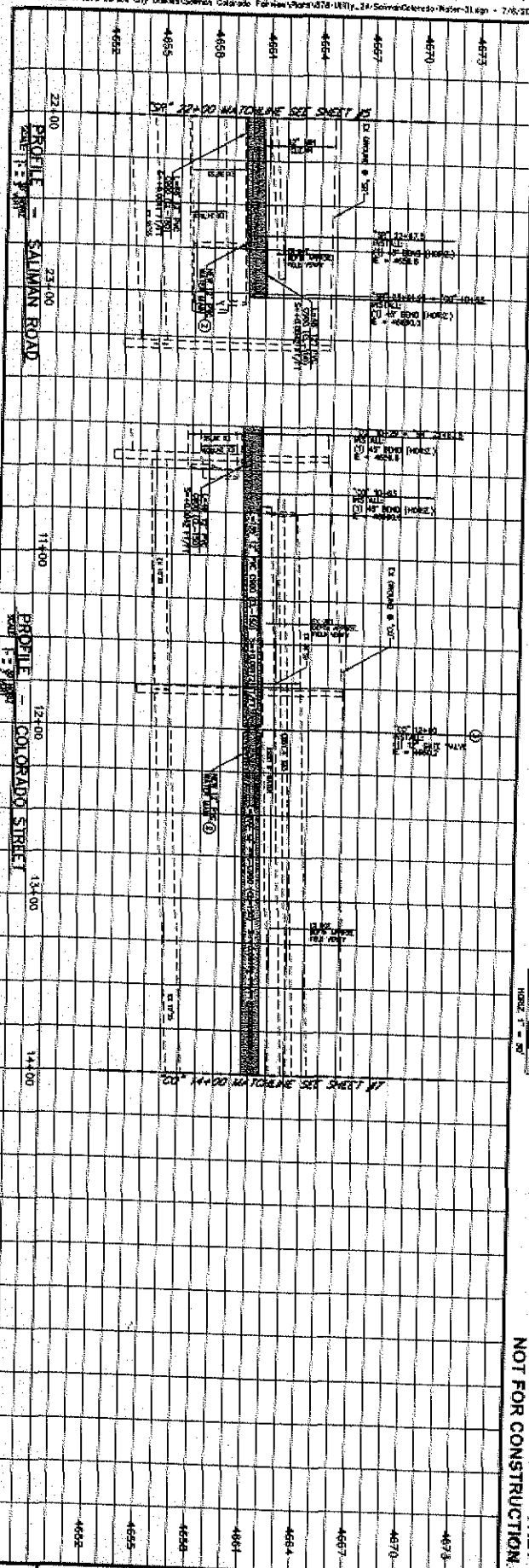

PLAN - COLORADO STREET/SALIMAN ROAD

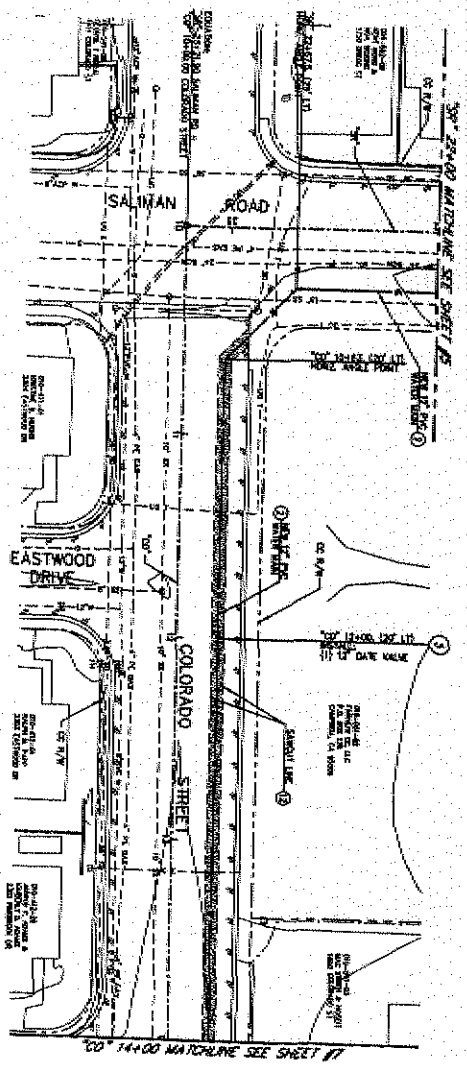

FOR INFORMATION ONLY
 NOT FOR CONSTRUCTION

**NDOT/CARSON CITY
 AGREEMENT PLANS**

- ① SEE THE PLAN FOR THE LOCATION OF THE MAIN
- ② SEE THE PLAN FOR THE LOCATION OF THE VALVE
- ③ SEE THE PLAN FOR THE LOCATION OF THE MANHOLE
- ④ SEE THE PLAN FOR THE LOCATION OF THE DATE VALVE
- ⑤ SEE THE PLAN FOR THE LOCATION OF THE DATE VALVE
- ⑥ SEE THE PLAN FOR THE LOCATION OF THE DATE VALVE
- ⑦ SEE THE PLAN FOR THE LOCATION OF THE DATE VALVE
- ⑧ SEE THE PLAN FOR THE LOCATION OF THE DATE VALVE
- ⑨ SEE THE PLAN FOR THE LOCATION OF THE DATE VALVE
- ⑩ SEE THE PLAN FOR THE LOCATION OF THE DATE VALVE

DATE: 06/20/06
 SHEET: 32

**CARSON CITY FREEWAY PHASE 2A
 UTILITY RELOCATIONS**
 COLORADO ST. S. SALIMAN RD., FARMVIEW DR./LINEAR DITCH
 PROJECT No. 00-8019
12" WATER MAIN
 "SR" 22+00 to "CO" 14+00

REV	DATE	DESCRIPTION	BY	APP'D

PRELIMINARY
 09/20/06

**CARSON CITY
 PUBLIC WORKS DEPARTMENT**
 3000 SOUTH MAIN CARSON CITY, NEVADA 89701
 PH: 867-8338 FAX: 867-2512

**THE LOUIS BERGER
 GROUP INC.**
 1100 W. WASHINGTON ST. LAS VEGAS, NV 89102
 PH: 702-735-1100 FAX: 702-735-1101

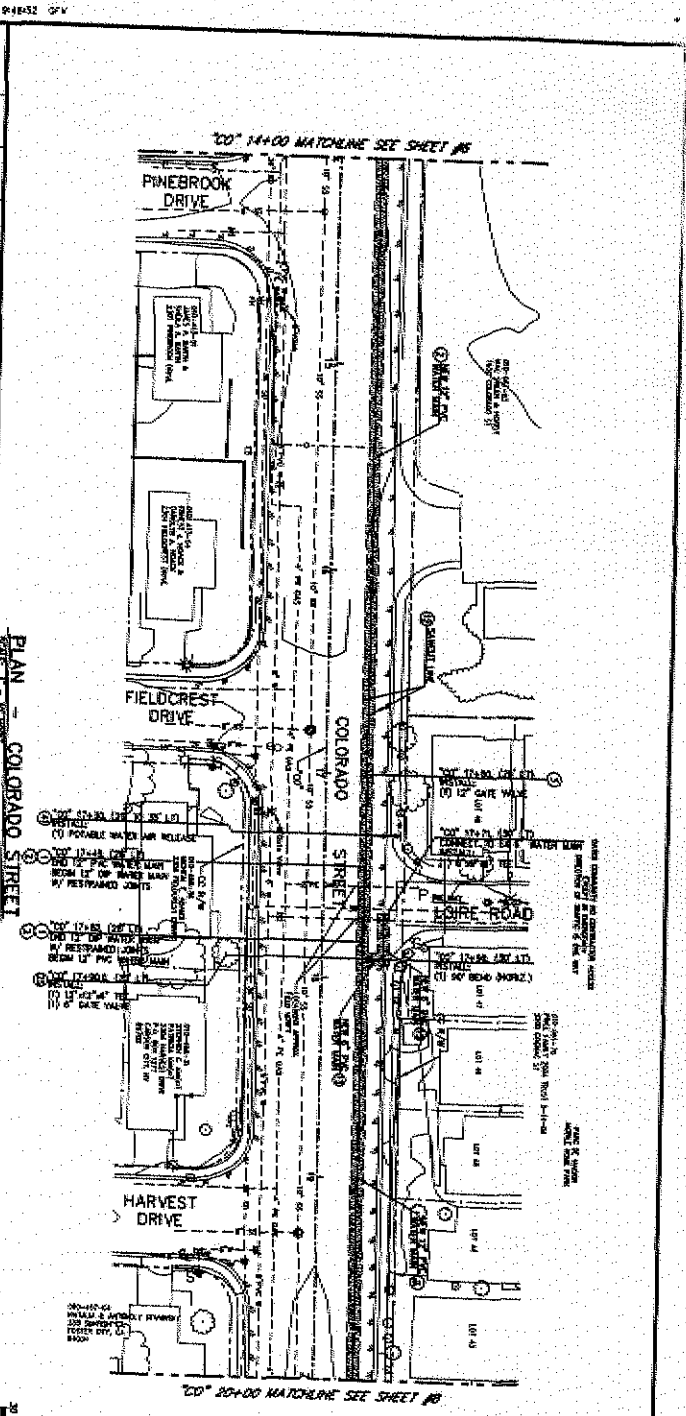
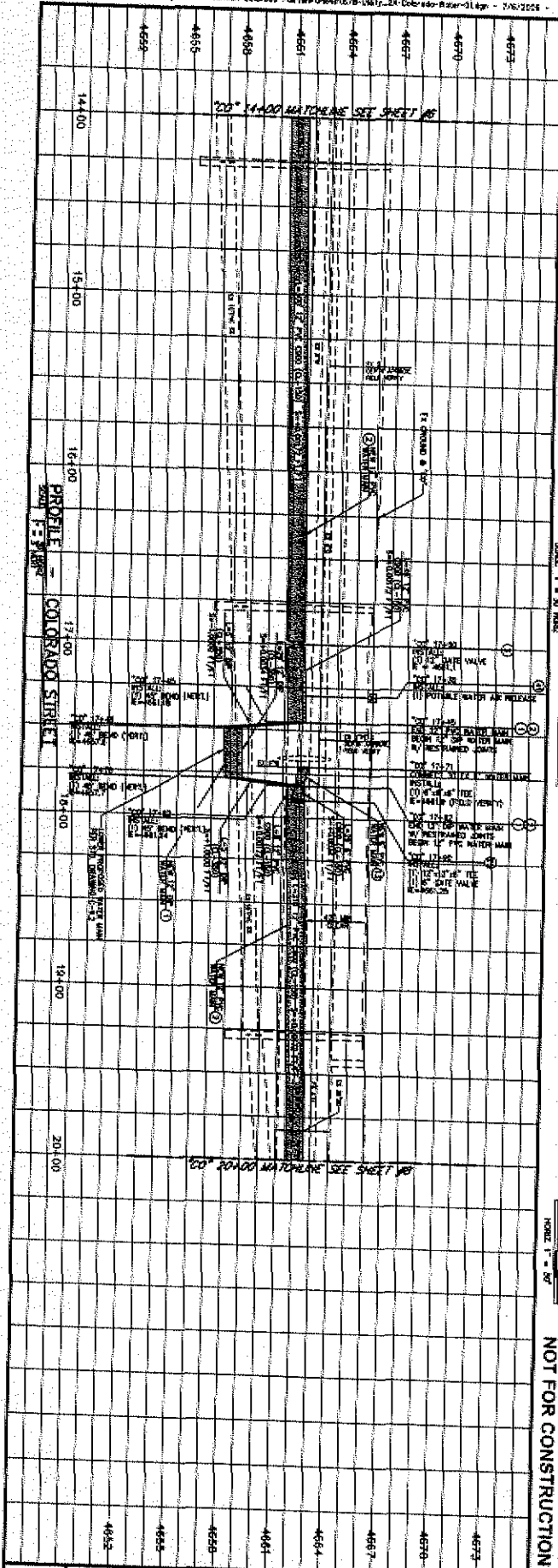

SCALE
 1" = 20'
 HORIZONTAL
 1" = 40'
 VERTICAL

**FOR INFORMATION ONLY
 NOT FOR CONSTRUCTION**

- GENERAL NOTES:**
1. REVIEW ALL PROPOSED CLASS 200 AND 150 PIPE, MANHOLES AND STRUCTURES.
 2. REVIEW ALL PROPOSED 12" WATER MAIN FOR THE DISTRICT PER (C-100 10) WATER MAIN.
 3. REVIEW ALL EXISTING AND PROPOSED UTILITY LOCATIONS.
 4. REVIEW ALL EXISTING AND PROPOSED 12" WATER MAIN FOR THE DISTRICT PER (C-100 10) WATER MAIN.
 5. REVIEW ALL EXISTING AND PROPOSED 12" WATER MAIN FOR THE DISTRICT PER (C-100 10) WATER MAIN.
 6. REVIEW ALL EXISTING AND PROPOSED 12" WATER MAIN FOR THE DISTRICT PER (C-100 10) WATER MAIN.
 7. REVIEW ALL EXISTING AND PROPOSED 12" WATER MAIN FOR THE DISTRICT PER (C-100 10) WATER MAIN.
 8. REVIEW ALL EXISTING AND PROPOSED 12" WATER MAIN FOR THE DISTRICT PER (C-100 10) WATER MAIN.
 9. REVIEW ALL EXISTING AND PROPOSED 12" WATER MAIN FOR THE DISTRICT PER (C-100 10) WATER MAIN.
 10. REVIEW ALL EXISTING AND PROPOSED 12" WATER MAIN FOR THE DISTRICT PER (C-100 10) WATER MAIN.

CARSON CITY FREEWAY PHASE 2A UTILITY RELOCATIONS COLORADO ST. S. SALMAN RD., FARMER IN/LINEAR DITCH PROJECT No. 00-8010 12" WATER MAIN "CO" 14+00 to "CO" 20+00		DESIGNED BY: JBT DRAWN BY: JBT CHECKED BY: JBT DATE: 09/20/16 SCALE: 1"=20' SHEET: 7 OF 32	PUBLIC WORKS DEPARTMENT 3300 NORTH WAY CARSON CITY, NEVADA 89701 PH: 867-3200 FAX: 867-2112	THE LOUIS BERGER GROUP INC. 10000 S. RAY BLVD. SUITE 100 LAS VEGAS, NV 89148 PH: 702-735-1000
---	--	---	---	--

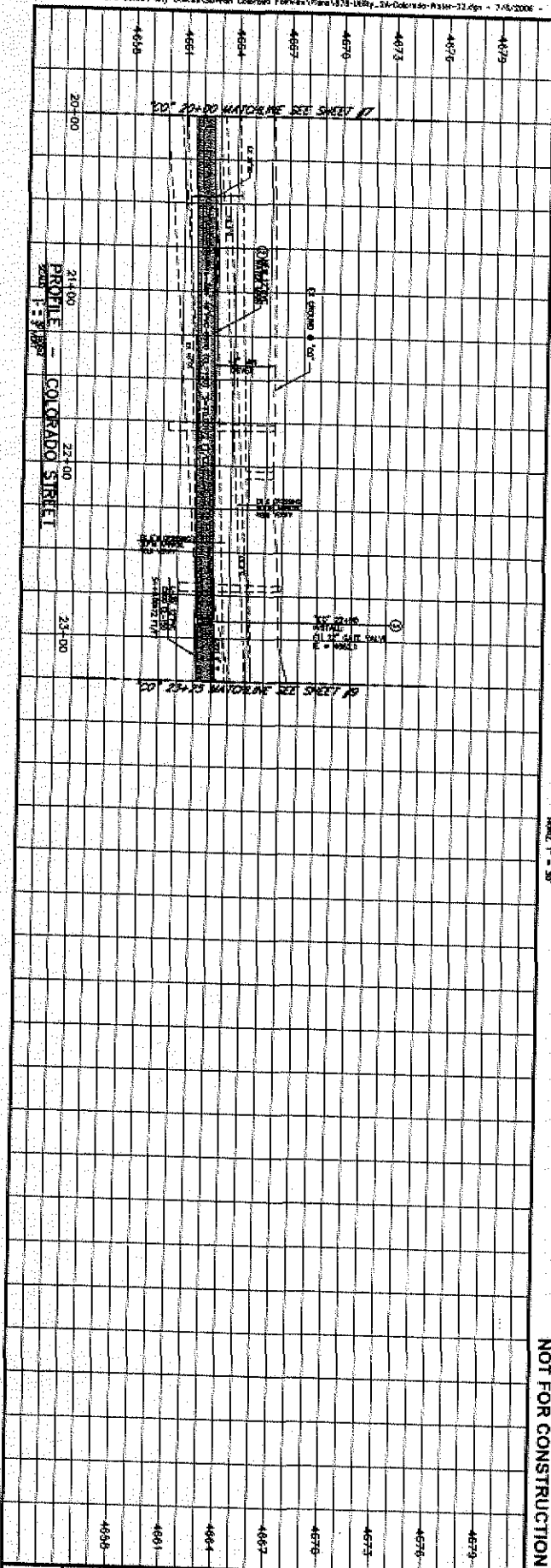

PLAN - COLORADO STREET

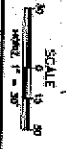
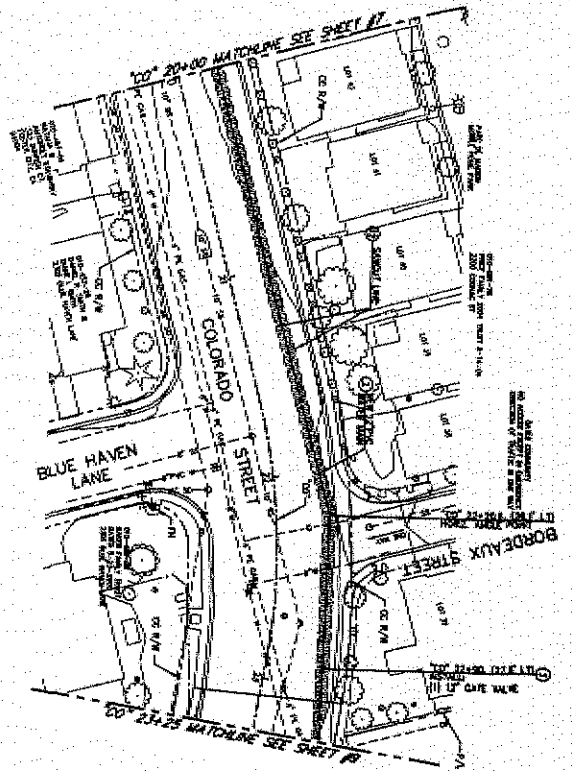

FOR INFORMATION ONLY
 NOT FOR CONSTRUCTION

NDOT/CARSON CITY
 AGREEMENT PLANS

- 1. GENERAL CONTRACTOR SHALL BE RESPONSIBLE FOR OBTAINING ALL NECESSARY PERMITS AND APPROVALS FROM ALL AFFECTED AGENCIES.
- 2. ALL UTILITIES SHOWN ARE BASED ON RECORD DRAWINGS AND FIELD SURVEY. CONTRACTOR SHALL VERIFY THE LOCATION AND DEPTH OF ALL UTILITIES PRIOR TO CONSTRUCTION.
- 3. CONTRACTOR SHALL BE RESPONSIBLE FOR PROTECTING ALL EXISTING UTILITIES AND STRUCTURES NOT SHOWN ON THESE PLANS.
- 4. ALL CONSTRUCTION SHALL BE IN ACCORDANCE WITH THE LATEST EDITIONS OF THE STANDARD SPECIFICATIONS FOR CONSTRUCTION OF PUBLIC WORKS, N.D.O.T. 2003.

CARSON CITY FREEWAY PHASE 2A
 UTILITY RELOCATIONS
 COLORADO ST., S. SALMON RD., FARMER DR., LINCOLN ST.
 PROJECT No. 00-8010
 12" WATER MAIN
 "CO" 20+00 to "CO" 23+25

REV.	DATE	DESCRIPTION	BY	APP'D

PRELIMINARY
 05/20/06

CARSON CITY
 PUBLIC WORKS DEPARTMENT
 3508 30TH WAY CARSON CITY, NEVADA 89701
 PH: 867-1528 FAX: 867-2192



DESIGNED BY: JG
 DRAWN BY: JG
 CHECKED BY: JG
 DATE: 05/20/06
 SCALE: 1"=10'

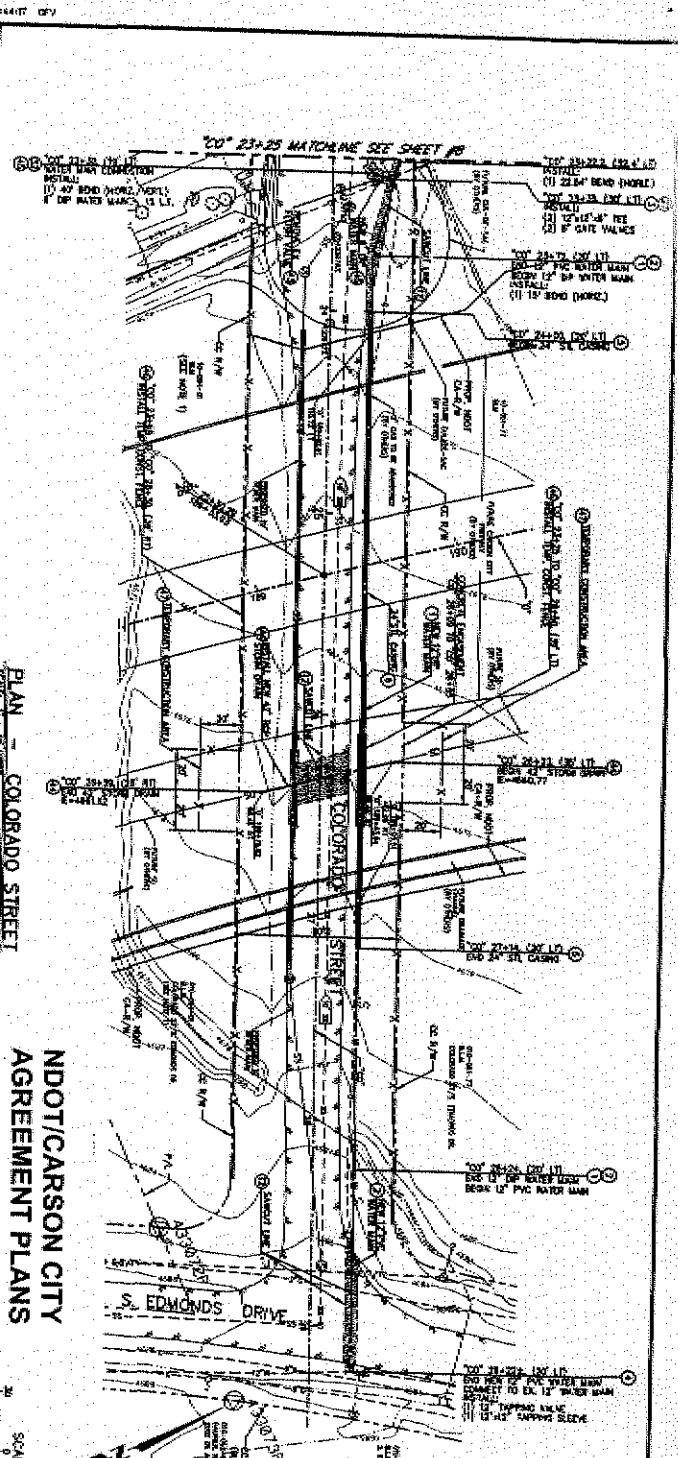
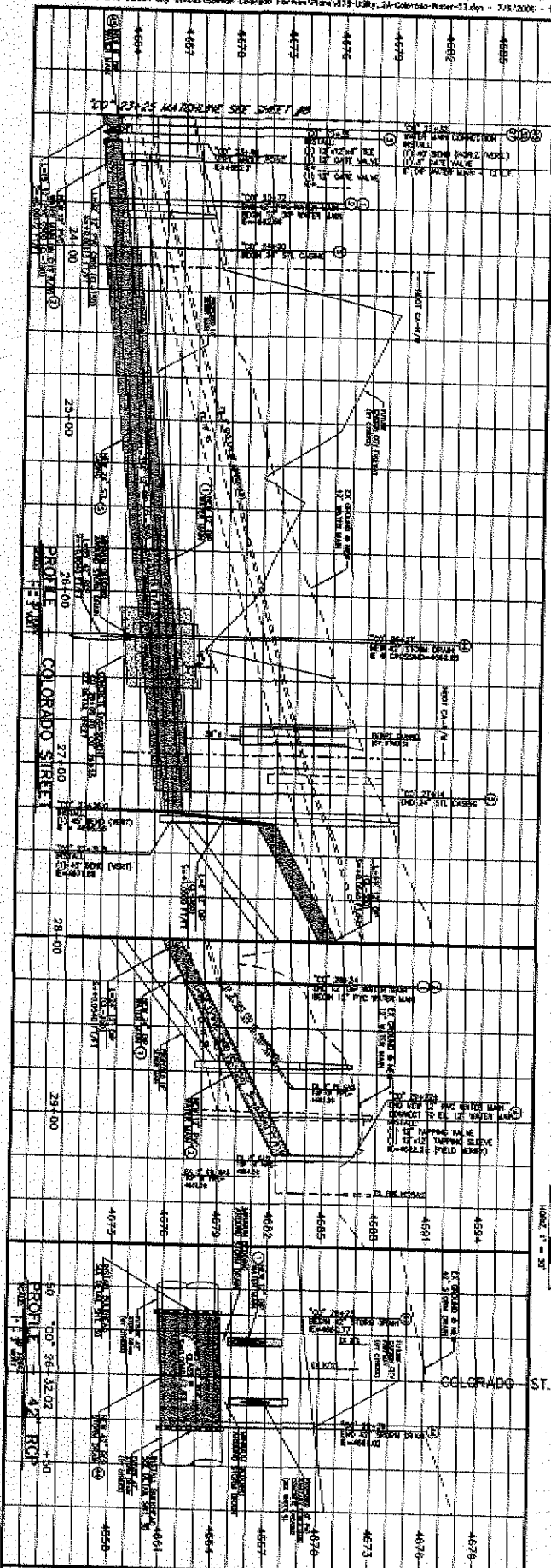

PLAN - COLORADO STREET
 NDOT/CARSON CITY
 AGREEMENT PLANS

SCALE
 1" = 30'

FOR INFORMATION ONLY
 NOT FOR CONSTRUCTION

- CONSTRUCTION NOTES:**
1. INSTALL 12" PVC WATER MAIN WITH 12" PVC VALVES AND 12" PVC FITTINGS.
 2. INSTALL 12" PVC VALVE WITH 12" PVC FITTINGS.
 3. INSTALL 12" PVC VALVE WITH 12" PVC FITTINGS.
 4. INSTALL 12" PVC VALVE WITH 12" PVC FITTINGS.
 5. INSTALL 12" PVC VALVE WITH 12" PVC FITTINGS.
 6. INSTALL 12" PVC VALVE WITH 12" PVC FITTINGS.
 7. INSTALL 12" PVC VALVE WITH 12" PVC FITTINGS.
 8. INSTALL 12" PVC VALVE WITH 12" PVC FITTINGS.
 9. INSTALL 12" PVC VALVE WITH 12" PVC FITTINGS.
 10. INSTALL 12" PVC VALVE WITH 12" PVC FITTINGS.
 11. INSTALL 12" PVC VALVE WITH 12" PVC FITTINGS.
 12. INSTALL 12" PVC VALVE WITH 12" PVC FITTINGS.
 13. INSTALL 12" PVC VALVE WITH 12" PVC FITTINGS.
 14. INSTALL 12" PVC VALVE WITH 12" PVC FITTINGS.
 15. INSTALL 12" PVC VALVE WITH 12" PVC FITTINGS.
 16. INSTALL 12" PVC VALVE WITH 12" PVC FITTINGS.
 17. INSTALL 12" PVC VALVE WITH 12" PVC FITTINGS.
 18. INSTALL 12" PVC VALVE WITH 12" PVC FITTINGS.
 19. INSTALL 12" PVC VALVE WITH 12" PVC FITTINGS.
 20. INSTALL 12" PVC VALVE WITH 12" PVC FITTINGS.

CARSON CITY FREeway PHASE 2A UTILITY RELOCATIONS COLORADO ST., S. SALAMAN RD., FARMER BL./BEAR DITCH PROJECT No. 00-8010 12" WATER MAIN "CO" 23+25 to "CO" 29+22		REV. DATE DESCRIPTION BY APP'D	PRELIMINARY 05/20/06	CARSON CITY PUBLIC WORKS DEPARTMENT 3505 NORTH EAST CARSON CITY, NEVADA 89201 P.O. BOX 2324 FAX 702-251-1111	DESIGNED BY: JGJ DRAWN BY: JGJ CHECKED BY: JGJ PWS No. 00-8010-01 SCALE: HORIZ. 1" = 30' VERT. 1" = 10'
---	--	--------------------------------	-------------------------	---	--

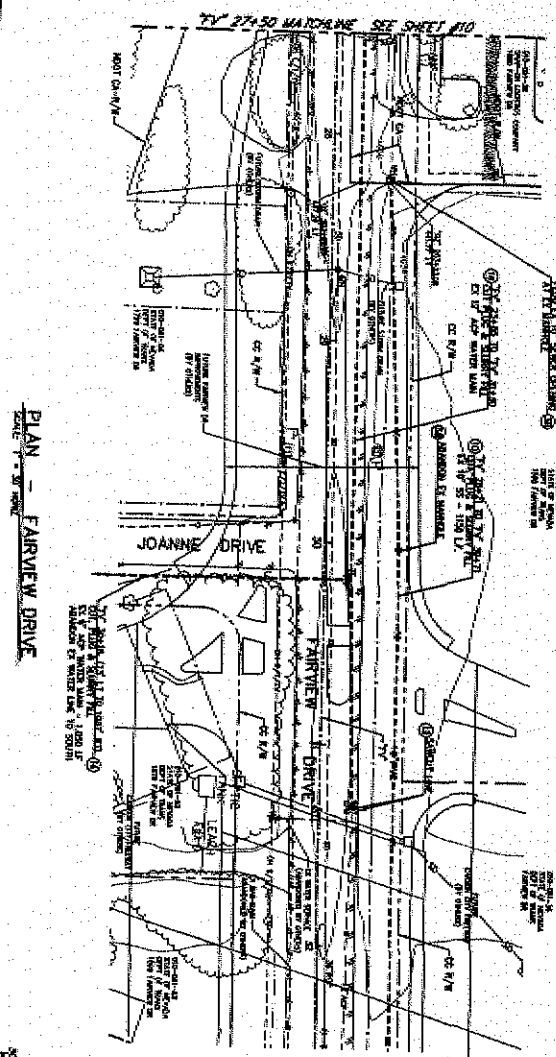
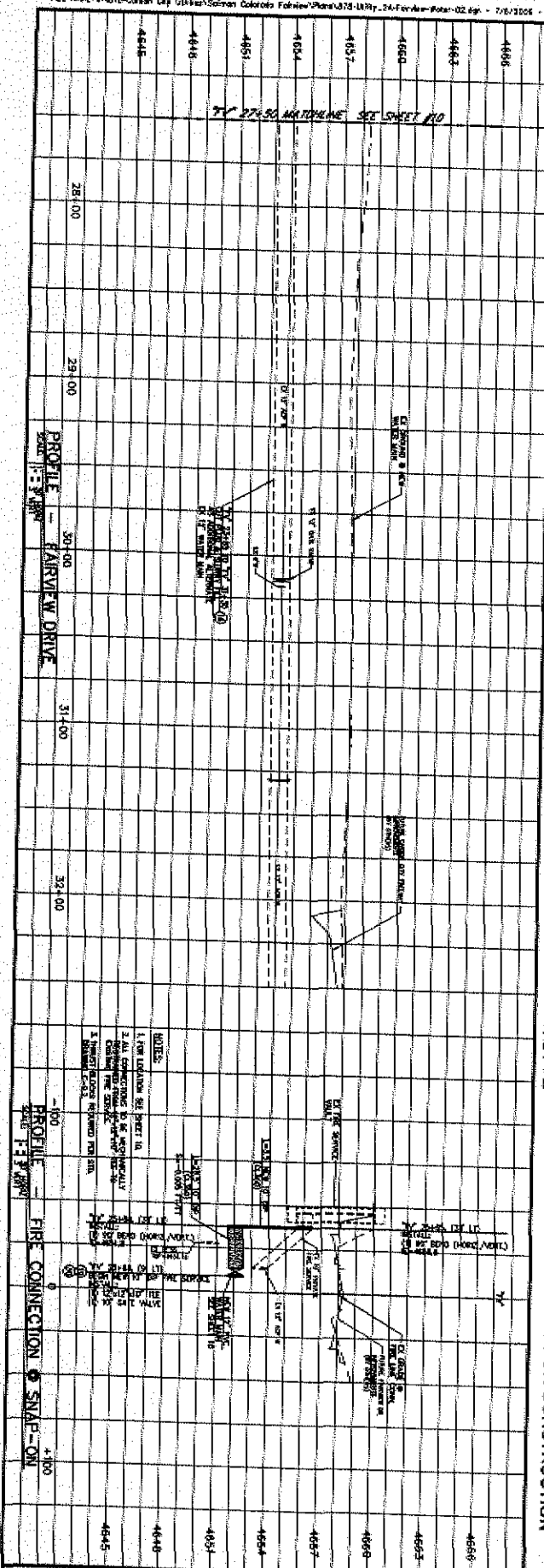

PLAN - FARVIEW DRIVE

SCALE
 1" = 20'

NDOT/CARSON CITY
 AGREEMENT PLANS
 FOR INFORMATION ONLY
 NOT FOR CONSTRUCTION

- ① ALL UTILITIES SHOWN ARE THE PROPERTY OF THE CITY OF CARSON CITY AND ARE NOT TO BE MOVED OR DELETED WITHOUT THE WRITTEN CONSENT OF THE CITY ENGINEER.
- ② ALL UTILITIES SHOWN ARE THE PROPERTY OF THE CITY OF CARSON CITY AND ARE NOT TO BE MOVED OR DELETED WITHOUT THE WRITTEN CONSENT OF THE CITY ENGINEER.
- ③ ALL UTILITIES SHOWN ARE THE PROPERTY OF THE CITY OF CARSON CITY AND ARE NOT TO BE MOVED OR DELETED WITHOUT THE WRITTEN CONSENT OF THE CITY ENGINEER.
- ④ ALL UTILITIES SHOWN ARE THE PROPERTY OF THE CITY OF CARSON CITY AND ARE NOT TO BE MOVED OR DELETED WITHOUT THE WRITTEN CONSENT OF THE CITY ENGINEER.
- ⑤ ALL UTILITIES SHOWN ARE THE PROPERTY OF THE CITY OF CARSON CITY AND ARE NOT TO BE MOVED OR DELETED WITHOUT THE WRITTEN CONSENT OF THE CITY ENGINEER.
- ⑥ ALL UTILITIES SHOWN ARE THE PROPERTY OF THE CITY OF CARSON CITY AND ARE NOT TO BE MOVED OR DELETED WITHOUT THE WRITTEN CONSENT OF THE CITY ENGINEER.
- ⑦ ALL UTILITIES SHOWN ARE THE PROPERTY OF THE CITY OF CARSON CITY AND ARE NOT TO BE MOVED OR DELETED WITHOUT THE WRITTEN CONSENT OF THE CITY ENGINEER.
- ⑧ ALL UTILITIES SHOWN ARE THE PROPERTY OF THE CITY OF CARSON CITY AND ARE NOT TO BE MOVED OR DELETED WITHOUT THE WRITTEN CONSENT OF THE CITY ENGINEER.
- ⑨ ALL UTILITIES SHOWN ARE THE PROPERTY OF THE CITY OF CARSON CITY AND ARE NOT TO BE MOVED OR DELETED WITHOUT THE WRITTEN CONSENT OF THE CITY ENGINEER.
- ⑩ ALL UTILITIES SHOWN ARE THE PROPERTY OF THE CITY OF CARSON CITY AND ARE NOT TO BE MOVED OR DELETED WITHOUT THE WRITTEN CONSENT OF THE CITY ENGINEER.

REV.	DATE	DESCRIPTION	BY	APP'D

PRELIMINARY
 09/20/06

CARSON CITY FREeway PHASE 2A
 UTILITY RELOCATIONS
 COLORADO ST., S. SALAMAN RD., FARVIEW BL./LEONARD MCH
 PROJECT No. 00-801D
 12" WATER MAIN
 "FV" 27+50 to "FV" 32+50

CARSON CITY
 PUBLIC WORKS DEPARTMENT
 2805 BIRTH HWY CARSON CITY, NEVADA 89701
 P.O. BOX 1000

THE LOUIS BERGER
 GROUP INC.
 LAS VEGAS, NEVADA

DESIGNED BY: JLN	CHECKED BY: JLN
DRAWN BY: JLN	CHECKED BY: JLN
DATE: 09/20/06	SCALE: 1" = 20'
SCALE: 1" = 20'	SCALE: 1" = 20'

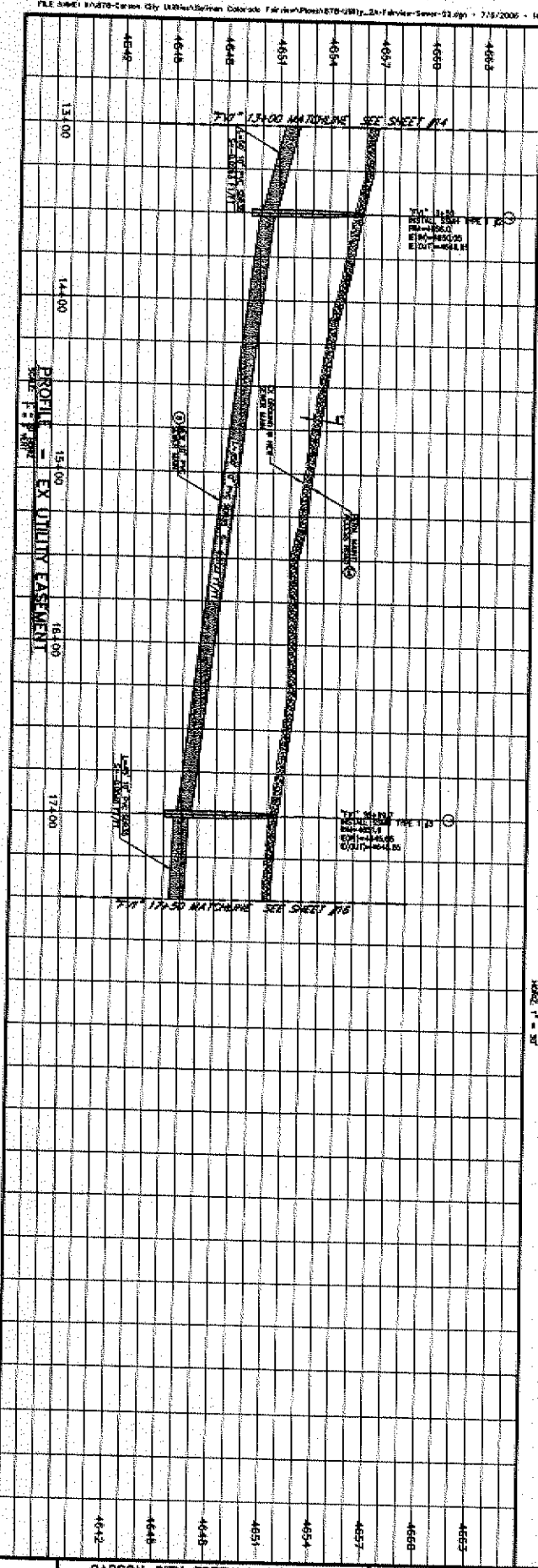

PLAN - EX UTILITY EASEMENT

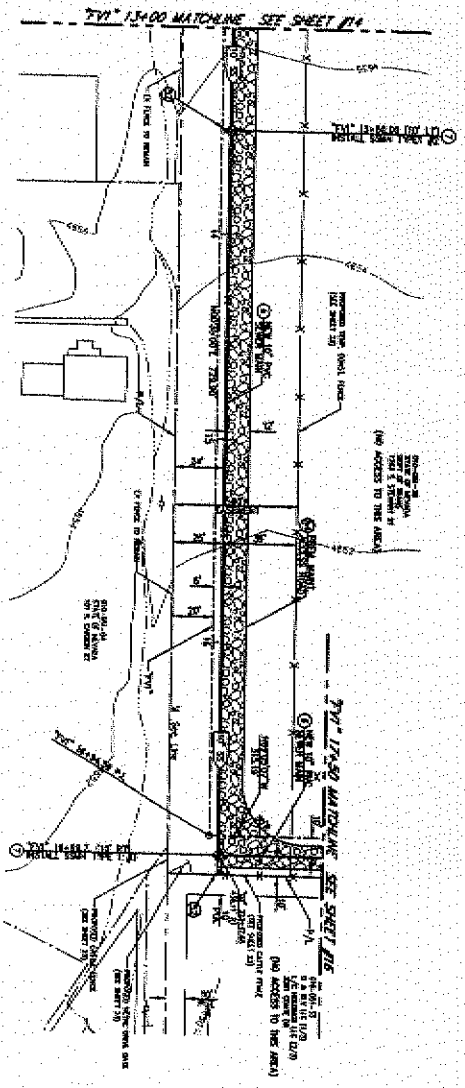

SCALE
 1" = 10'
 HORIZ. 1" = 30'

FOR INFORMATION ONLY
 NOT FOR CONSTRUCTION

**INDOT/CARSON CITY
 AGREEMENT PLANS**

- CONSTRUCTION NOTES:**
- 1. INSTALL 10" DIA. SANITARY SEWER MAIN PER STD. DRAWING C-1-A.
 - 2. INSTALL 48" DIA. MANHOLE PER STD. DRAWING C-1-E.
 - 3. INSTALL SANITARY MANHOLE PER STD. DRAWING C-1-F WITH NO. 3.
 - 4. INSTALL PROPOSED MAINTENANCE ACCESS ROAD.

**CARSON CITY FREEWAY PHASE 2A
 UTILITY RELOCATIONS**
 COLORADO ST., S. SKELMUN DR., FARVIEW DR./LINCOLN BRCH
 PROJECT No. 00-801D
 10" SANITARY SEWER MAIN
 "FV1" 13+00 TO "FV1" 17+50

REV.	DATE	DESCRIPTION	BY	APP'D

PRELIMINARY
 09/20/06

**CARSON CITY
 PUBLIC WORKS DEPARTMENT**
 3206 BATH WAY CARSON CITY, NEVADA, 89703
 PWA 967-3238 FAX 967-8112

**THE LOUIS BERGER
 GROUP, INC.**
 LAS VEGAS, NEVADA

DESIGNED BY: JLR	DRAWN BY: JLR
CHECKED BY: JLR	SCALE: 1/4" = 1'-0"
DATE: 09-20-06	SCALE: 1/4" = 1'-0"

15
 32

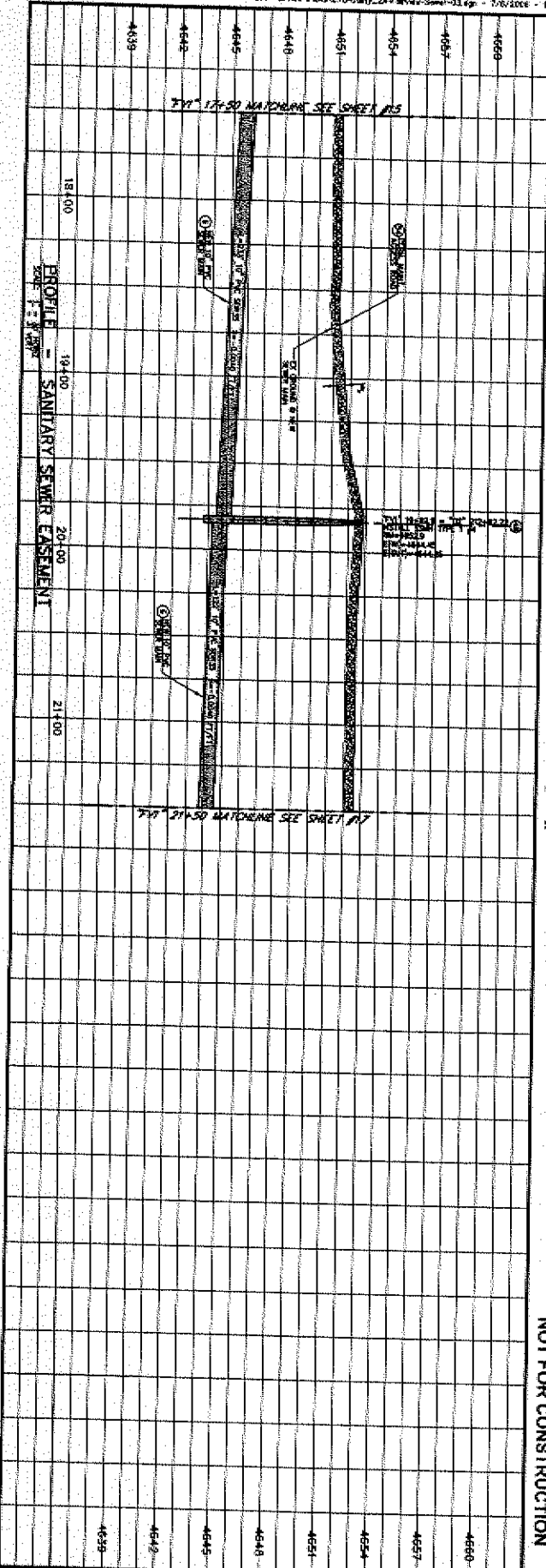

PLAN - SANITARY SEWER EASEMENT

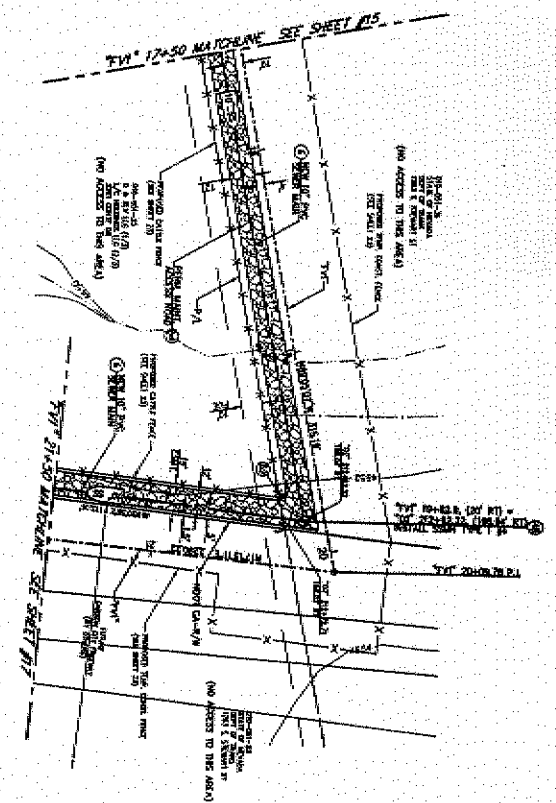

SCALE
 HORIZ. 1" = 30'
 VERT. 1" = 30'

NDOT/CARSON CITY
 AGREEMENT PLANS
 FOR INFORMATION ONLY
 NOT FOR CONSTRUCTION

- CONSTRUCTION NOTES:**
- 1. VERIFY ALL THE EXISTING RECORD PLANS FOR THE EXISTING C-11A
 - 2. VERIFY ALL THE EXISTING RECORD PLANS FOR THE EXISTING C-11A
 - 3. VERIFY ALL THE EXISTING RECORD PLANS FOR THE EXISTING C-11A
 - 4. VERIFY ALL THE EXISTING RECORD PLANS FOR THE EXISTING C-11A

CARSON CITY FREEWAY PHASE 2A
 UTILITY RELOCATIONS
 COLORADO ST., S. SKUMM DR., FAIRVIEW DR., LINDAN DRCH
 PROJECT No. 00-621R
 10" SANITARY SEWER MAIN
 "FV1" 17+50 to "FV1" 21+50

REV.	DATE	DESCRIPTION	BY	APP'D

PRELIMINARY
 09/20/06

CARSON CITY
 PUBLIC WORKS DEPARTMENT
 3000 NORTH 14TH - CARSON CITY, NEVADA 89704
 PH: 867-2250 FAX: 867-2112

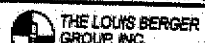

DRAWN BY: []
 CHECKED BY: []
 SCALE: []
 DATE: []

SHEET
 16
 OF
 32

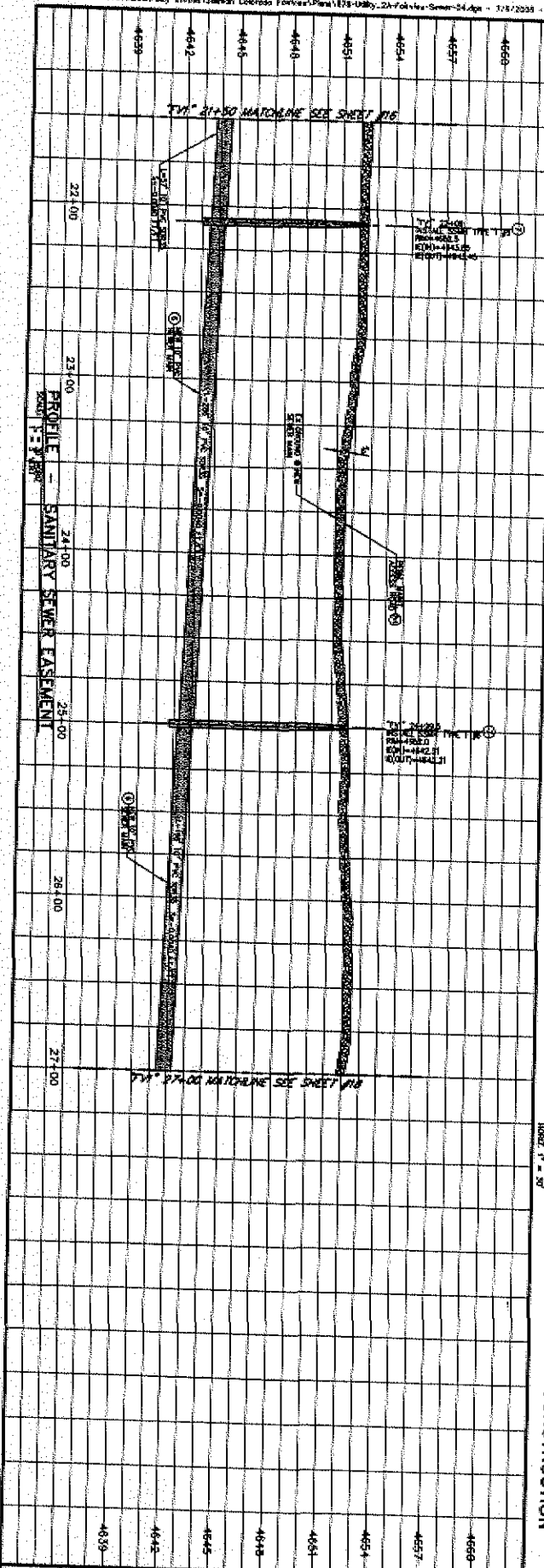

PLAN - SANITARY SEWER EASEMENT
 SCALE: 1" = 20' HORIZ

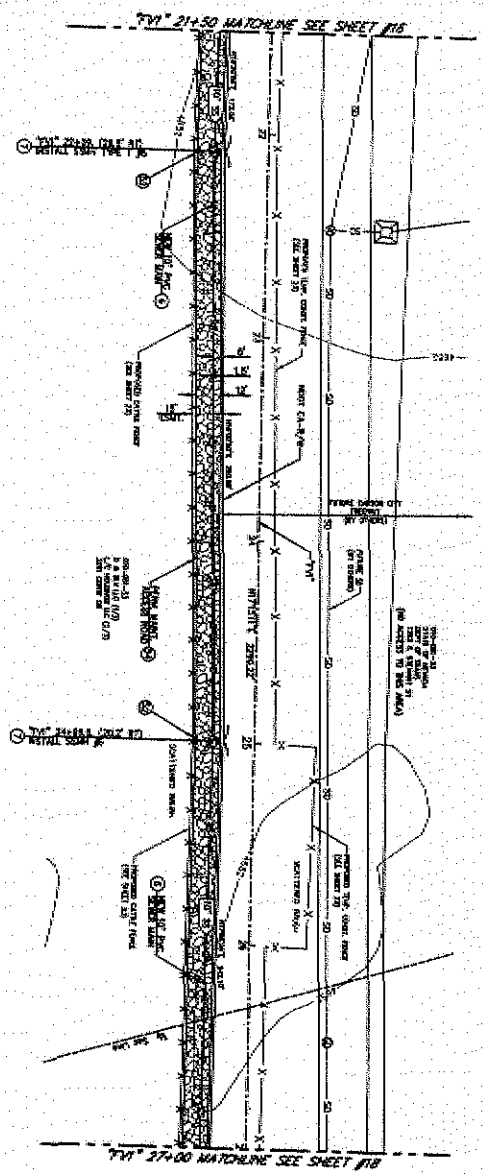

FOR INFORMATION ONLY
 NOT FOR CONSTRUCTION

NDOT/CARSON CITY
 AGREEMENT PLANS

- CONSTRUCTION NOTES:
1. PROFILE OF THE SEWER MAIN SHALL BE SET TO THE EXISTING C-114.
 2. PROFILE OF ALL MANHOLE FOR STD. DRAINING C-114.
 3. ACTUAL MANHOLE NUMBER FOR STD. DRAINING C-114 SHALL BE 1.
 4. ACTUAL EASEMENT MATCHING ACCESS ROAD.

SHEET 17
 OF 32

CARSON CITY FREEWAY PHASE 2A
 UTILITY RELOCATIONS
 COLORADO ST., S. SALAMAN RD., FARMVIEW DR., ALMENDR DITCH
 PROJECT No. 00-8210
 10" SANITARY SEWER MAIN
 "TYM" 21+50 to "TYM" 27+00

REV.	DATE	DESCRIPTION	BY	APP'D

PRELIMINARY
 09/20/06

CARSON CITY
 PUBLIC WORKS DEPARTMENT
 2005 NORTH 44TH CARSON CITY, NEVADA 89701
 FAX: 867-1238

DESIGNED BY: JES
 DRAWN BY: JES
 CHECKED BY: JES
 DATE: 09/20/06
 SCALE: 1" = 20'

THE LOUIS BERGER
 GROUP INC.
 1000 WEST 10TH AVENUE, SUITE 100
 DENVER, CO 80202

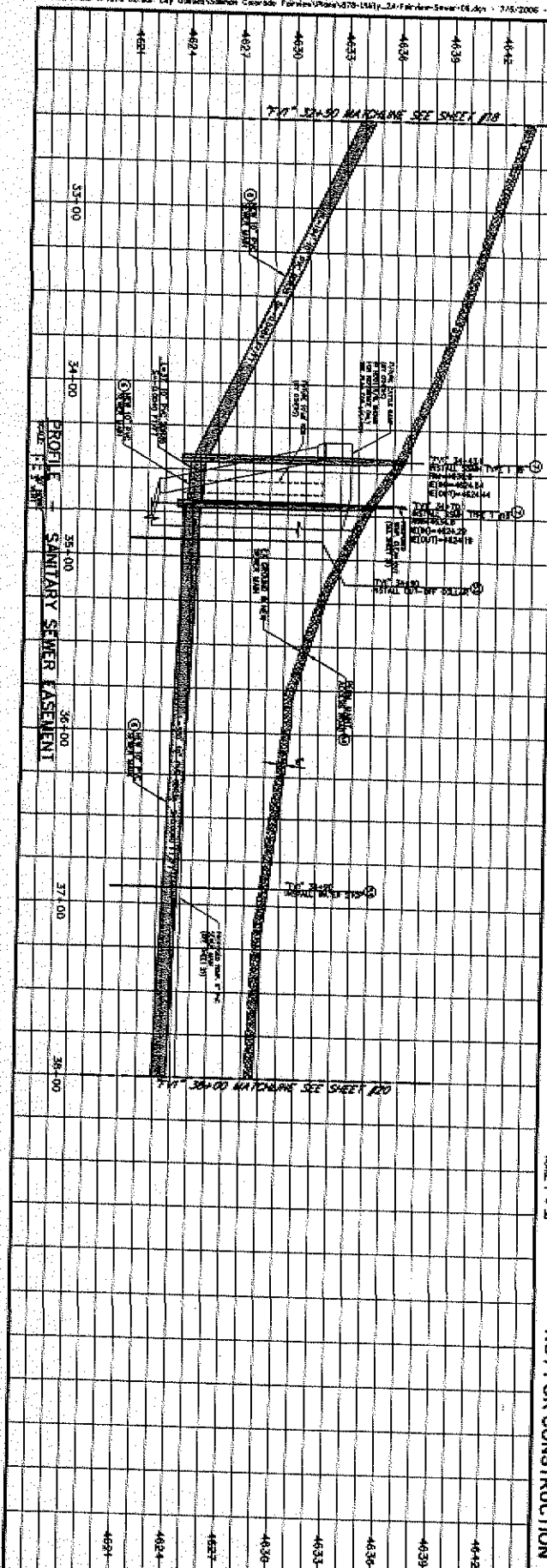

PLAN - SANITARY SEWER EASEMENT

SCALE
 1" = 30'

FOR INFORMATION ONLY
 NOT FOR CONSTRUCTION

NDOT/CARSON CITY
 AGREEMENT PLANS

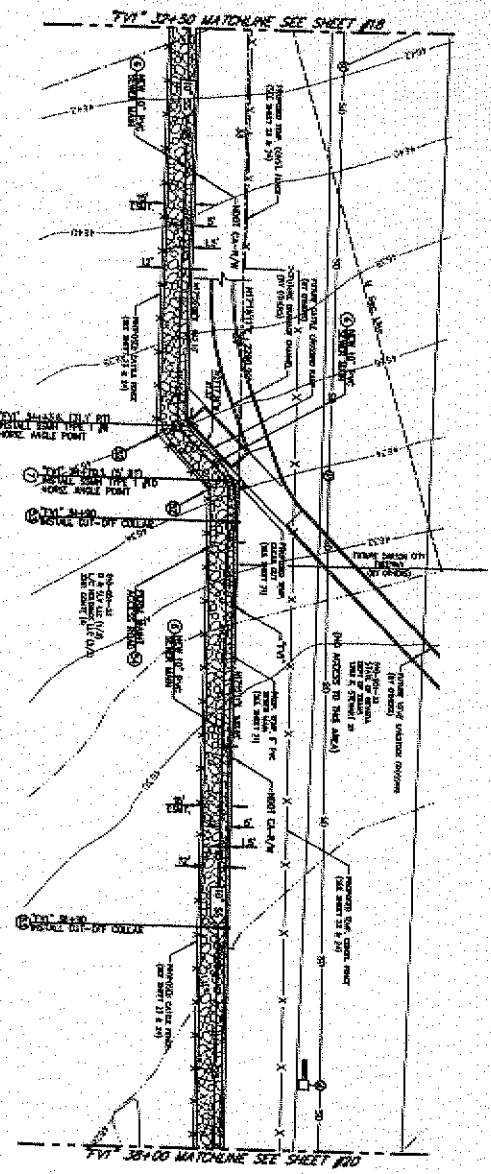

- CONSTRUCTION NOTES:**
- INSTALL 10" PVC SEWER PIPES WITH PER STD. DRAWING C-3.1A
 - INSTALL 48" BK. SANDWICH PER STD. DRAWING C-3.1A
 - INSTALL MANHOLE RINGS PER STD. DRAWING C-3.11, NOTE NO. 2
 - CONFORM TO ALL CITY, COUNTY & STATE REGULATIONS FOR SEWER INSTALLATION. ALL 10" SEWER LINES SHALL BE INSTALLED PER STD. DRAWING C-3.1A, UNLESS OTHERWISE SPECIFIED.
 - INSTALL PERMANENT MAINTENANCE ACCESS ROAD.

REV.	DATE	DESCRIPTION	BY	APP'D

CARSON CITY FREEWAY PHASE 2A
 UTILITY RELOCATIONS
 COLDWELL ST., S. SALAMAN RD., FARMER DR./LINEAR DITCH
 PROJECT No. 00-6010
 10" SANITARY SEWER MAIN
 "FV1" 32+50 TO "FV1" 38+00

PRELIMINARY
 09/20/06

CARSON CITY PUBLIC WORKS DEPARTMENT 3200 WEST 10TH ST. CARSON CITY, NEVADA 89709 PH: 867-3228 FAX: 867-2112	DESIGNED BY: JH
	DRAWN BY: JH
THE LOUIS BERGER GROUP INC. 1000 CENTRAL EXPRESSWAY	CHECKED BY: JH
	DATE: 09/20/06

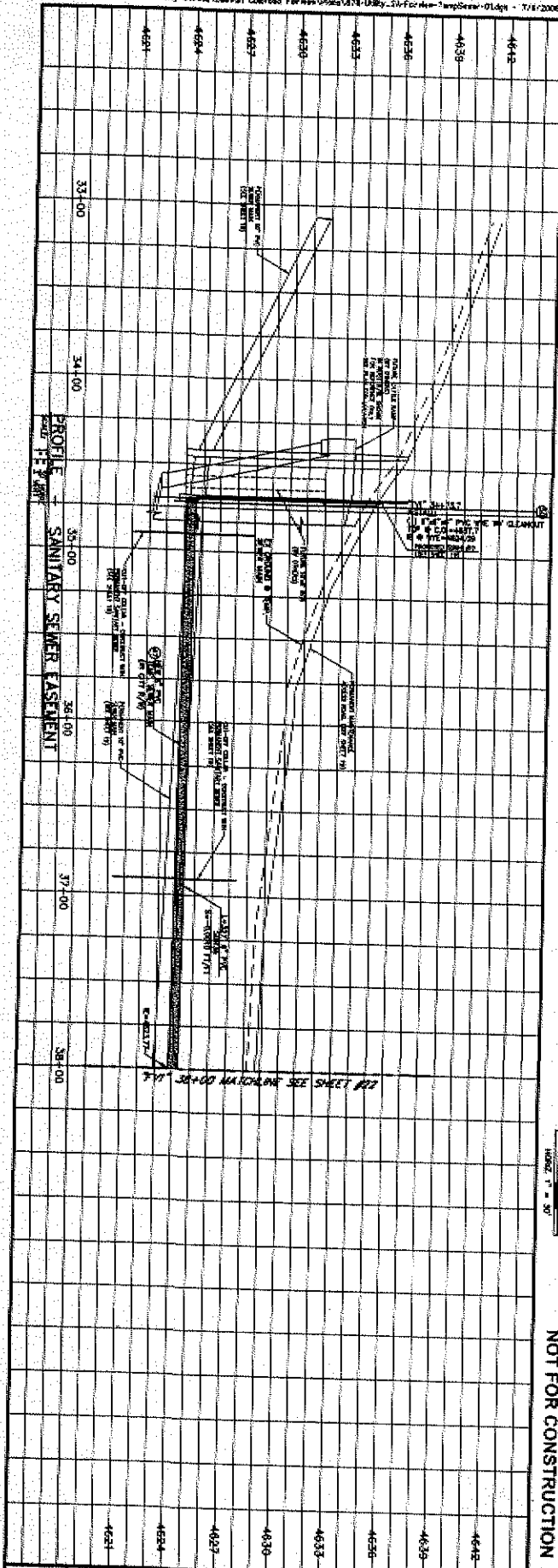

PLAN - SANITARY SEWER EASEMENT
 SCALE: 1" = 30'

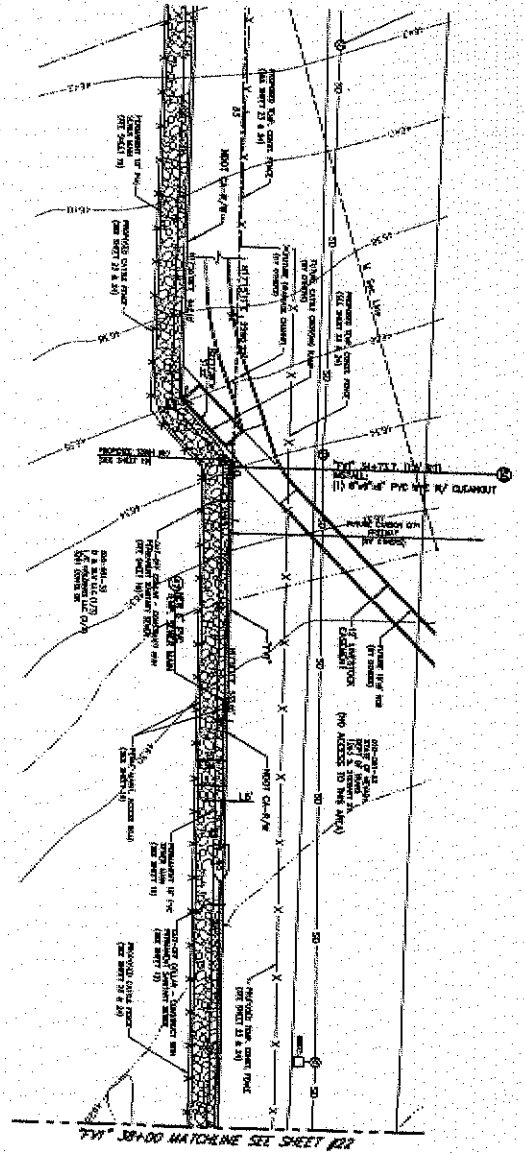

NDOT/CARSON CITY
 AGREEMENT PLANS
 FOR INFORMATION ONLY
 NOT FOR CONSTRUCTION

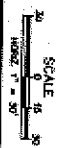

© 2005 THE LOUIS BERGER GROUP, INC.
 ALL RIGHTS RESERVED. NO PART OF THIS DRAWING SHALL
 BE REPRODUCED OR TRANSMITTED IN ANY FORM OR BY ANY
 MEANS, ELECTRONIC OR MECHANICAL, INCLUDING PHOTOCOPYING,
 RECORDING, OR BY ANY INFORMATION STORAGE AND RETRIEVAL
 SYSTEMS, WITHOUT PERMISSION IN WRITING FROM THE LOUIS BERGER
 GROUP, INC.

CARSON CITY FREEWAY PHASE 2A UTILITY RELOCATIONS COLORADO ST. S. SALAMAN RD., FARMWAY DR./LINEAR DITCH PROJECT No. 00-8010 6" TEMP. SANITARY SEWER MAIN "FV1" 34+70 to "FV1" 38+00		REV. DATE DESCRIPTION BY APP'D	DESIGNED BY: JED DRAWN BY: JED CHECKED BY: JED DATE: 09/20/05 SCALE: HORIZONTAL = 1" = 30' SCALE: VERTICAL = 1" = 10'
CARSON CITY PUBLIC WORKS DEPARTMENT 3300 BARTT WAY CARSON CITY, NEVADA 89704 PH: 867-3554 FAX: 867-2112		THE LOUIS BERGER GROUP INC. 1480 W. WASHINGTON ST. LAS VEGAS, NEVADA 89102	PRELIMINARY 09/20/05

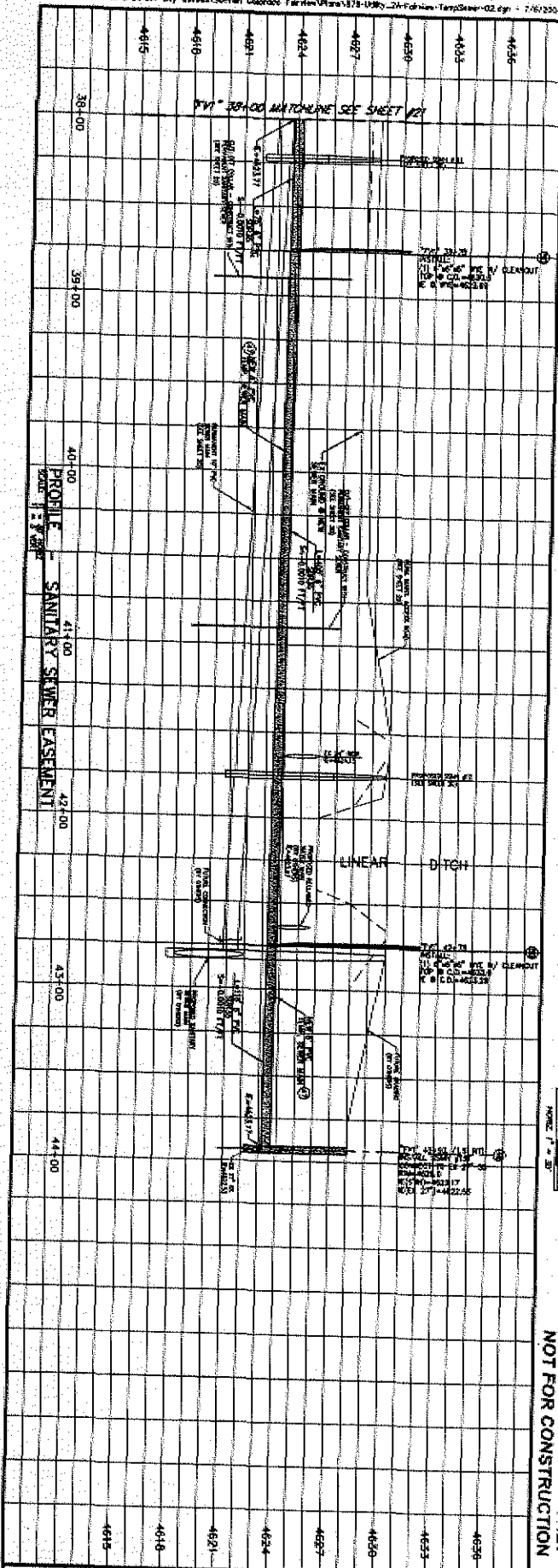

PLAN SANITARY SEWER EASEMENT

SCALE 1" = 30'

NDOT/CARSON CITY AGREEMENT PLANS

FOR INFORMATION ONLY
NOT FOR CONSTRUCTION

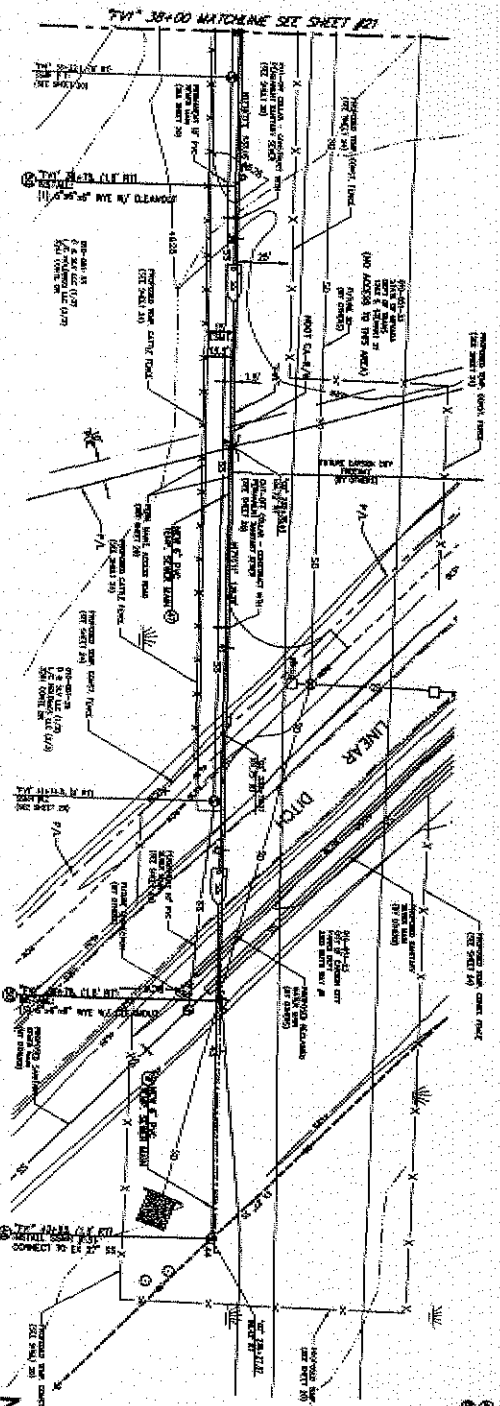

- CARSON/CITY NOTES:**
- 1. GENERAL CONTRACTOR SHALL MAINTAIN ALL EXISTING UTILITIES AND STRUCTURES.
 - 2. GENERAL CONTRACTOR SHALL MAINTAIN ALL EXISTING UTILITIES AND STRUCTURES.
 - 3. GENERAL CONTRACTOR SHALL MAINTAIN ALL EXISTING UTILITIES AND STRUCTURES.
 - 4. GENERAL CONTRACTOR SHALL MAINTAIN ALL EXISTING UTILITIES AND STRUCTURES.

CARSON CITY FREEWAY PHASE 2A UTILITY RELOCATIONS
 COLORADO ST., S. SALAMAN RD., FREEWAY DR./LINEAR DITCH
 PROJECT No. 00-5012
6" TEMP. SANITARY SEWER MAIN
 "FV1" 38+00 to "FV1" 44+00

REV.	DATE	DESCRIPTION	BY	APP'D

PRELIMINARY
09/20/06

CARSON CITY PUBLIC WORKS DEPARTMENT
 3200 BATH WAY CARSON CITY, NEVADA 89791
 PH: 867-1336 FAX: 867-2112

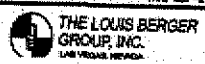

DESIGNED BY: JCY
 DRAWN BY: JCY
 CHECKED BY: JCY
 SCALE (HORIZONTAL): 1" = 30'
 SCALE (VERTICAL): 1" = 5'

22
07
32

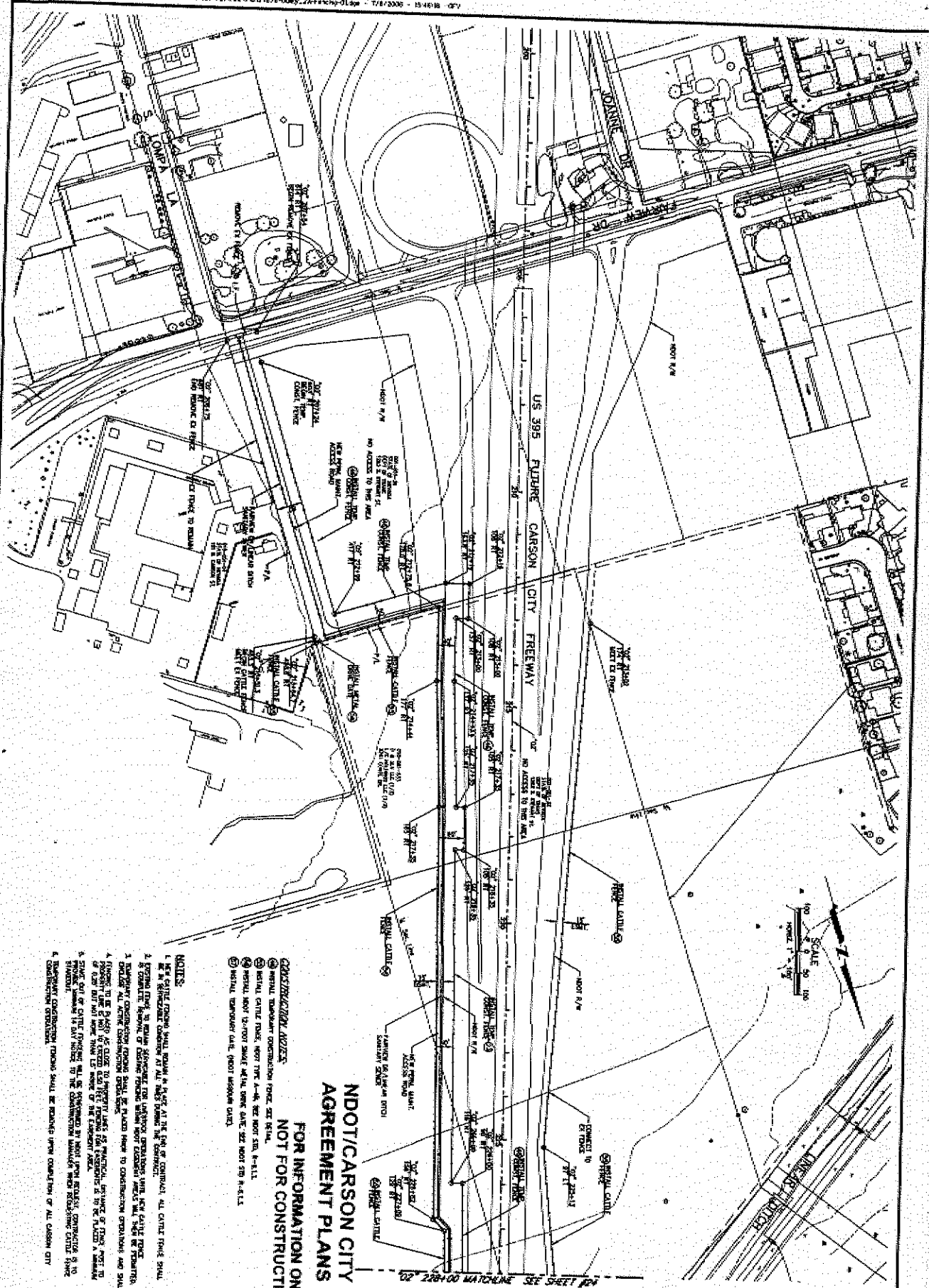

**NDOT/CARSON CITY
 AGREEMENT PLANS**

**FOR INFORMATION ONLY
 NOT FOR CONSTRUCTION**

- CONSTRUCTION NOTES:**
- 1. ALL UTILITY RELOCATIONS SHALL BE MADE AT THE END OF CONSTRUCTION. ALL CHUTE FRAMES SHALL BE IN REMOVED CONDITION AT ALL TIMES DURING THE CONSTRUCTION.
 - 2. CHUTE FRAMES SHALL BE REMOVED IMMEDIATELY UPON COMPLETION OF UTILITY RELOCATIONS. ALL CHUTE FRAMES SHALL BE REMOVED IMMEDIATELY UPON COMPLETION OF UTILITY RELOCATIONS. ALL CHUTE FRAMES SHALL BE REMOVED IMMEDIATELY UPON COMPLETION OF UTILITY RELOCATIONS.
 - 3. TEMPORARY CONSTRUCTION FENCING SHALL BE PLACED PRIOR TO CONSTRUCTION OPERATIONS AND SHALL BE MAINTAINED THROUGHOUT THE CONSTRUCTION PERIOD. ALL CONSTRUCTION FENCING SHALL BE MAINTAINED THROUGHOUT THE CONSTRUCTION PERIOD.
 - 4. FENCING TO BE PLACED AS CLOSE TO PROPERTY LINE AS PRACTICABLE. FENCING SHALL BE MAINTAINED THROUGHOUT THE CONSTRUCTION PERIOD. FENCING SHALL BE MAINTAINED THROUGHOUT THE CONSTRUCTION PERIOD.
 - 5. FENCING SHALL BE MAINTAINED THROUGHOUT THE CONSTRUCTION PERIOD. FENCING SHALL BE MAINTAINED THROUGHOUT THE CONSTRUCTION PERIOD.
 - 6. TEMPORARY CONSTRUCTION FENCING SHALL BE REMOVED UPON COMPLETION OF ALL CONSTRUCTION OPERATIONS.

- NOTES:**
- 1. ALL UTILITY RELOCATIONS SHALL BE MADE AT THE END OF CONSTRUCTION. ALL CHUTE FRAMES SHALL BE IN REMOVED CONDITION AT ALL TIMES DURING THE CONSTRUCTION.
 - 2. CHUTE FRAMES SHALL BE REMOVED IMMEDIATELY UPON COMPLETION OF UTILITY RELOCATIONS. ALL CHUTE FRAMES SHALL BE REMOVED IMMEDIATELY UPON COMPLETION OF UTILITY RELOCATIONS.
 - 3. TEMPORARY CONSTRUCTION FENCING SHALL BE PLACED PRIOR TO CONSTRUCTION OPERATIONS AND SHALL BE MAINTAINED THROUGHOUT THE CONSTRUCTION PERIOD. ALL CONSTRUCTION FENCING SHALL BE MAINTAINED THROUGHOUT THE CONSTRUCTION PERIOD.
 - 4. FENCING TO BE PLACED AS CLOSE TO PROPERTY LINE AS PRACTICABLE. FENCING SHALL BE MAINTAINED THROUGHOUT THE CONSTRUCTION PERIOD. FENCING SHALL BE MAINTAINED THROUGHOUT THE CONSTRUCTION PERIOD.
 - 5. FENCING SHALL BE MAINTAINED THROUGHOUT THE CONSTRUCTION PERIOD. FENCING SHALL BE MAINTAINED THROUGHOUT THE CONSTRUCTION PERIOD.
 - 6. TEMPORARY CONSTRUCTION FENCING SHALL BE REMOVED UPON COMPLETION OF ALL CONSTRUCTION OPERATIONS.

**CARSON CITY FREEWAY PHASE 2A
 UTILITY RELOCATIONS**
 COLORADO ST., S. SALWAY RD., FATHWAY DR./LINEAR DRIVE
 PROJECT No. 20-6019
PROJECT FENCING PLAN

REV.	DATE	DESCRIPTION	BY	APP'D

**PRELIMINARY
 09/20/06**

**CARSON CITY
 PUBLIC WORKS DEPARTMENT**
 3008 BARTY BOY CARSON CITY, NEVADA 89701
 702-867-3256 FAX: 702-867-3442



DESIGNED BY: JLR
 DRAWN BY: JRY
 CHECKED BY: JJC
 DATE: 09/20/06
 SCALE: AS SHOWN
 SCALE: 1" = 100'

23
 OF
 32

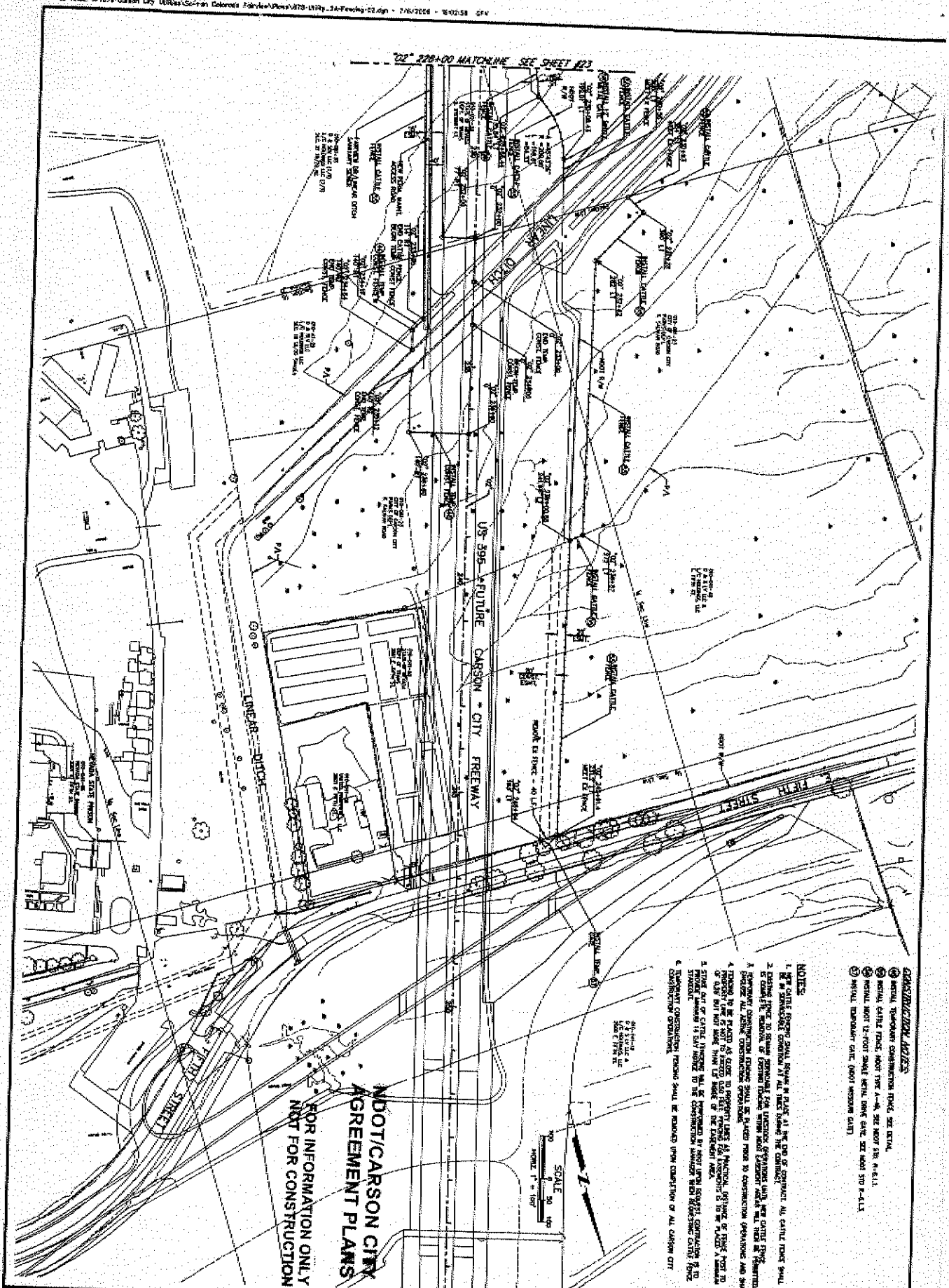

NDOT/CARSON CITY AGREEMENT PLANS
 FOR INFORMATION ONLY
 NOT FOR CONSTRUCTION

- CONSTRUCTION NOTES**
- 1. GENERAL UTILITIES
 - 2. GENERAL UTILITIES
 - 3. GENERAL UTILITIES
 - 4. GENERAL UTILITIES
 - 5. GENERAL UTILITIES
 - 6. GENERAL UTILITIES
 - 7. GENERAL UTILITIES
 - 8. GENERAL UTILITIES
 - 9. GENERAL UTILITIES
 - 10. GENERAL UTILITIES
 - 11. GENERAL UTILITIES
- NOTES**
1. THE CITY ENGINEER SHALL REVIEW AND APPROVE ALL CONSTRUCTION. ALL CONSTRUCTION SHALL BE IN ACCORDANCE WITH THE CITY ENGINEER'S APPROVAL.
 2. THE CITY ENGINEER SHALL BE RESPONSIBLE FOR OBTAINING ALL NECESSARY PERMITS AND APPROVALS FROM THE CITY ENGINEER AND THE NEVADA DEPARTMENT OF TRANSPORTATION AND CONSTRUCTION.
 3. THE CITY ENGINEER SHALL BE RESPONSIBLE FOR OBTAINING ALL NECESSARY PERMITS AND APPROVALS FROM THE CITY ENGINEER AND THE NEVADA DEPARTMENT OF TRANSPORTATION AND CONSTRUCTION.
 4. THE CITY ENGINEER SHALL BE RESPONSIBLE FOR OBTAINING ALL NECESSARY PERMITS AND APPROVALS FROM THE CITY ENGINEER AND THE NEVADA DEPARTMENT OF TRANSPORTATION AND CONSTRUCTION.
 5. THE CITY ENGINEER SHALL BE RESPONSIBLE FOR OBTAINING ALL NECESSARY PERMITS AND APPROVALS FROM THE CITY ENGINEER AND THE NEVADA DEPARTMENT OF TRANSPORTATION AND CONSTRUCTION.
 6. THE CITY ENGINEER SHALL BE RESPONSIBLE FOR OBTAINING ALL NECESSARY PERMITS AND APPROVALS FROM THE CITY ENGINEER AND THE NEVADA DEPARTMENT OF TRANSPORTATION AND CONSTRUCTION.
 7. THE CITY ENGINEER SHALL BE RESPONSIBLE FOR OBTAINING ALL NECESSARY PERMITS AND APPROVALS FROM THE CITY ENGINEER AND THE NEVADA DEPARTMENT OF TRANSPORTATION AND CONSTRUCTION.
 8. THE CITY ENGINEER SHALL BE RESPONSIBLE FOR OBTAINING ALL NECESSARY PERMITS AND APPROVALS FROM THE CITY ENGINEER AND THE NEVADA DEPARTMENT OF TRANSPORTATION AND CONSTRUCTION.
 9. THE CITY ENGINEER SHALL BE RESPONSIBLE FOR OBTAINING ALL NECESSARY PERMITS AND APPROVALS FROM THE CITY ENGINEER AND THE NEVADA DEPARTMENT OF TRANSPORTATION AND CONSTRUCTION.
 10. THE CITY ENGINEER SHALL BE RESPONSIBLE FOR OBTAINING ALL NECESSARY PERMITS AND APPROVALS FROM THE CITY ENGINEER AND THE NEVADA DEPARTMENT OF TRANSPORTATION AND CONSTRUCTION.
 11. THE CITY ENGINEER SHALL BE RESPONSIBLE FOR OBTAINING ALL NECESSARY PERMITS AND APPROVALS FROM THE CITY ENGINEER AND THE NEVADA DEPARTMENT OF TRANSPORTATION AND CONSTRUCTION.

**CARSON CITY FREEWAY PHASE 2A
 UTILITY RELOCATIONS**
 COLUMBIA ST., S. SUMMIT DR., FARMER DR., LINEAR DITCH
 PROJECT No. 00-8010
PROJECT FENCING PLAN

REV.	DATE	DESCRIPTION	BY	APP'D.

PRELIMINARY
 05/20/06

**CARSON CITY
 PUBLIC WORKS DEPARTMENT**
 2500 S. 10TH AVE. CARSON CITY, NEVADA 89601
 TEL: 702-795-1255 FAX: 702-795-1212

**THE LOUIS BERGER
 GROUP, INC.**

DESIGNED BY: J. W. BERGER
 DRAWN BY: J. W. BERGER
 CHECKED BY: J. W. BERGER
 IN CHARGE: J. W. BERGER
 SCALE: AS SHOWN
 DATE: 05/20/06

SHEET
 24
 OF
 32

1. ALL SEWER LINES AND MANHOLES IN THE RIGHT-OF-WAY/ROADWAY SHALL BE TWO SIDES UNLESS OTHERWISE NOTED.
2. MANHOLE MATERIAL SHALL BE APPROVED UNDER THE SUPERVISION OF CARSON CITY ENGINEERING DEPARTMENT. ALL MANHOLES SHALL BE CONSTRUCTED TO PREVENT ROOTS FROM GROWING INTO THE SEWER LINES TO CAUSE BLOCKAGE AND/OR DAMAGE.
3. THE CONSTRUCTION SHALL BE AT THE POINT OF CONNECTION OR A POINT NEARBY TO THE POINT OF CONNECTION. THE MANHOLE SHALL BE CONSTRUCTED TO PREVENT ROOTS FROM GROWING INTO THE SEWER LINES TO CAUSE BLOCKAGE AND/OR DAMAGE. THE MANHOLE SHALL BE CONSTRUCTED TO PREVENT ROOTS FROM GROWING INTO THE SEWER LINES TO CAUSE BLOCKAGE AND/OR DAMAGE.
4. AS NOTED, THE MANHOLE SHALL BE CONSTRUCTED TO PREVENT ROOTS FROM GROWING INTO THE SEWER LINES TO CAUSE BLOCKAGE AND/OR DAMAGE. THE MANHOLE SHALL BE CONSTRUCTED TO PREVENT ROOTS FROM GROWING INTO THE SEWER LINES TO CAUSE BLOCKAGE AND/OR DAMAGE.
5. MANHOLE TOP SHALL BE NOTED IN THE FIELD. MANHOLE TOP SHALL BE NOTED IN THE FIELD. MANHOLE TOP SHALL BE NOTED IN THE FIELD.
6. SEWER LINES SHALL BE CONSTRUCTED TO PREVENT ROOTS FROM GROWING INTO THE SEWER LINES TO CAUSE BLOCKAGE AND/OR DAMAGE. THE SEWER LINES SHALL BE CONSTRUCTED TO PREVENT ROOTS FROM GROWING INTO THE SEWER LINES TO CAUSE BLOCKAGE AND/OR DAMAGE.

NO.	REVISION	DATE	DESCRIPTION	BY	APP'D.
1	ISSUED FOR CONSTRUCTION	05/20/06	MANHOLE TYPE 1		
2	ISSUED FOR CONSTRUCTION	05/20/06	MANHOLE TYPE 2		

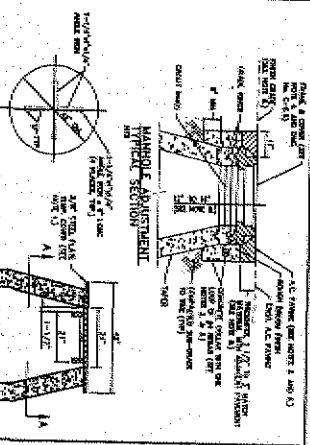

NO.	REVISION	DATE	DESCRIPTION	BY	APP'D.
1	ISSUED FOR CONSTRUCTION	05/20/06	MANHOLE TYPE 1		
2	ISSUED FOR CONSTRUCTION	05/20/06	MANHOLE TYPE 2		

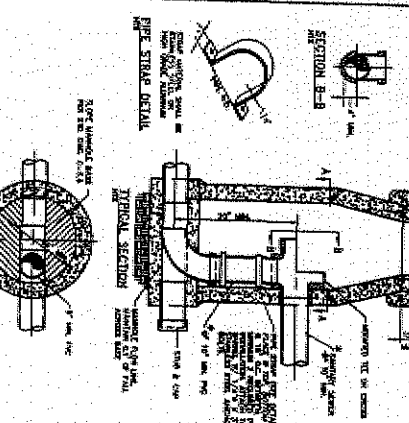

NO.	REVISION	DATE	DESCRIPTION	BY	APP'D.
1	ISSUED FOR CONSTRUCTION	05/20/06	SEWER LINE TRANSITION		
2	ISSUED FOR CONSTRUCTION	05/20/06	SEWER LINE TRANSITION		

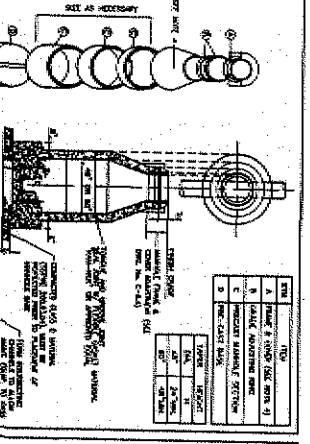

NO.	REVISION	DATE	DESCRIPTION	BY	APP'D.
1	ISSUED FOR CONSTRUCTION	05/20/06	SEWER LINE TRANSITION		
2	ISSUED FOR CONSTRUCTION	05/20/06	SEWER LINE TRANSITION		

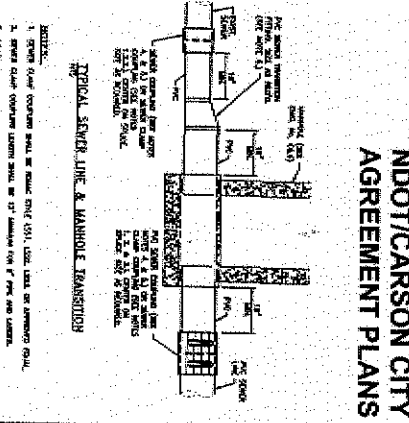

NO.	REVISION	DATE	DESCRIPTION	BY	APP'D.
1	ISSUED FOR CONSTRUCTION	05/20/06	CROSSING		
2	ISSUED FOR CONSTRUCTION	05/20/06	CROSSING		

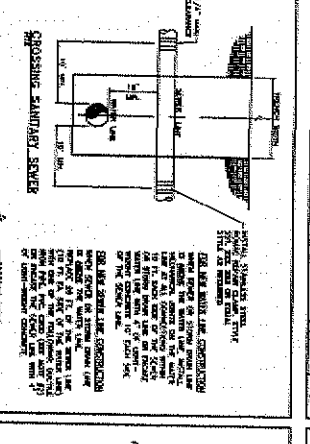

NO.	REVISION	DATE	DESCRIPTION	BY	APP'D.
1	ISSUED FOR CONSTRUCTION	05/20/06	CROSSING		
2	ISSUED FOR CONSTRUCTION	05/20/06	CROSSING		

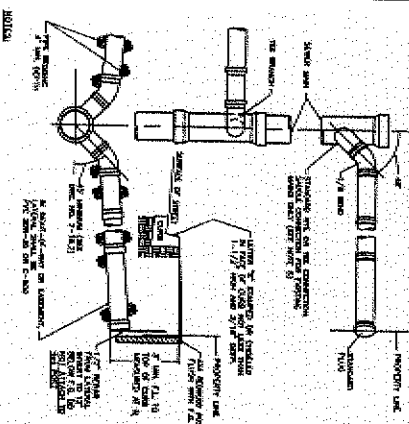

NO.	REVISION	DATE	DESCRIPTION	BY	APP'D.
1	ISSUED FOR CONSTRUCTION	05/20/06	SEWER LATERAL		
2	ISSUED FOR CONSTRUCTION	05/20/06	SEWER LATERAL		

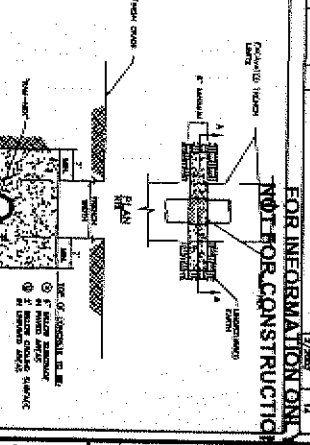

NO.	REVISION	DATE	DESCRIPTION	BY	APP'D.
1	ISSUED FOR CONSTRUCTION	05/20/06	SEWER LATERAL		
2	ISSUED FOR CONSTRUCTION	05/20/06	SEWER LATERAL		

FOR INFORMATION ONLY - NOT FOR CONSTRUCTION

NO.	REVISION	DATE	DESCRIPTION	BY	APP'D.

PRELIMINARY 05/20/06

CARSON CITY FREEWAY PHASE 2A UTILITY RELOCATIONS
 COLORADO ST. & SALAMAN DR., FARMVIEW DR./LARAMIE BRCH
 PROJECT No. 00-6810

TYPICAL CONSTRUCTION DETAILS

CARSON CITY PUBLIC WORKS DEPARTMENT
 2508 NORTH WALK CARSON CITY, NEVADA 89207
 PH: 857-3336 FAX: 857-8112

THE LOUIS BERGER GROUP, INC.
 LAS VEGAS, NEVADA

DRAWN BY: []
 CHECKED BY: []
 SCALE: []
 SHEET 25 OF 32

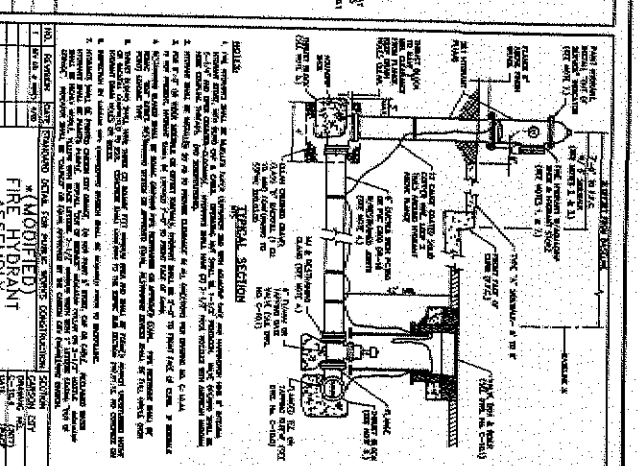
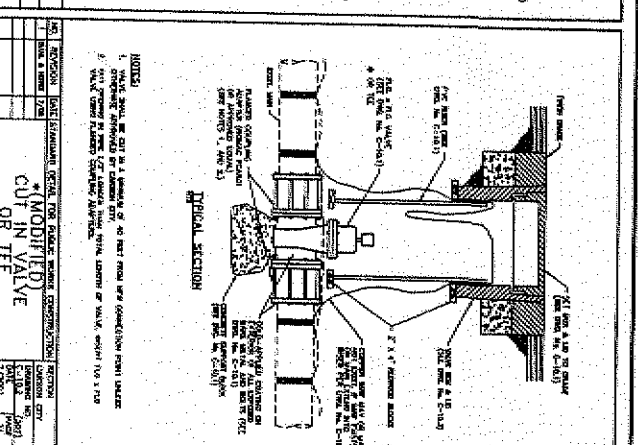
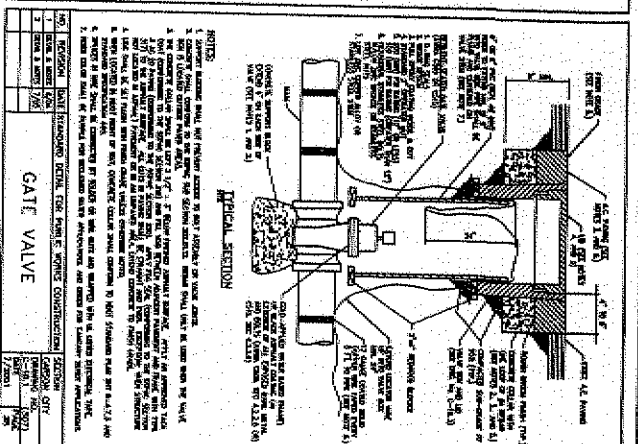
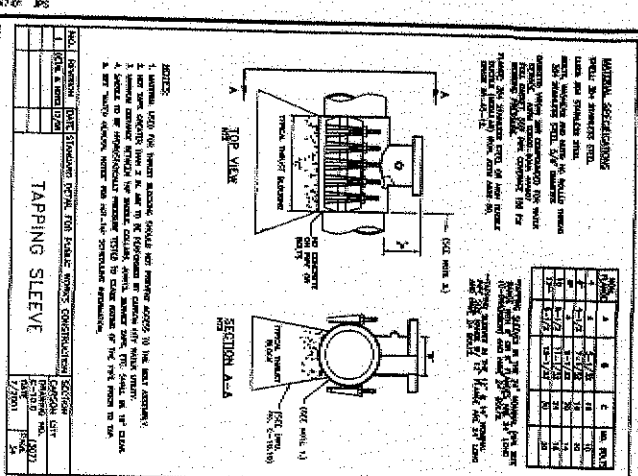
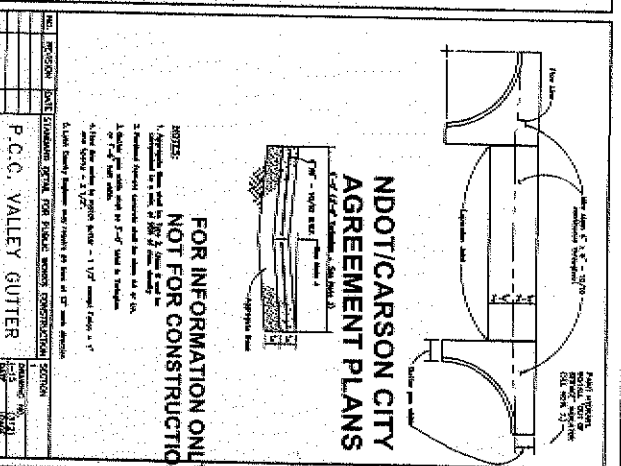
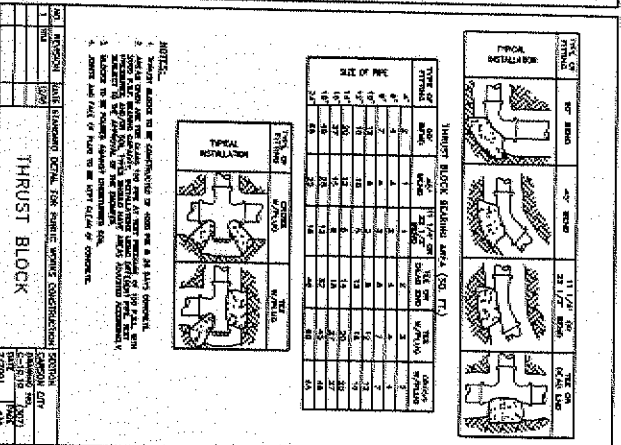
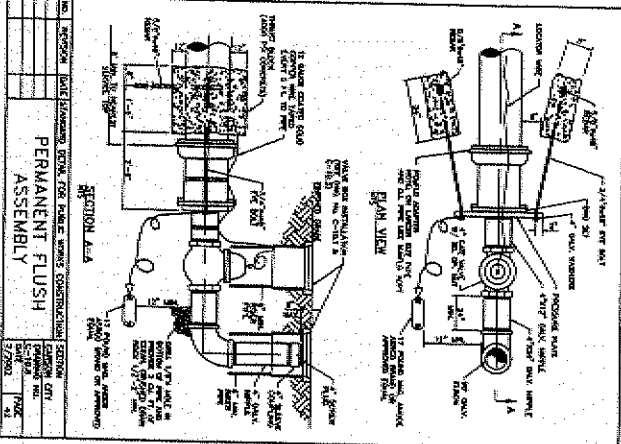
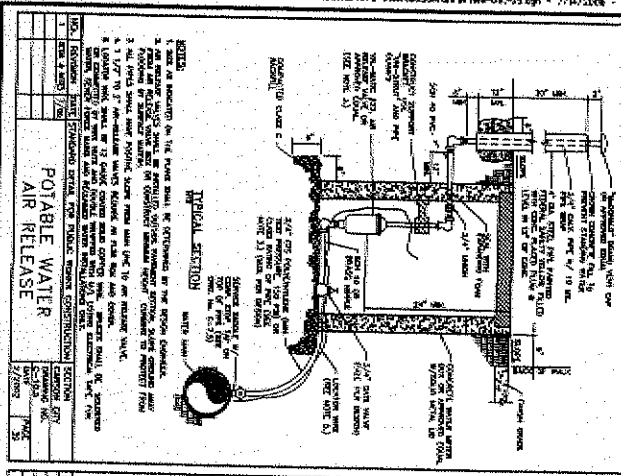

REV.	DATE	DESCRIPTION	BY	APP'D

PRELIMINARY
 09/20/06

CARSON CITY PUBLIC WORKS DEPARTMENT
 2402 SOUTH MAIN STREET, CARSON CITY, NEVADA 89401
 PH: 702-255-2500 FAX: 702-255-2118

THE LOUIS BERGER GROUP, INC.
 100 W. WASHINGTON ST., SUITE 200, LAS VEGAS, NV 89101

DESIGNED BY: JCK
 DRAWN BY: JCK
 CHECKED BY: JCK
 SCALE: AS SHOWN
 SHEET NUMBER: 27
 TOTAL SHEETS: 32

CARSON CITY FREEWAY PHASE 2A
 UTILITY RELOCATIONS
 COLORADO ST., S. SHAWAN RD., FARVIEW DR./BREAK DITCH
 PROJECT No. 00-6010
 TYPICAL CONSTRUCTION DETAILS