

**PARKS AND RECREATION COMMISSION
STAFF REPORT**

MEETING DATE: February 2, 2016

AGENDA ITEM NUMBER: 3C

APPLICANT: Thomas Reed, Eagle Scout
Vern L. Krahn, Senior Park Planner

REQUEST: Presentation and discussion only by Thomas Reed, Eagle Scout on the completion of his Lone Mountain Park Trail Enhancement and Fence/Signage Removal Project.

GENERAL DISCUSSION: On Saturday, October 10, 2015 Mr. Reed completed his Eagle Scout Project. As the Commission may remember, his project consisted of trail enhancements, removal of outdated and tagged revegetation signage, graffiti removal, old metal tee posts and wooden fence posts, including the installation of a bench near the high rock outcrop on the south end of Lone Mountain Park.

As discussed previously, the entire trail system at Lone Mountain Park was completed by a number of Eagle Scouts building one trail segment at a time. This project seemed an appropriate one for Mr. Reed because it would be in keeping with the trail system's construction history and his desire to improve the trail system and improve the overall visual appearance of the park. In addition, his project will assist staff, limited by years of budget cuts and staffing reductions, to address the visual clutter on the park's natural slopes and improve public safety.

Mr. Reed will be at this meeting to show the Commission a PowerPoint presentation about the completion of his project (Exhibit A) and will be available to answer any questions.

RECOMMENDED ACTION: This is a presentation and discussion only item. No formal action can be taken by the Commission at this time.

Lone Mountain Park Trail

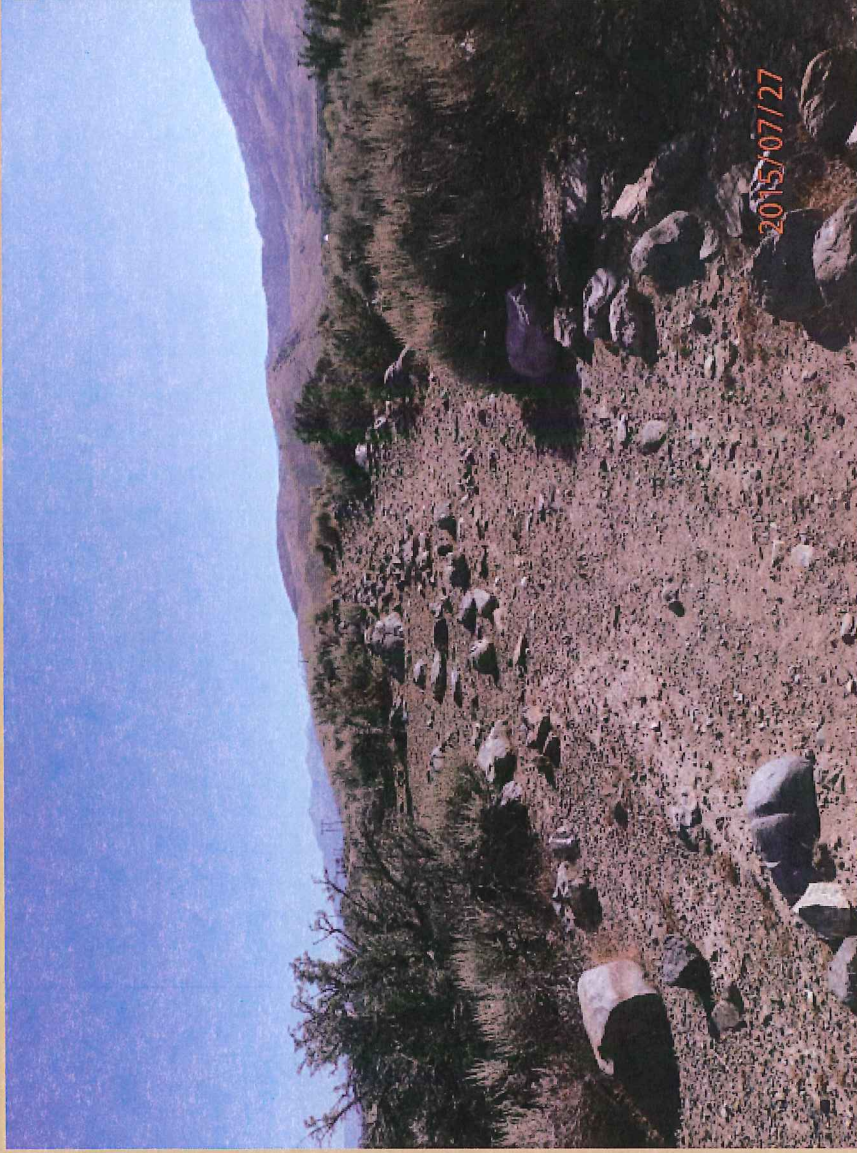

Eagle Scout Project of Thomas Reed

Before



After

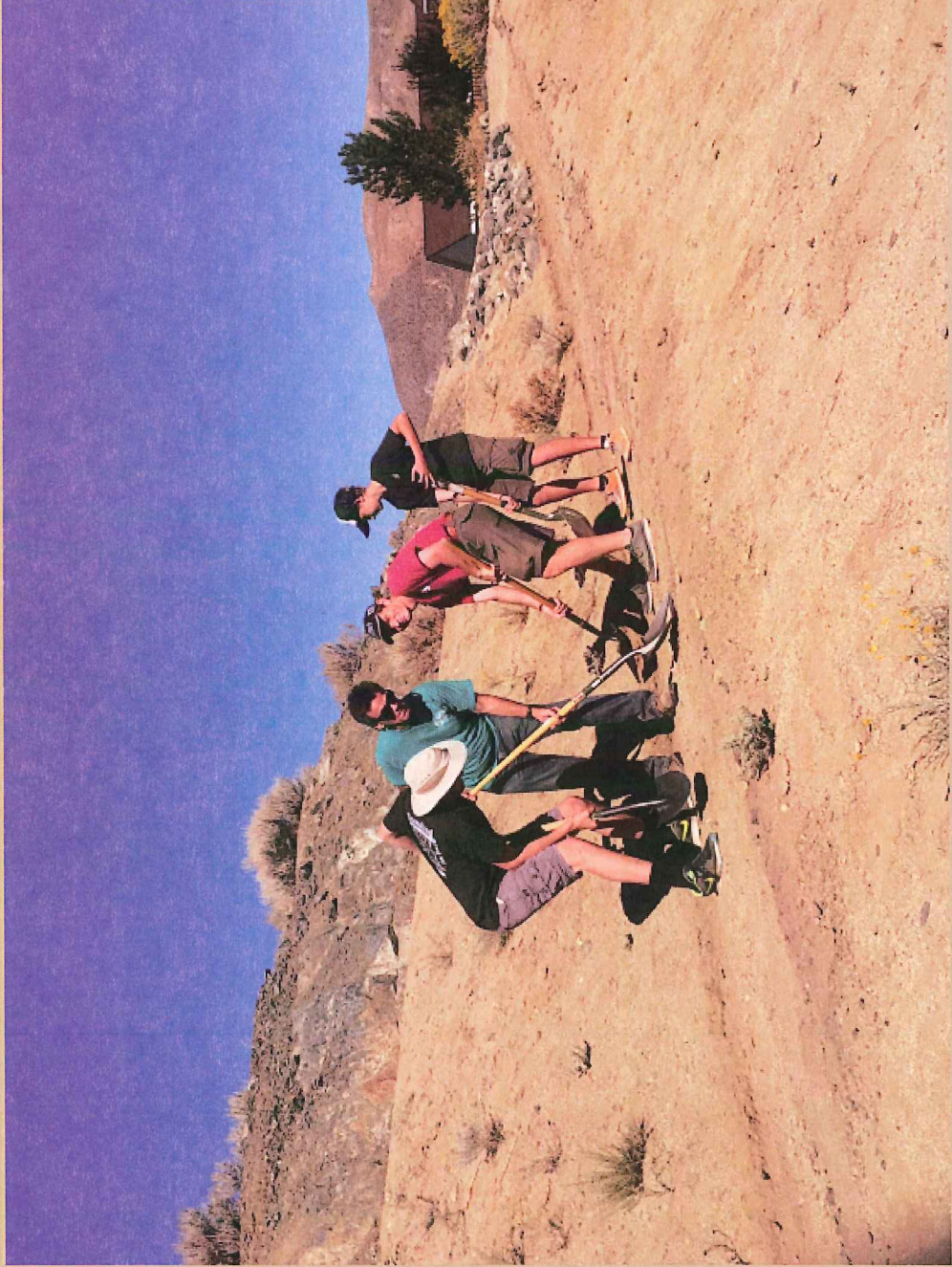

Before



After

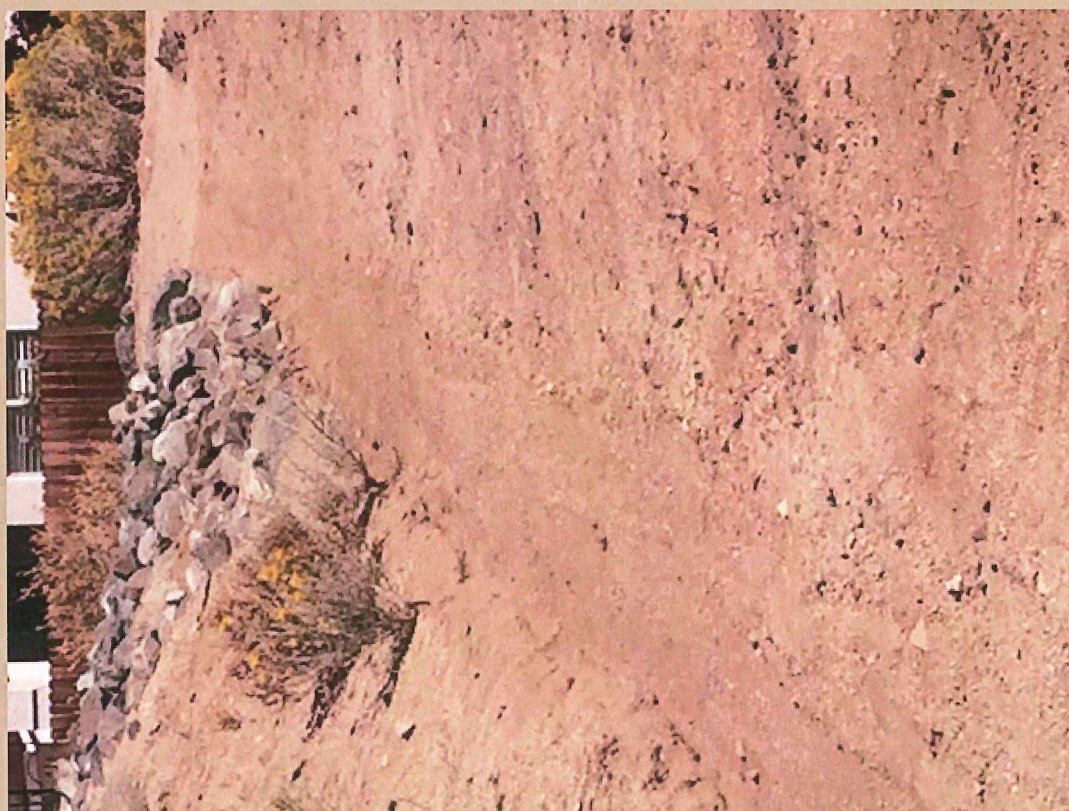

Before

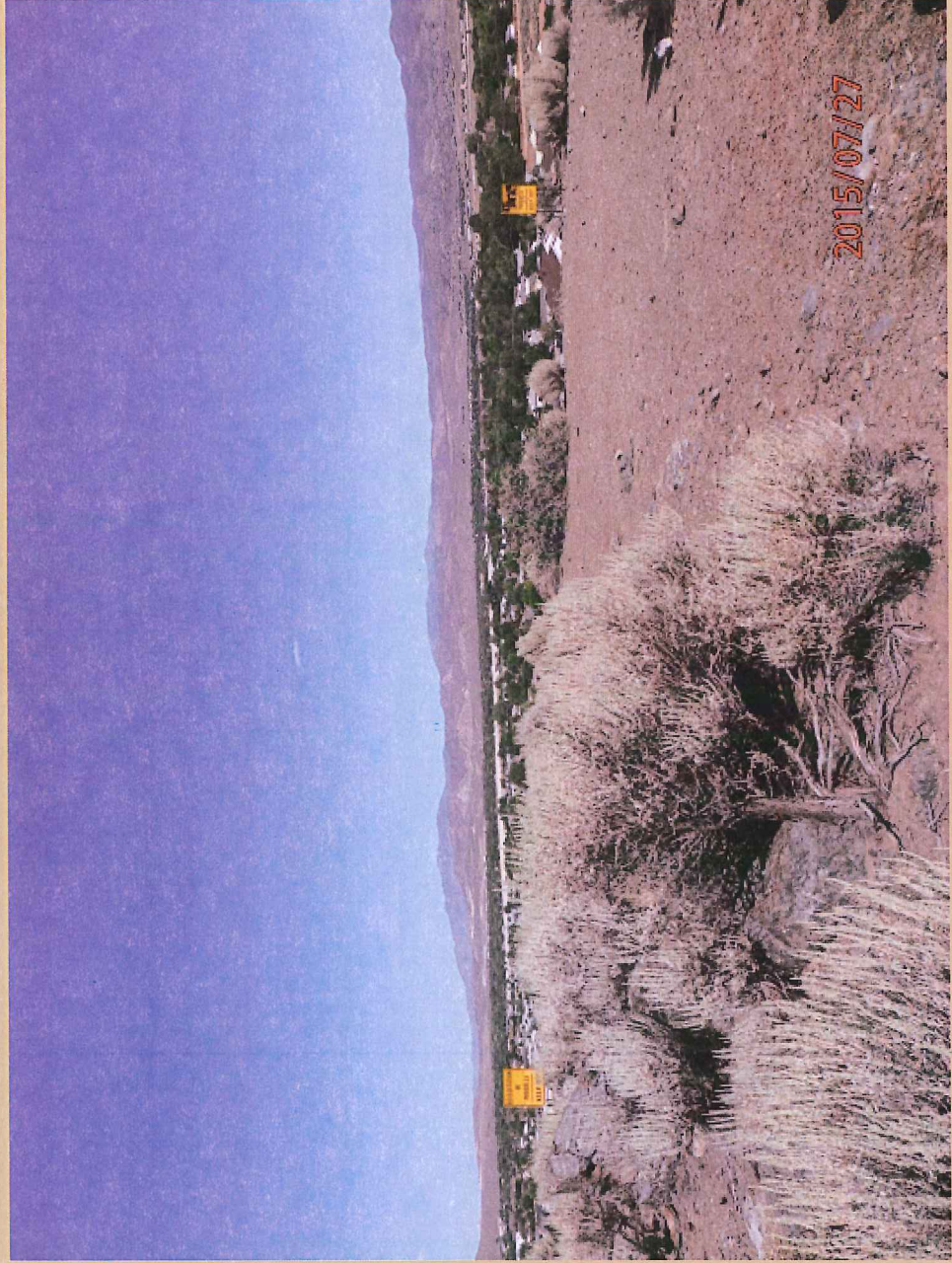

After

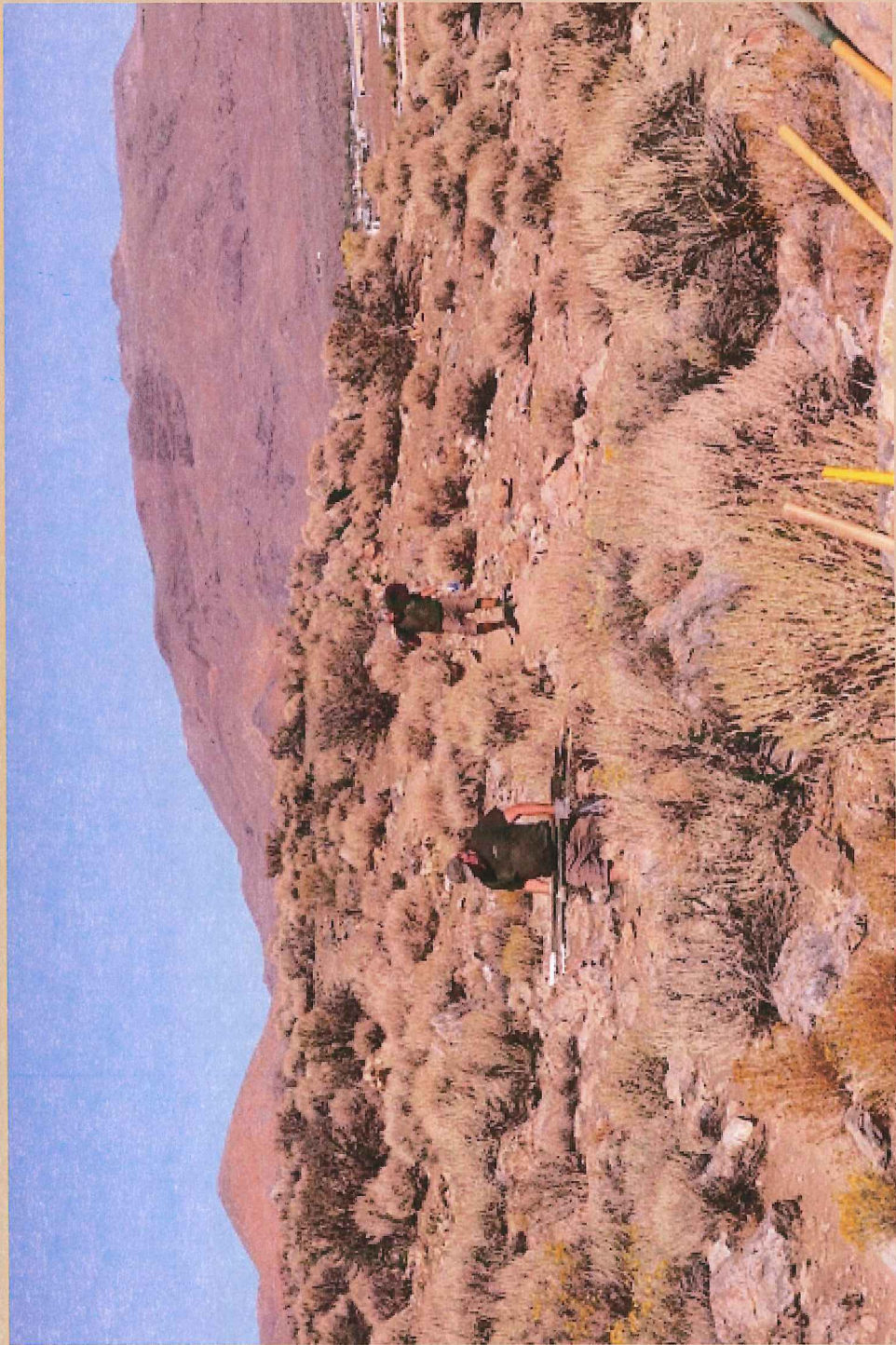

Before



After

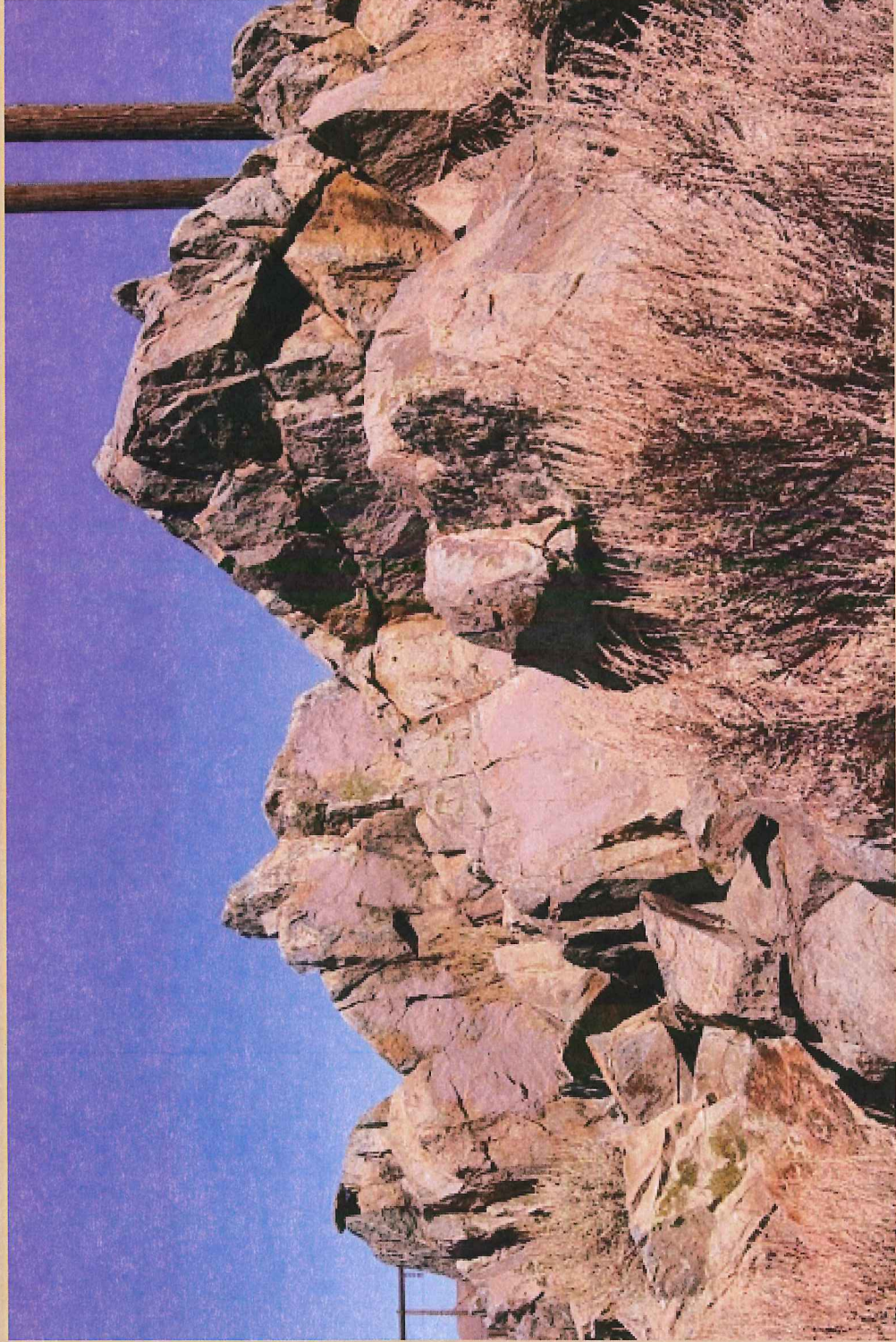

Panorama

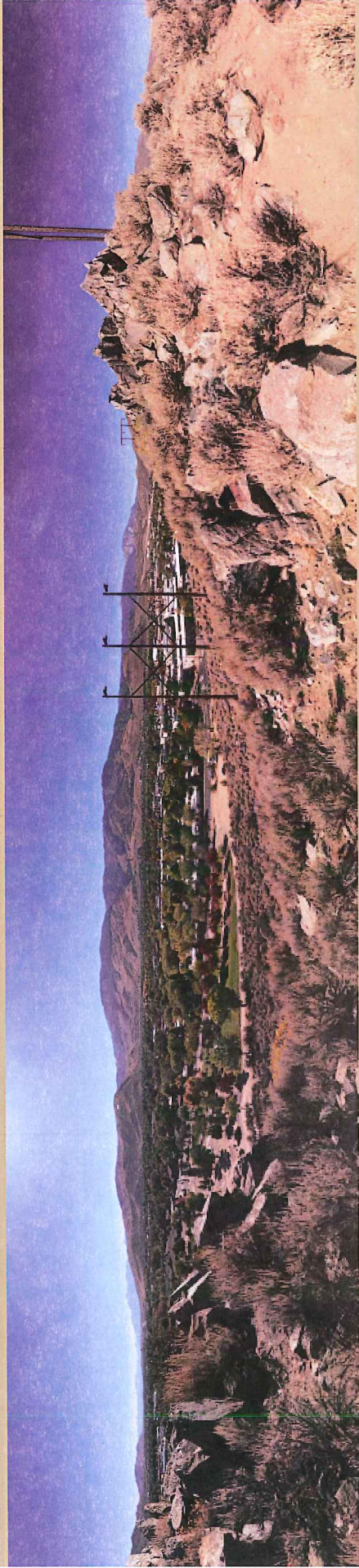

The Notorious Bench

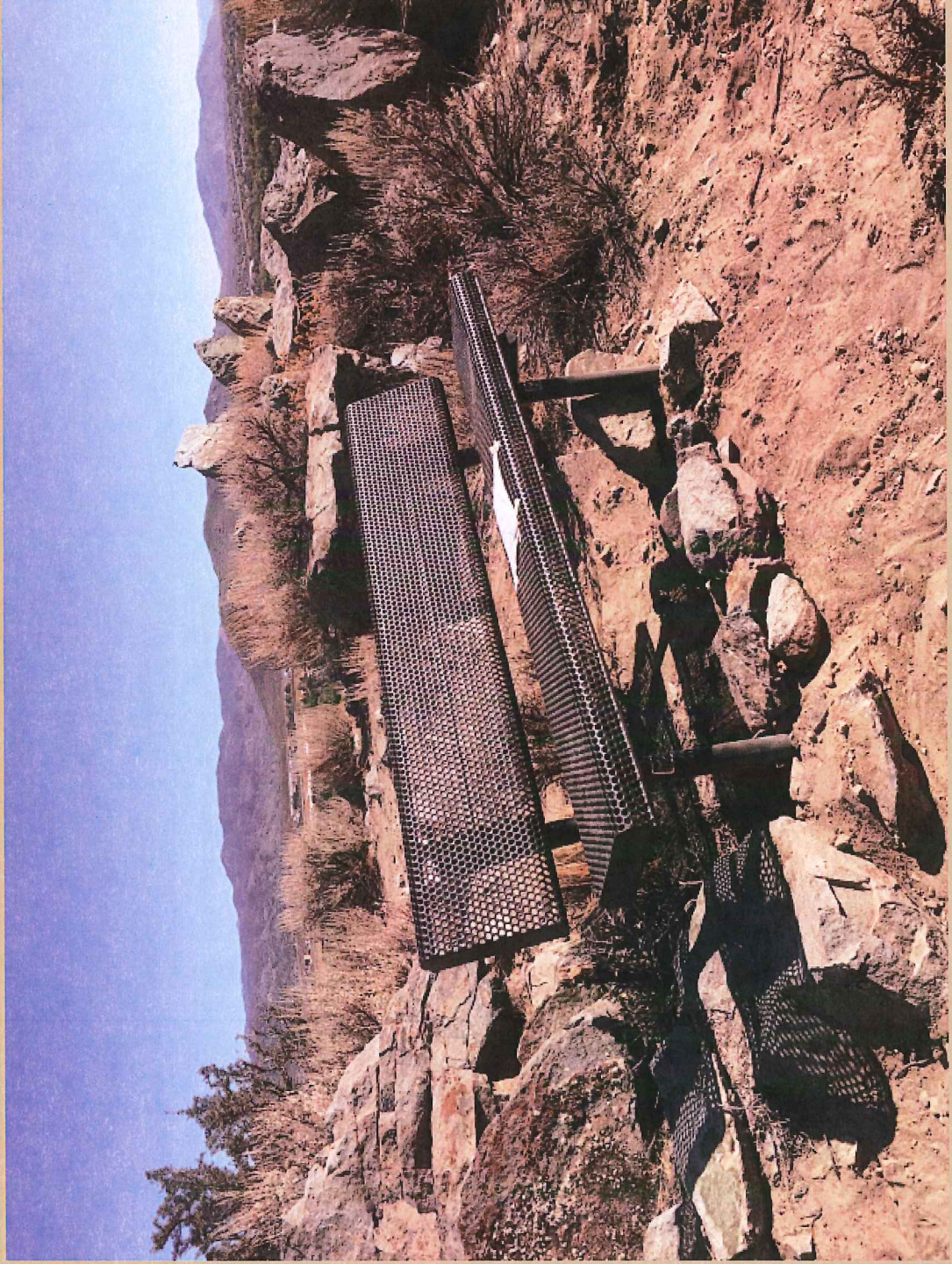

Questions?

