

ELEVATION CERTIFICATE  
Important: Follow the instructions on pages 1-9.

Copy all pages of this Elevation Certificate and all attachments for (1) community official, (2) insurance agent/company, and (3) building owner.

SECTION A -- PROPERTY INFORMATION					FOR INSURANCE COMPANY USE	
A1. Building Owner's Name BATES HOMES					Policy Number:	
A2. Building Street Address (including Apt., Unit, Suite, and/or Bldg. No.) or P.O. Route and Box No. 1357 GROVE ST					Company NAIC Number:	
City CARSON CITY		State Nevada		ZIP Code 89701		
A3. Property Description (Lot and Block Numbers, Tax Parcel Number, Legal Description, etc.) LOT 1-5, LITTLE LANE VILLAGE (004-39-143)						
A4. Building Use (e.g., Residential, Non-Residential, Addition, Accessory, etc.) Residential						
A5. Latitude/Longitude: Lat. 39.15795 Long. -119.75318 Horizontal Datum: <input type="checkbox"/> NAD 1927 <input checked="" type="checkbox"/> NAD 1983						
A6. Attach at least 2 photographs of the building if the Certificate is being used to obtain flood insurance.						
A7. Building Diagram Number 1B						
A8. For a building with a crawlspace or enclosure(s):						
a) Square footage of crawlspace or enclosure(s) N/A sq ft						
b) Number of permanent flood openings in the crawlspace or enclosure(s) within 1.0 foot above adjacent grade N/A						
c) Total net area of flood openings in A8.b N/A sq in						
d) Engineered flood openings? <input type="checkbox"/> Yes <input checked="" type="checkbox"/> No						
A9. For a building with an attached garage:						
a) Square footage of attached garage 459 sq ft						
b) Number of permanent flood openings in the attached garage within 1.0 foot above adjacent grade 0						
c) Total net area of flood openings in A9.b 0 sq in						
d) Engineered flood openings? <input type="checkbox"/> Yes <input checked="" type="checkbox"/> No						
SECTION B -- FLOOD INSURANCE RATE MAP (FIRM) INFORMATION						
B1. NFIP Community Name & Community Number CARSON CITY 320001			B2. County Name CARSON CITY - INDEPENDENT CITY		B3. State Nevada	
B4. Map/Panel Number 3200010092	B5. Suffix G	B6. FIRM Index Date 06-20-2019	B7. FIRM Panel Effective/ Revised Date 12-22-2016	B8. Flood Zone(s) AO	B9. Base Flood Elevation(s) (Zone AO, use Base Flood Depth) 1 FT	
B10. Indicate the source of the Base Flood Elevation (BFE) data or base flood depth entered in Item B9: <input type="checkbox"/> FIS Profile <input checked="" type="checkbox"/> FIRM <input type="checkbox"/> Community Determined <input type="checkbox"/> Other/Source:						
B11. Indicate elevation datum used for BFE in Item B9: <input type="checkbox"/> NGVD 1929 <input checked="" type="checkbox"/> NAVD 1988 <input type="checkbox"/> Other/Source:						
B12. Is the building located in a Coastal Barrier Resources System (CBRS) area or Otherwise Protected Area (OPA)? <input type="checkbox"/> Yes <input checked="" type="checkbox"/> No Designation Date: <input type="checkbox"/> CBRS <input type="checkbox"/> OPA						

# ELEVATION CERTIFICATE

OMB No. 1660-0008  
Expiration Date: November 30, 2022

**IMPORTANT: In these spaces, copy the corresponding information from Section A.**

Building Street Address (including Apt., Unit, Suite, and/or Bldg. No.) or P.O. Route and Box No.  
1357 GROVE ST

FOR INSURANCE COMPANY USE

Policy Number:

City  
CARSON CITY

State  
Nevada

ZIP Code  
89701

Company NAIC Number

## SECTION C – BUILDING ELEVATION INFORMATION (SURVEY REQUIRED)

C1. Building elevations are based on: ☐ Construction Drawings\* ☐ Building Under Construction\* ☒ Finished Construction  
\*A new Elevation Certificate will be required when construction of the building is complete.

C2. Elevations – Zones A1–A30, AE, AH, A (with BFE), VE, V1–V30, V (with BFE), AR, AR/A, AR/AE, AR/A1–A30, AR/AH, AR/AO.  
Complete Items C2.a–h below according to the building diagram specified in Item A7. In Puerto Rico only, enter meters.

Benchmark Utilized: \_\_\_\_\_ Vertical Datum: \_\_\_\_\_

Indicate elevation datum used for the elevations in items a) through h) below.

☐ NGVD 1929 ☐ NAVD 1988 ☐ Other/Source: \_\_\_\_\_

Datum used for building elevations must be the same as that used for the BFE.

Check the measurement used.

- a) Top of bottom floor (including basement, crawlspace, or enclosure floor) \_\_\_\_\_ ☐ feet ☐ meters
- b) Top of the next higher floor \_\_\_\_\_ ☐ feet ☐ meters
- c) Bottom of the lowest horizontal structural member (V Zones only) \_\_\_\_\_ ☐ feet ☐ meters
- d) Attached garage (top of slab) \_\_\_\_\_ ☐ feet ☐ meters
- e) Lowest elevation of machinery or equipment servicing the building  
(Describe type of equipment and location in Comments) \_\_\_\_\_ ☐ feet ☐ meters
- f) Lowest adjacent (finished) grade next to building (LAG) \_\_\_\_\_ ☐ feet ☐ meters
- g) Highest adjacent (finished) grade next to building (HAG) \_\_\_\_\_ ☐ feet ☐ meters
- h) Lowest adjacent grade at lowest elevation of deck or stairs, including  
structural support \_\_\_\_\_ ☐ feet ☐ meters

## SECTION D – SURVEYOR, ENGINEER, OR ARCHITECT CERTIFICATION

This certification is to be signed and sealed by a land surveyor, engineer, or architect authorized by law to certify elevation information. I certify that the information on this Certificate represents my best efforts to interpret the data available. I understand that any false statement may be punishable by fine or imprisonment under 18 U.S. Code, Section 1001.

Were latitude and longitude in Section A provided by a licensed land surveyor? ☒ Yes ☐ No ☐ Check here if attachments.

Certifier's Name  
LEE H. SMITHSON

License Number  
PLS5097

Title  
SURVEY MANAGER

Company Name  
MANHARD CONSULTING LTD

Address  
241 RIDGE ST, SUITE 400

City  
RENO

State  
Nevada

ZIP Code  
89501

Signature

Date  
1.27.2022

Telephone  
775-887-5222

Ext.  
N/A

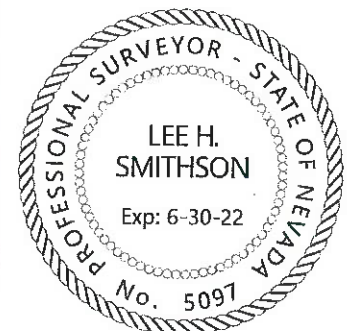

Copy all pages of this Elevation Certificate and all attachments for (1) community official, (2) insurance agent/company, and (3) building owner.

Comments (including type of equipment and location, per C2(e), if applicable)

# ELEVATION CERTIFICATE

OMB No. 1660-0008

Expiration Date: November 30, 2022

**IMPORTANT: In these spaces, copy the corresponding information from Section A.**Building Street Address (including Apt., Unit, Suite, and/or Bldg. No.) or P.O. Route and Box No.  
1357 GROVE ST

FOR INSURANCE COMPANY USE

Policy Number:

City  
CARSON CITYState  
NevadaZIP Code  
89701

Company NAIC Number

## SECTION E – BUILDING ELEVATION INFORMATION (SURVEY NOT REQUIRED) FOR ZONE AO AND ZONE A (WITHOUT BFE)

For Zones AO and A (without BFE), complete Items E1–E5. If the Certificate is intended to support a LOMA or LOMR-F request, complete Sections A, B, and C. For Items E1–E4, use natural grade, if available. Check the measurement used. In Puerto Rico only, enter meters.

E1. Provide elevation information for the following and check the appropriate boxes to show whether the elevation is above or below the highest adjacent grade (HAG) and the lowest adjacent grade (LAG).

a) Top of bottom floor (including basement, crawlspace, or enclosure) is

3.0☒ feet ☐ meters☒ above or ☐ below the HAG.

b) Top of bottom floor (including basement, crawlspace, or enclosure) is

3.1☒ feet ☐ meters☒ above or ☐ below the LAG.

E2. For Building Diagrams 6–9 with permanent flood openings provided in Section A Items 8 and/or 9 (see pages 1–2 of Instructions), the next higher floor (elevation C2.b in the diagrams) of the building is

N/A☐ feet ☐ meters☐ above or ☐ below the HAG.

E3. Attached garage (top of slab) is

2.1☒ feet ☐ meters☒ above or ☐ below the HAG.

E4. Top of platform of machinery and/or equipment servicing the building is

2.4☒ feet ☐ meters☒ above or ☐ below the HAG.

E5. Zone AO only: If no flood depth number is available, is the top of the bottom floor elevated in accordance with the community's floodplain management ordinance? ☐ Yes ☐ No ☐ Unknown. The local official must certify this information in Section G.

## SECTION F – PROPERTY OWNER (OR OWNER'S REPRESENTATIVE) CERTIFICATION

The property owner or owner's authorized representative who completes Sections A, B, and E for Zone A (without a FEMA-issued or community-issued BFE) or Zone AO must sign here. The statements in Sections A, B, and E are correct to the best of my knowledge.

Property Owner or Owner's Authorized Representative's Name  
MANHARD CONSULTING LTDAddress  
241 RIDGE ST, SUITE 400City  
RENOState  
NevadaZIP Code  
89501

Signature

Date  
1.27.2022Telephone  
775-887-5222

Comments

E4 Air conditioning unit

☐ Check here if attachments.

# ELEVATION CERTIFICATE

OMB No. 1660-0008  
Expiration Date: November 30, 2022

<b>IMPORTANT: In these spaces, copy the corresponding information from Section A.</b>			<b>FOR INSURANCE COMPANY USE</b>
Building Street Address (including Apt., Unit, Suite, and/or Bldg. No.) or P.O. Route and Box No. 1357 GROVE ST			Policy Number:
City CARSON CITY	State Nevada	ZIP Code 89701	Company NAIC Number

## SECTION G – COMMUNITY INFORMATION (OPTIONAL)

The local official who is authorized by law or ordinance to administer the community's floodplain management ordinance can complete Sections A, B, C (or E), and G of this Elevation Certificate. Complete the applicable item(s) and sign below. Check the measurement used in Items G8–G10. In Puerto Rico only, enter meters.

- G1. ☐ The information in Section C was taken from other documentation that has been signed and sealed by a licensed surveyor, engineer, or architect who is authorized by law to certify elevation information. (Indicate the source and date of the elevation data in the Comments area below.)
- G2. ☐ A community official completed Section E for a building located in Zone A (without a FEMA-issued or community-issued BFE) or Zone AO.
- G3. ☐ The following information (Items G4–G10) is provided for community floodplain management purposes.

G4. Permit Number	G5. Date Permit Issued	G6. Date Certificate of Compliance/Occupancy Issued
-------------------	------------------------	---

G7. This permit has been issued for: ☐ New Construction ☐ Substantial Improvement

G8. Elevation of as-built lowest floor (including basement) of the building: \_\_\_\_\_ ☐ feet ☐ meters Datum \_\_\_\_\_

G9. BFE or (in Zone AO) depth of flooding at the building site: \_\_\_\_\_ ☐ feet ☐ meters Datum \_\_\_\_\_

G10. Community's design flood elevation: \_\_\_\_\_ ☐ feet ☐ meters Datum \_\_\_\_\_

Local Official's Name	Title
Community Name	Telephone
Signature	Date

Comments (including type of equipment and location, per C2(e), if applicable)

☐ Check here if attachments.



## BUILDING PHOTOGRAPHS

See Instructions for Item A6.

OMB No. 1660-0008

Expiration Date: November 30, 2022

### ELEVATION CERTIFICATE

**IMPORTANT: In these spaces, copy the corresponding information from Section A.**

Building Street Address (including Apt., Unit, Suite, and/or Bldg. No.) or P.O. Route and Box No.  
1357 GROVE ST

City  
CARSON CITY

State  
Nevada

ZIP Code  
89701

**FOR INSURANCE COMPANY USE**

Policy Number:

Company NAIC Number

If using the Elevation Certificate to obtain NFIP flood insurance, affix at least 2 building photographs below according to the instructions for Item A6. Identify all photographs with date taken; "Front View" and "Rear View"; and, if required, "Right Side View" and "Left Side View." When applicable, photographs must show the foundation with representative examples of the flood openings or vents, as indicated in Section A8. If submitting more photographs than will fit on this page, use the Continuation Page.



Photo One

Photo One Caption FRONT VIEW

Clear Photo One



Photo Two

Photo Two Caption REAR VIEW

Clear Photo Two



**ELEVATION CERTIFICATE****BUILDING PHOTOGRAPHS**

Continuation Page

OMB No. 1660-0008

Expiration Date: November 30, 2022

**IMPORTANT: In these spaces, copy the corresponding information from Section A.**Building Street Address (including Apt., Unit, Suite, and/or Bldg. No.) or P.O. Route and Box No.  
1357 GROVE STCity  
CARSON CITYState  
NevadaZIP Code  
89701**FOR INSURANCE COMPANY USE**

Policy Number:

Company NAIC Number

If submitting more photographs than will fit on the preceding page, affix the additional photographs below. Identify all photographs with: date taken; "Front View" and "Rear View"; and, if required, "Right Side View" and "Left Side View." When applicable, photographs must show the foundation with representative examples of the flood openings or vents, as indicated in Section A8.



Photo Three

Photo Three Caption SIDE VIEW

Clear Photo Three



Photo Four

Photo Four Caption SIDE VIEW

Clear Photo Four